



COMPLIANT TIMBER JOINERY

NEW ZEALAND LIMITED

4000 Series Sliding Window

Profiles - Single Glazed - Sashes

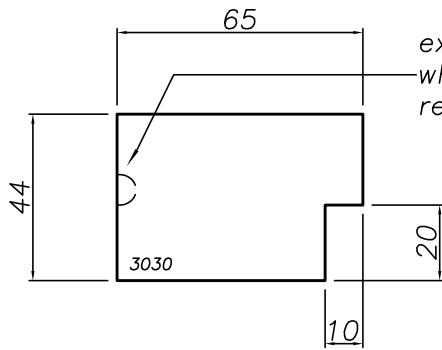

3030 Fixed panel Top rail / Stile SG

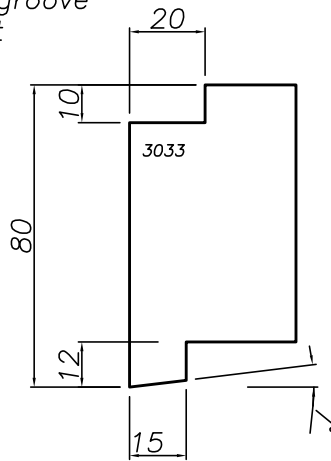

3033 Sliding Panel Bottom Rail SG.

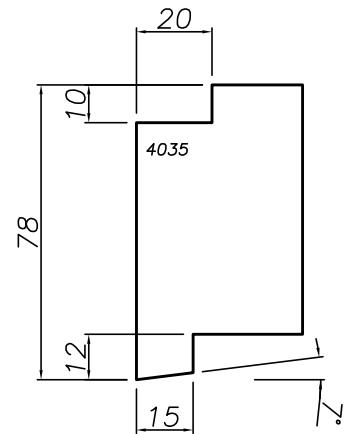

4035 Fixed Bottom Rail SG.

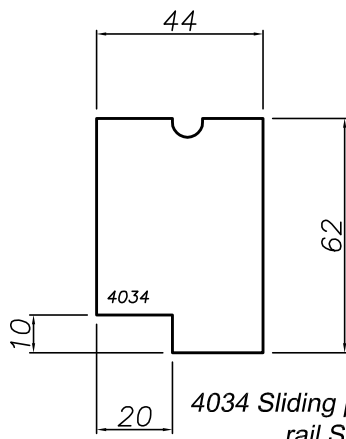

4034 Sliding panel Top rail SG

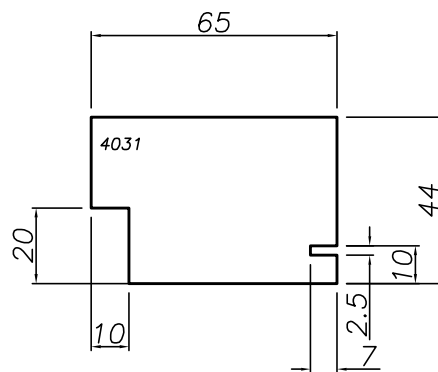

4031 4P Stile Left SG

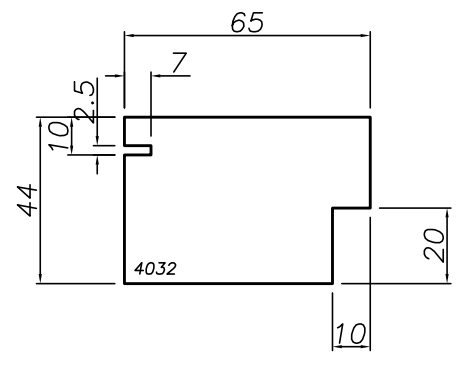

4032 4P Stile Right SG

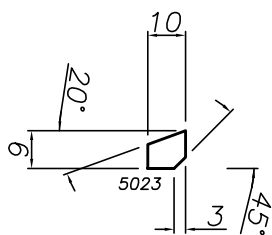

5023 Single Glazing Bead
In sashes only.

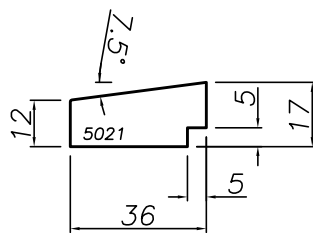

5021 Direct glaze to head / jamb Glazing Bead
For Single and Double Glazing.

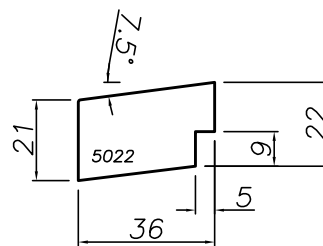

5022 Direct glaze to sill Glazing Bead
For Single and Double Glazing.

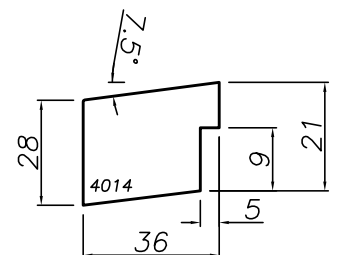

4014 Direct glaze to sill Glazing Bead

For Sliding window sill with 4012 13mm weathering bead on top. For single and Double Glazing

Non critical performance dimensions can vary



No	Revision	Date	Detail No:
			Scale: 1:2 Date: 1/6/2012
			Drawing No: S4-01-01

68

varies

varies

40



10



1



13



JMF
NEW ZEALAND LIMITED

This Drawing is Protected by Copyright © JMF New Zealand Ltd

Profiles - Single Glazed - Frames

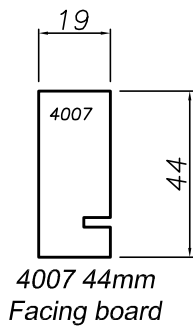
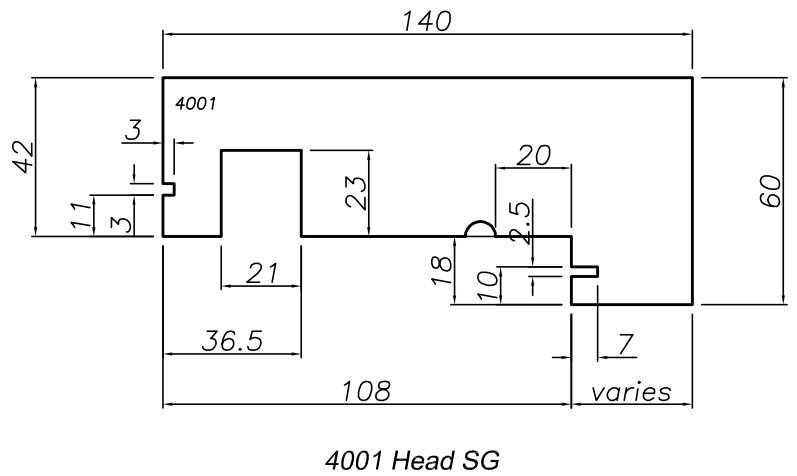
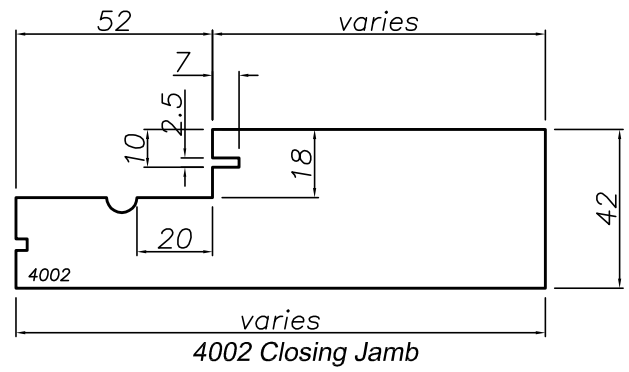
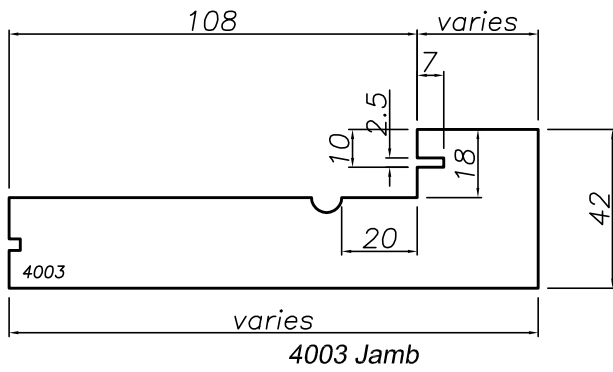

Kerf only needed when facing board forms a sliding panel pocket.

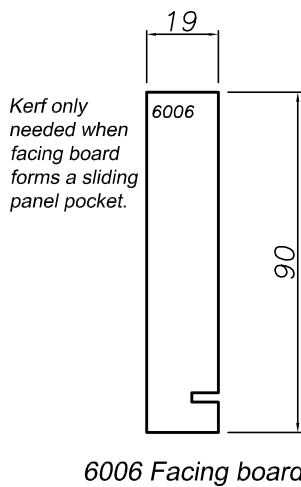

Kerf only needed when facing board forms a sliding panel pocket.

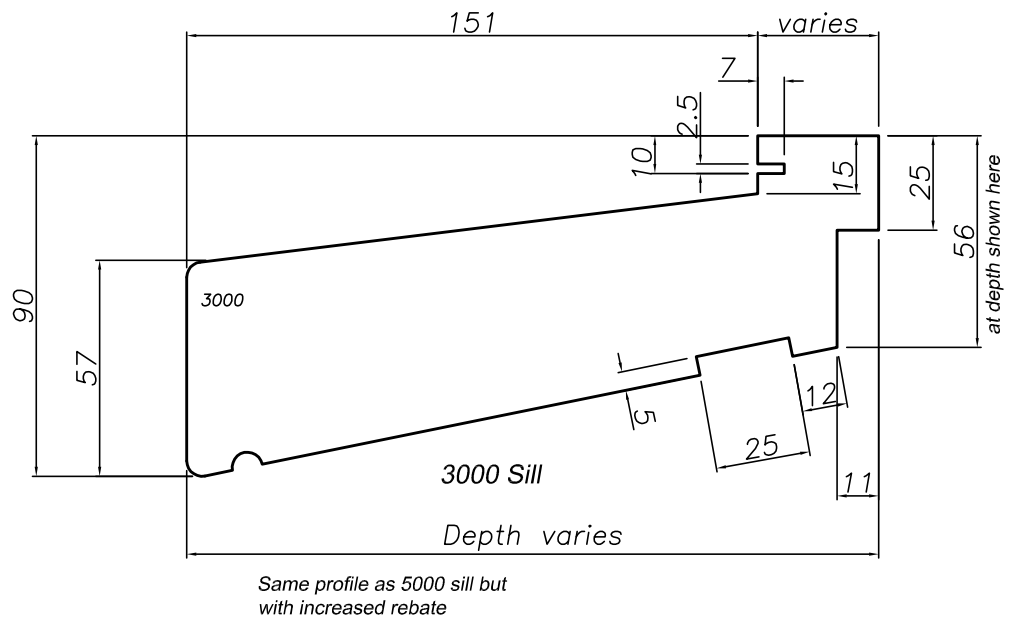

No	Revision	Date	Detail No:
			Scale: 1:2
			Date: 1/6/2012
			Drawing No: S4-01-03

Profiles - Double Glazed - Sashes

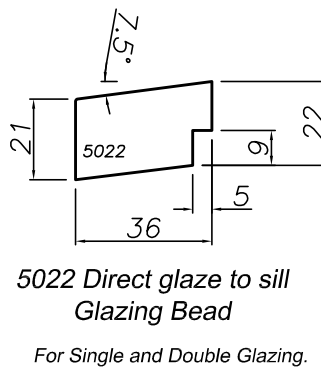
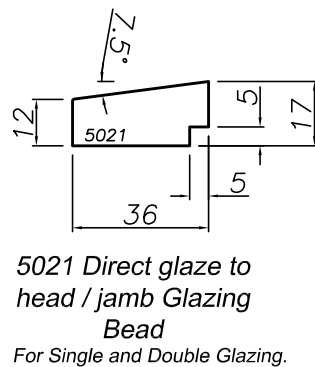
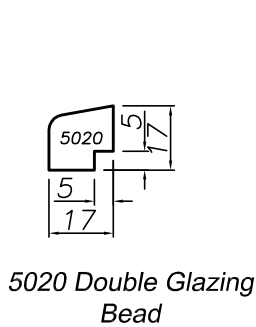
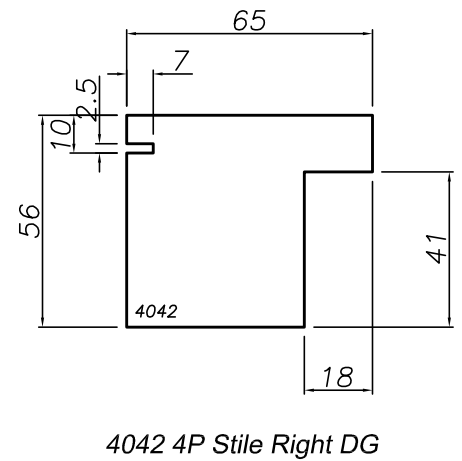
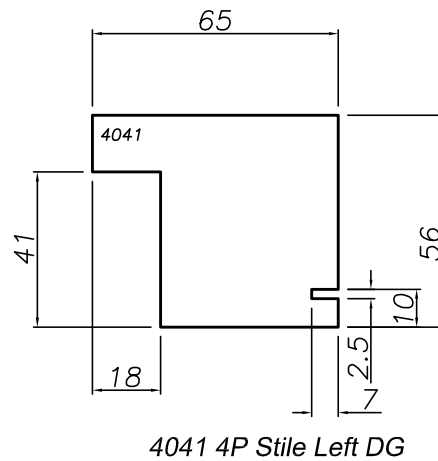
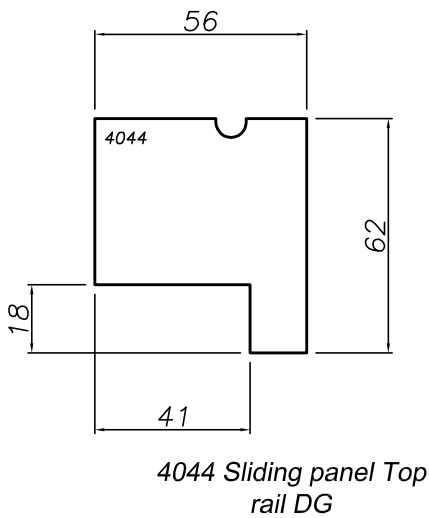
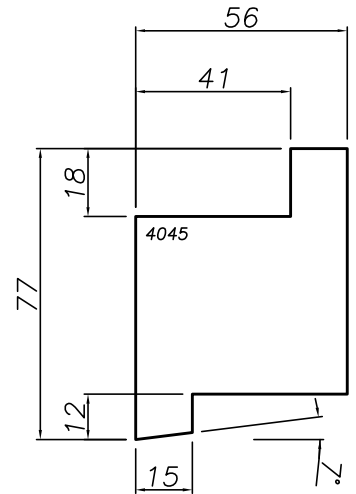
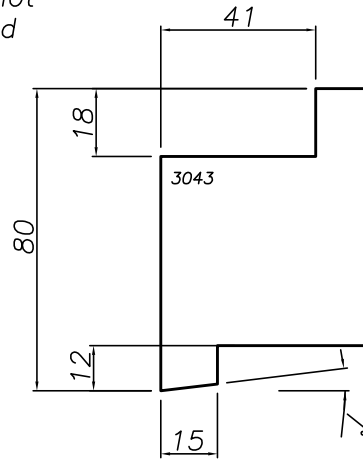
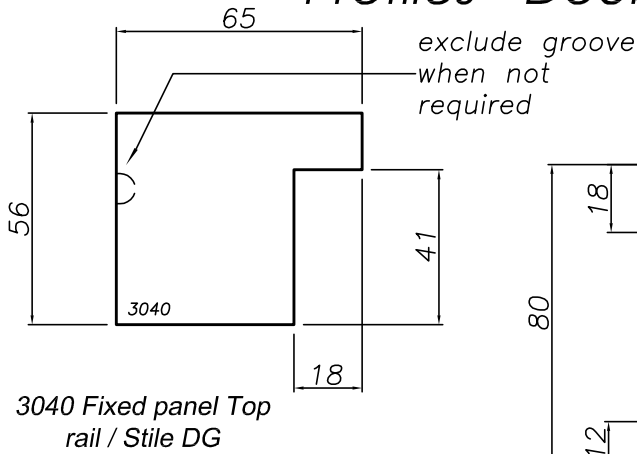

Non critical performance dimensions can vary



No	Revision	Date	Detail No:
			Scale: 1:2 Date: 1/6/2012
			Drawing No: S4-01-04

Profiles - Double Glazed - Frames

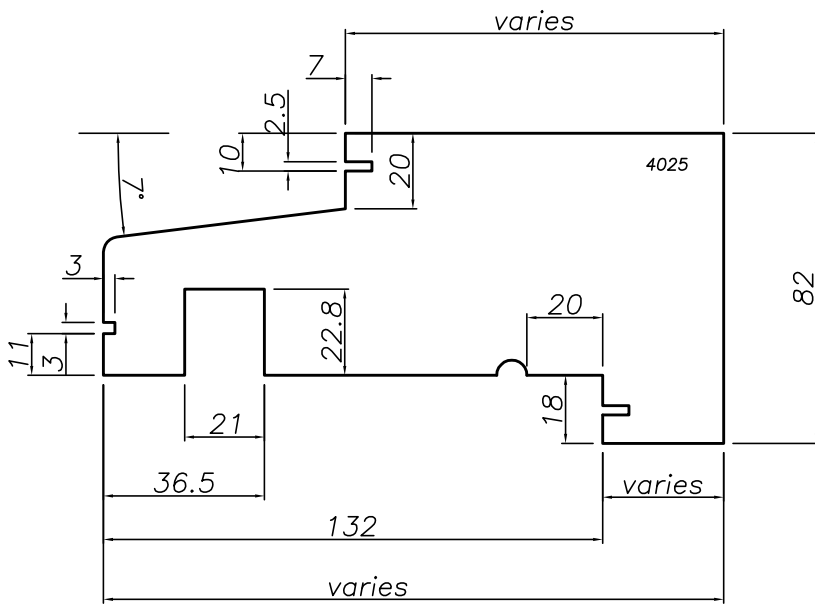

4025 Overlight Transom
DG

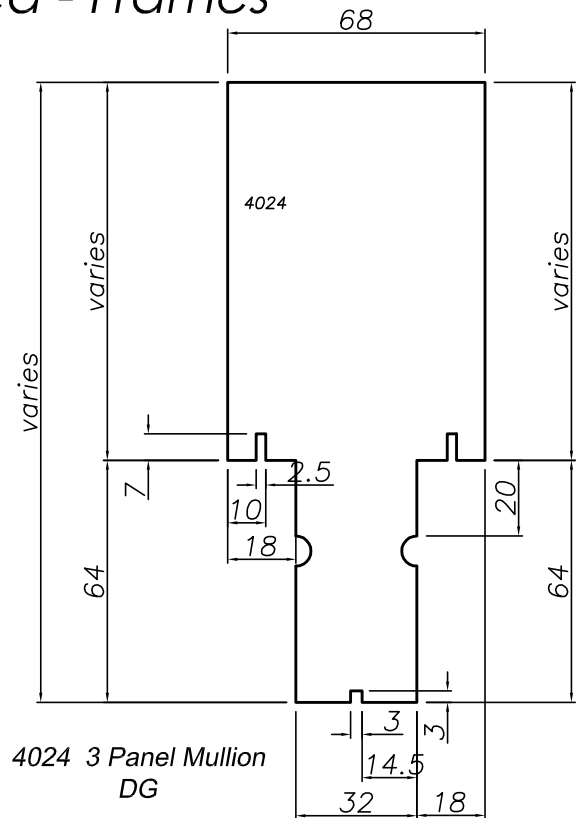

4024 3 Panel Mullion
DG

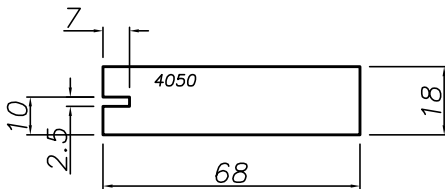

4050 Head Infill DG

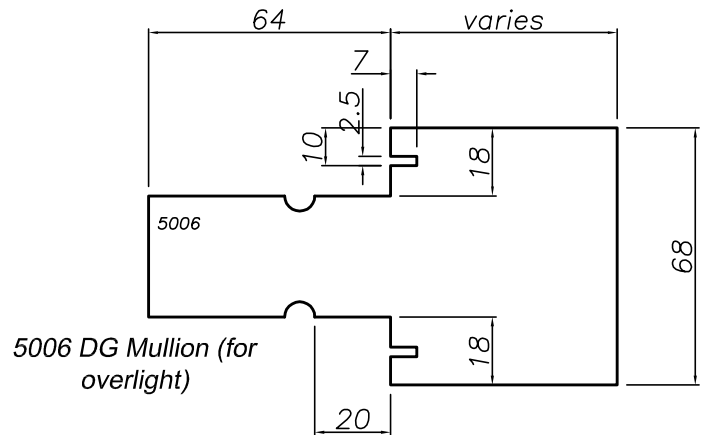

5006 DG Mullion (for
overlight)

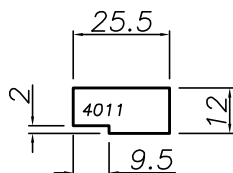

4011 Interlocker trim

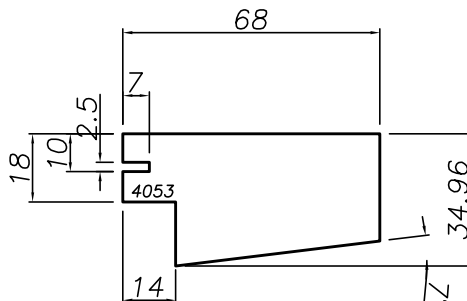

4053 Threshold DG

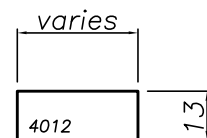

4012 13mm weather
bead (at sill)



No	Revision	Date	Detail No:
			Scale: 1:2 Date: 1/6/2012
			Drawing No: S4-01-05

Profiles - Double Glazed - Frames

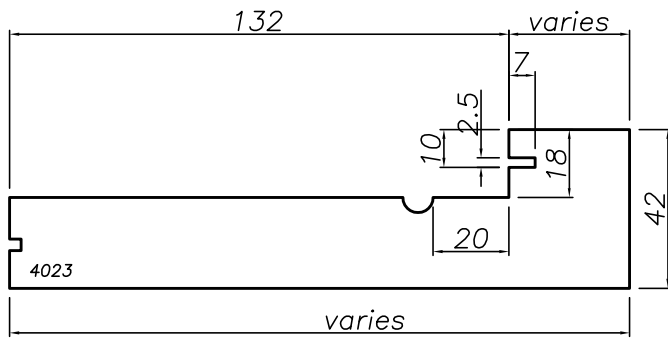

4023 Jamb DG

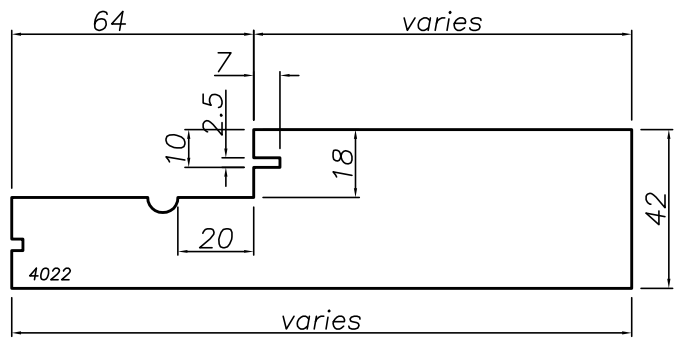

4022 Closing Jamb DG

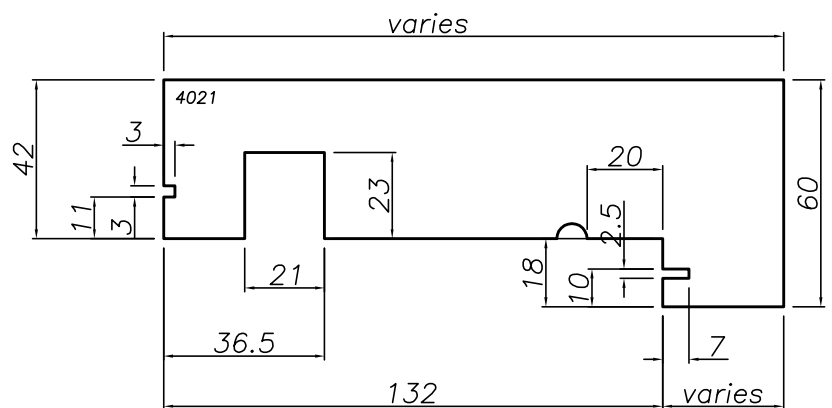

4021 Head DG

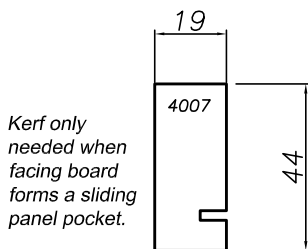

4007 44mm Facing board

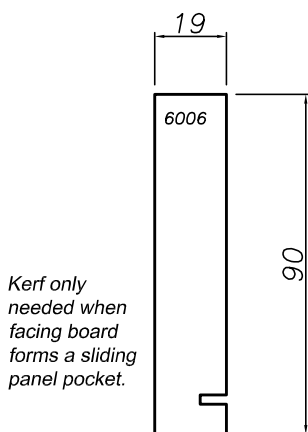

6006 Facing board

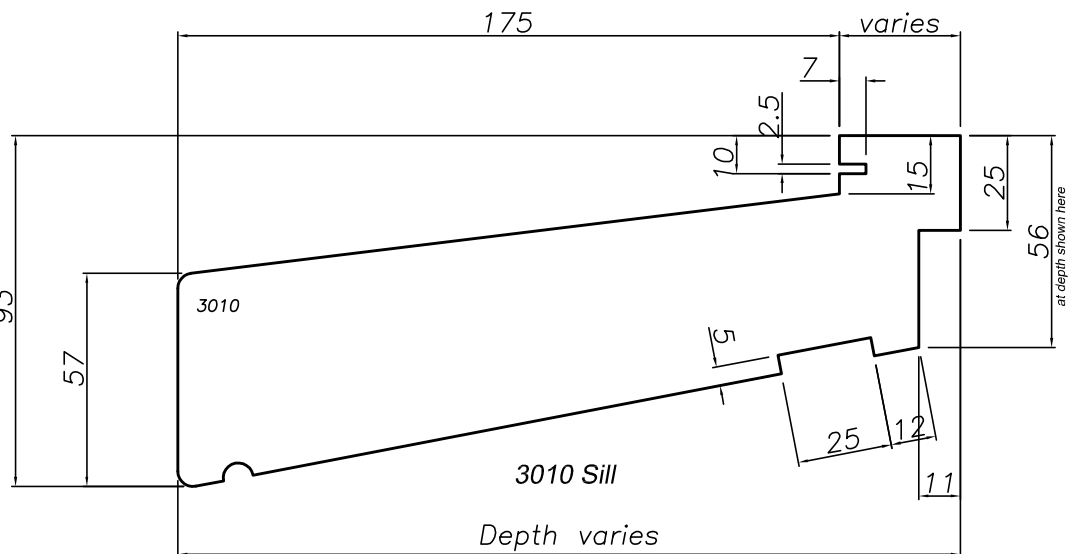

3010 Sill



No	Revision	Date	Detail No:
			Scale: 1:2 Date: 1/6/2012
			Drawing No: S4-01-06

Hardware



<i>Part #</i>	<i>Desc.</i>
16010	4 panel seal



<i>Part #</i>	<i>Desc.</i>
16020	Interlocker buffer



<i>Part #</i>	<i>Desc.</i>
16000	Threshold and frame seal



No	Revision	Date	Detail No:
			Scale: 1:1 Date: 1/6/2012
			Drawing No: S4-02-01

Hardware - Extrusions

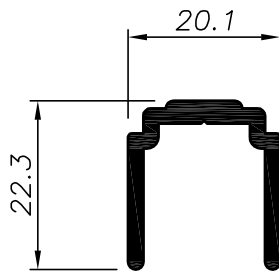

Top Guide track

Part #	Desc.	
11003	Top Guide track	

Pre drilled, anodised finish (specify Satin or Bronze)

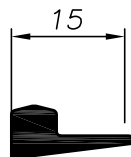

12002
Track

Part #	Desc.	
12002	Track	

Pre drilled @ 300 ctrs, csk for 6g screws. Slotted for drainage @ 600 ctrs

12006
Interlocker set (2 lengths)

Part #	Desc.	
12006	Interlocker set	

Pre drilled, anodised finish (specify Satin or Bronze) complete with mohair seal and rubber buffer.



No	Revision	Date	Detail No:
			Scale: 1:1 Date: 1/6/2012
			Drawing No: S4-02-02

Hardware

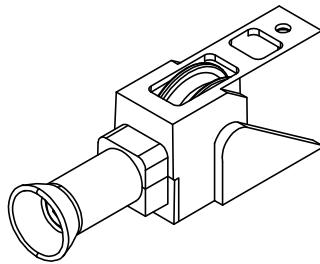

Part #	Desc.	Load rating
12050	Nylon single, nylon tyre	100kg per panel

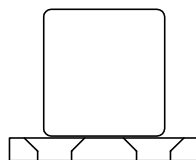

Part #	Desc.	
11052	Top Guide pin	

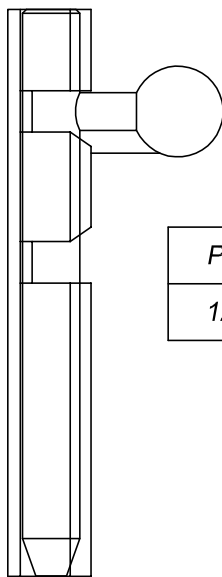

Part #	Desc.	
12050	catch	



No	Revision	Date	Detail No:
			Scale: 1:1 Date: 1/6/2012
			Drawing No: S4-02-03

Cross Sections

3 — See detail on relevant page

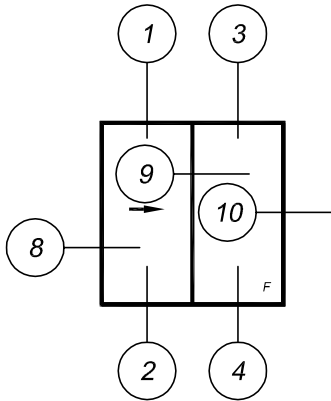

2 Panel

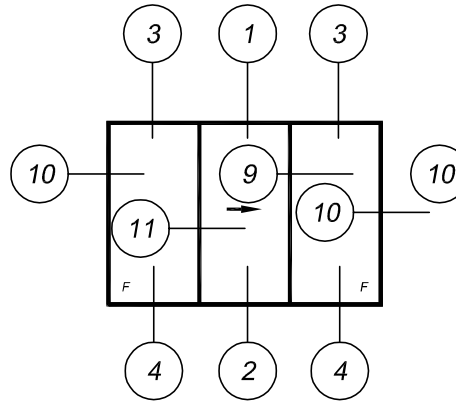

3 Panel

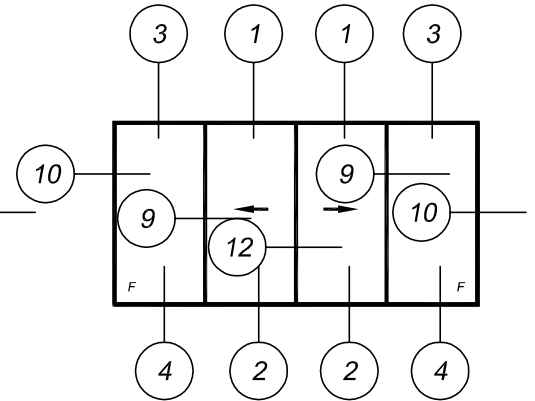

4 Panel

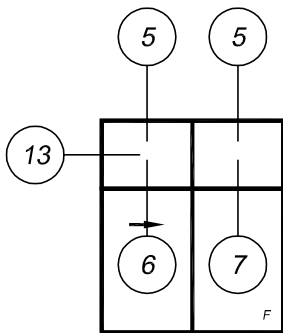

2 Panel

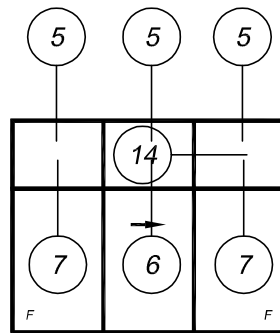

3 Panel

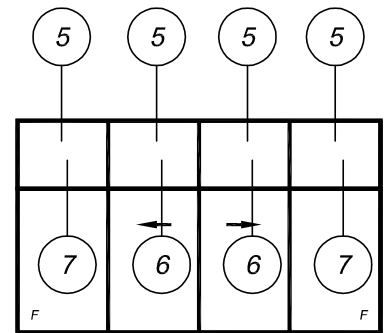

4 Panel



No	Revision	Date

Detail No:

Scale: 1:1

Date: 1/6/2012

Drawing No:

S4-03-01

Cross Section Details

6006 facing board at head

11003 guide channel, fixed to head @ 400mm ctrs

11052 top guide let into top of panel. Locate 100mm from each end of panel

4044 sash top rail DG

6006 facing board at jambs beyond

4021 DG head

4050 at head behind sliding panel, wet seal to head.

4022 at closing jamb

16000 seal at closing jamb, stop just beyond sill seal.

See glazing section for specific glazing details

30 x 12g SS nails @ 200 ctrs

12050 let into bottom rail and fixed with 1 8g SS screw

Fix 12002 track @ 300mm ctrs with 6g screws.

butyl tape 4 sides behind glazing and at sill only outside

16000 seal extended to meet jamb seal

4012 weather bead at sill

4053 Threshold, wet seal to sill

OUTSIDE

INSIDE

1

 Head at panel (DG)

2

 Sill at panel (DG)

No	Revision	Date	Detail No:
			1 & 2
			Scale: 1:2 Date: 1/6/2012
			Drawing No: S4-03-02

This Drawing is Protected by Copyright © JMF New Zealand Ltd

Copyright, ALU 41 Ltd

No	Revision	Date	Detail No:	1 & 2
			Scale: 1:2	Date: 1/6/2012
			Drawing No:	S4-03-02

Copyright © JMF New Zealand Ltd

Cross Section Details

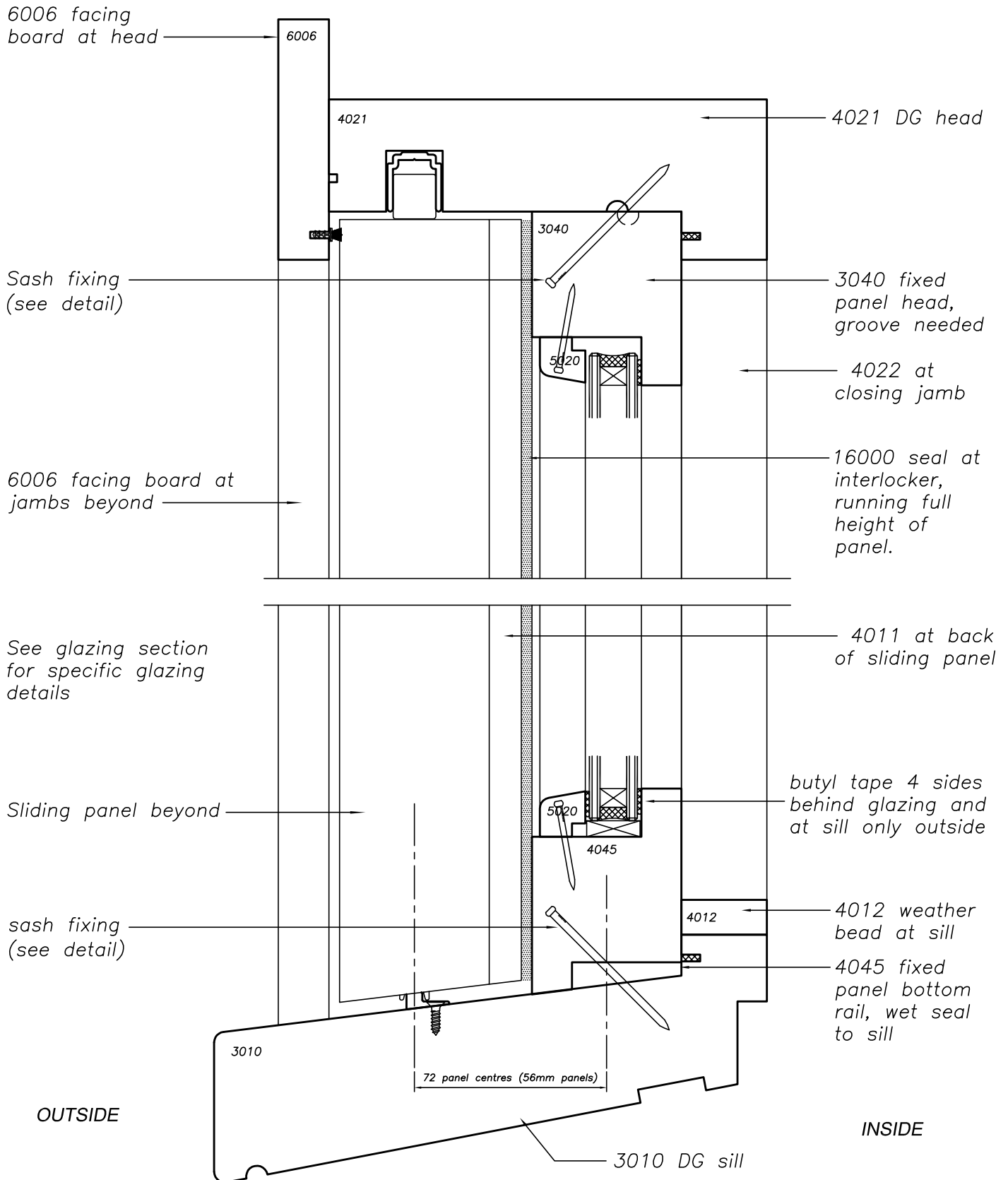

3 Head at fixed panel (DG)

4 Sill at fixed panel (DG)

Copyright, ALU 41 Ltd



No	Revision	Date	Detail No:
			3 & 4
			Scale: 1:2 Date: 1/6/2012
			Drawing No: S4-03-03

This Drawing is Protected by Copyright © JMF New Zealand Ltd

Cross Section Details

6006 facing board at head

5021 direct glaze glazing bead (head and jambs)

4022

4022 as head

4022 at overlight jamb

30 x 12g SS nails @ 200 ctrs

5022 direct glaze glazing bead (sill only)

butyl tape 4 sides

support IGU evenly on profiled setting blocks

4007 facing board (42mm), Chamfer 15 deg. in this situation.

4025 DG transom

4050 at head behind sliding panel, wet seal to head.

4044 sash top rail DG

4022 at closing jamb

6006 facing board at jambs beyond

16000 seal at closing jamb.

INSIDE

OUTSIDE

5 Head at overlight (DG)

6 Overlight transom, fixed over sliding (DG)

Copyright, ALU 41 Ltd



No	Revision	Date

Detail No:	5 & 6
Scale: 1:2	Date: 1/6/2012
Drawing No:	S4-03-04

This Drawing is Protected by Copyright © JMF New Zealand Ltd

Cross Section Details

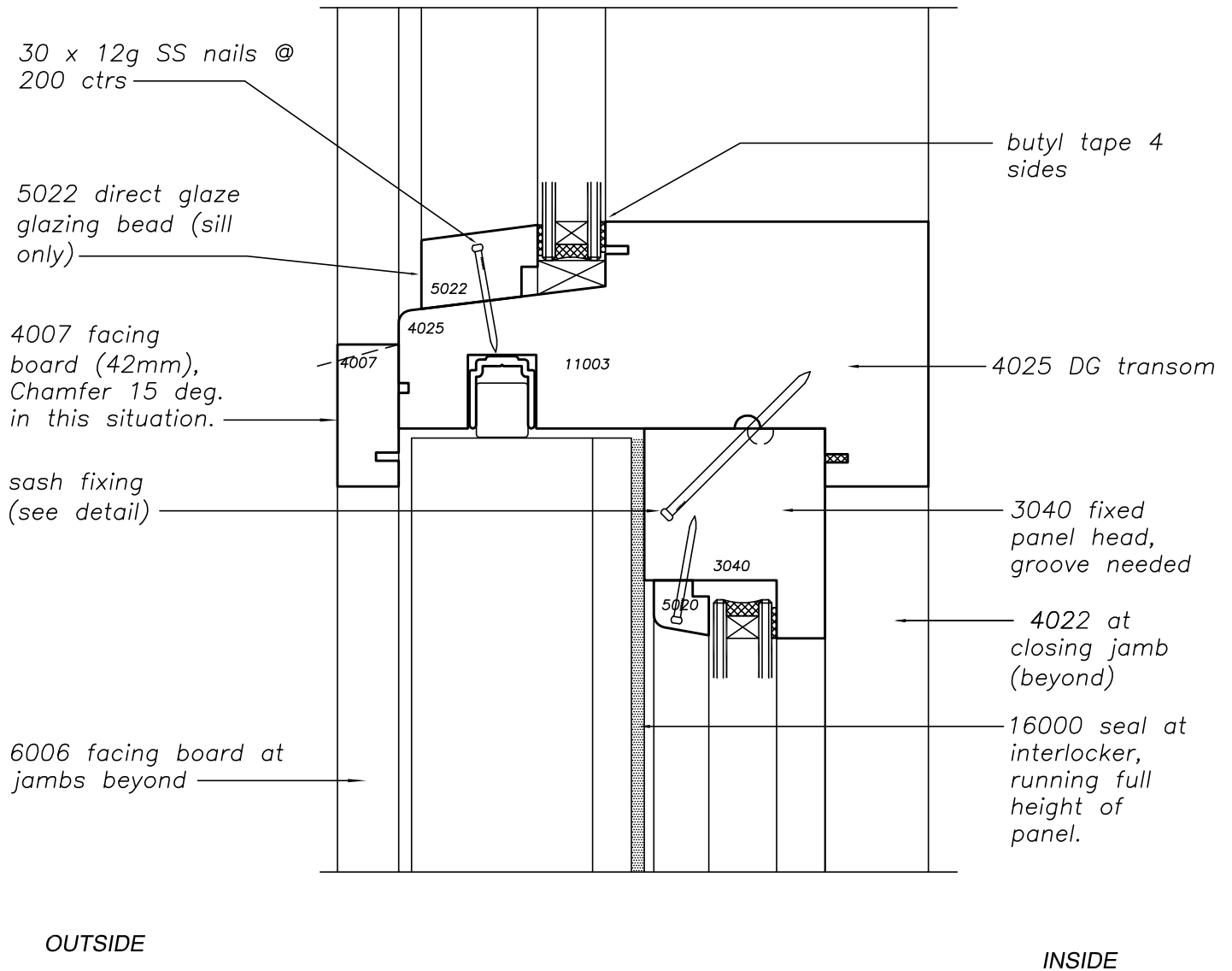

7 Overlight transom, fixed over fixed (DG)

Copyright ALU 41 Ltd



No	Revision	Date	Detail No:
			7
			Scale: 1:2 Date: 1/6/2012
			Drawing No: S4-03-05

This Drawing is Protected by Copyright © JMF New Zealand Ltd

Cross Section Details

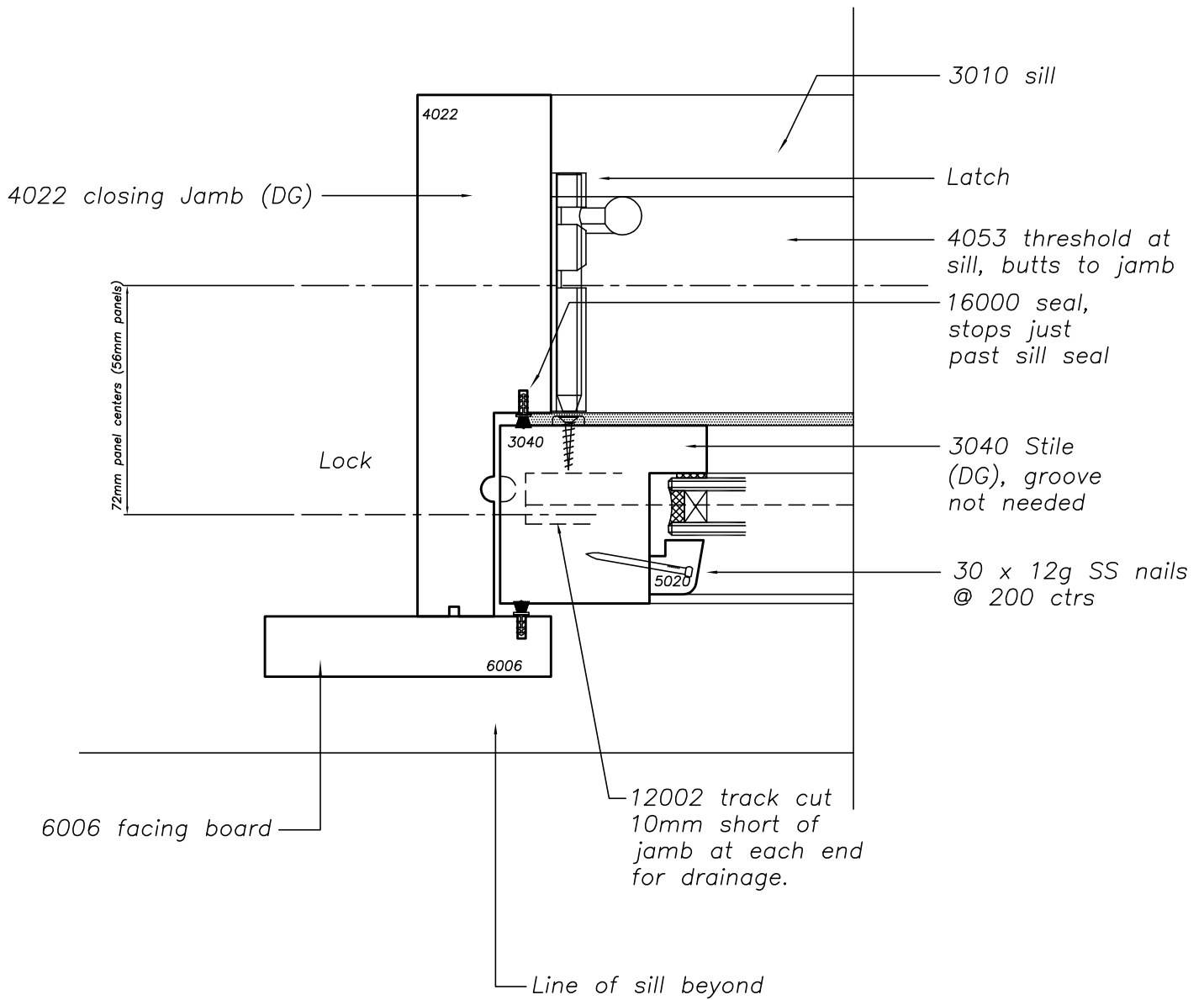

8 Jamb at sliding panel



No	Revision	Date	Detail No:
			8
			Scale: 1:2 Date: 1/6/2012
			Drawing No: S4-03-06

Cross Section Details

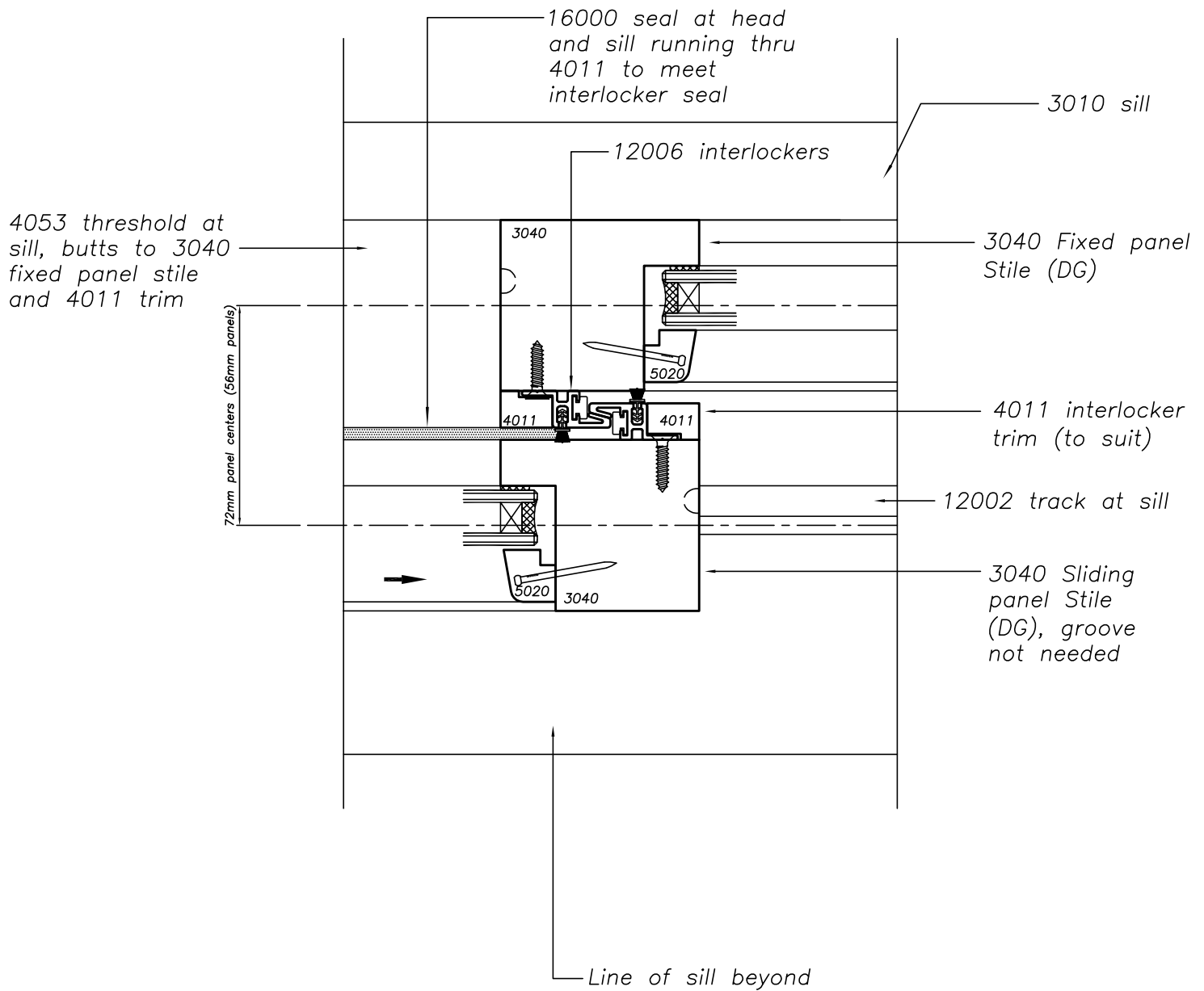

9 Interlockers



No	Revision	Date	Detail No:	9
			Scale: 1:2	Date: 1/6/2012
			Drawing No:	S4-03-07

Cross Section Details

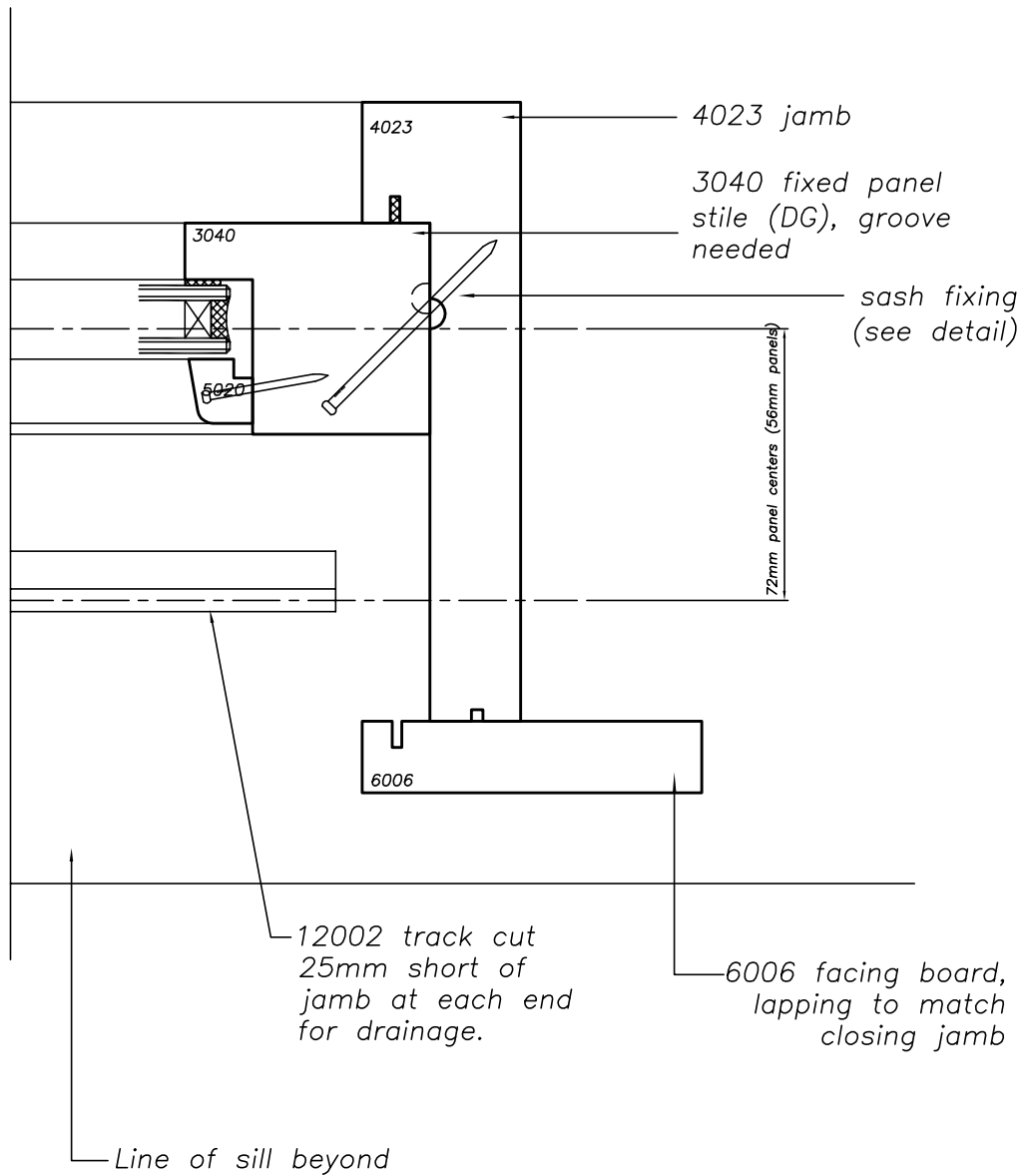

10 Jamb at fixed panel



No	Revision	Date	Detail No:
			10
			Scale: 1:2 Date: 1/6/2012
			Drawing No: S4-03-08

Cross Section Details

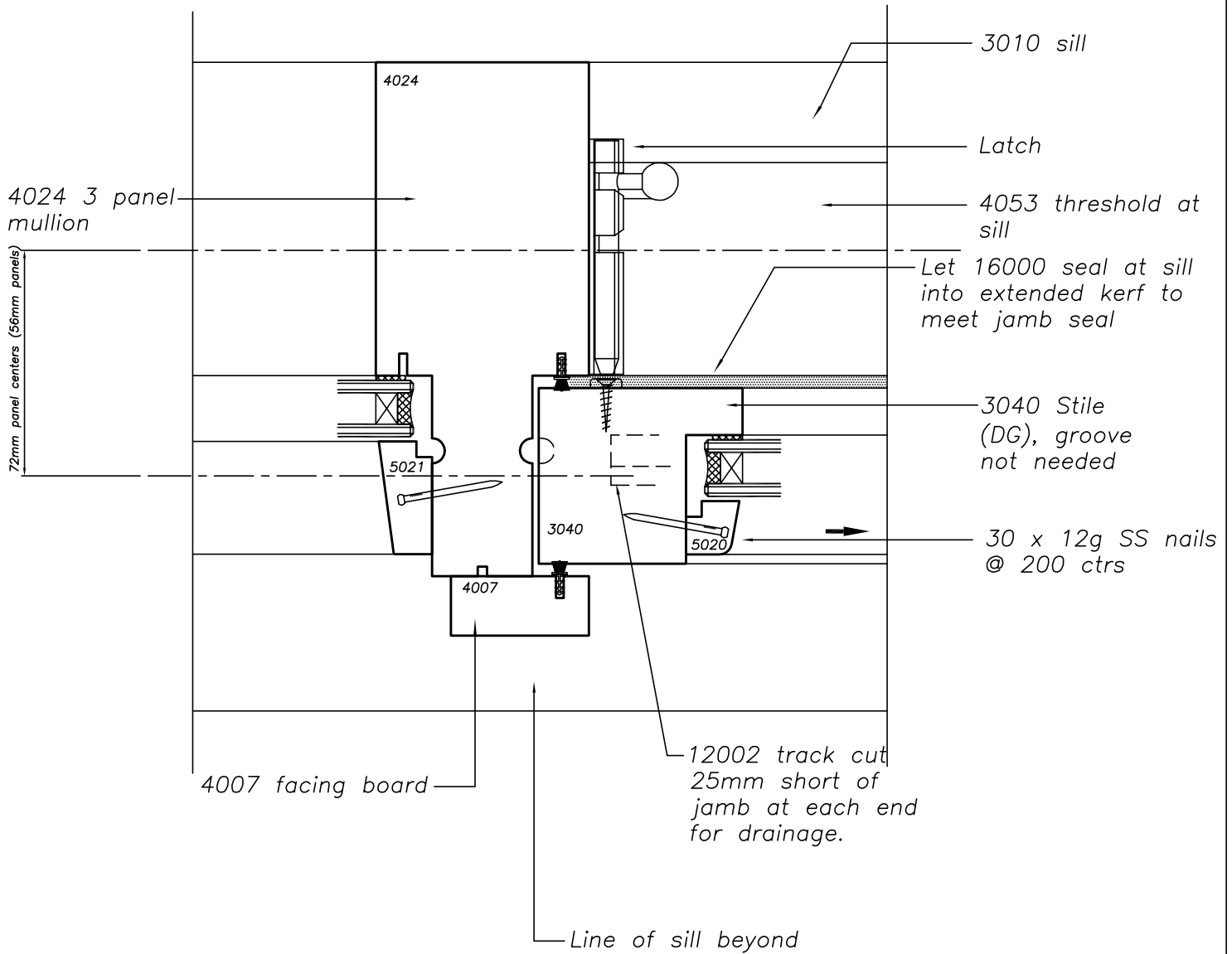

11 3 Panel mullion



No	Revision	Date	Detail No:
			11
			Scale: 1:2 Date: 1/6/2012
			Drawing No: S4-03-09

Cross Section Details

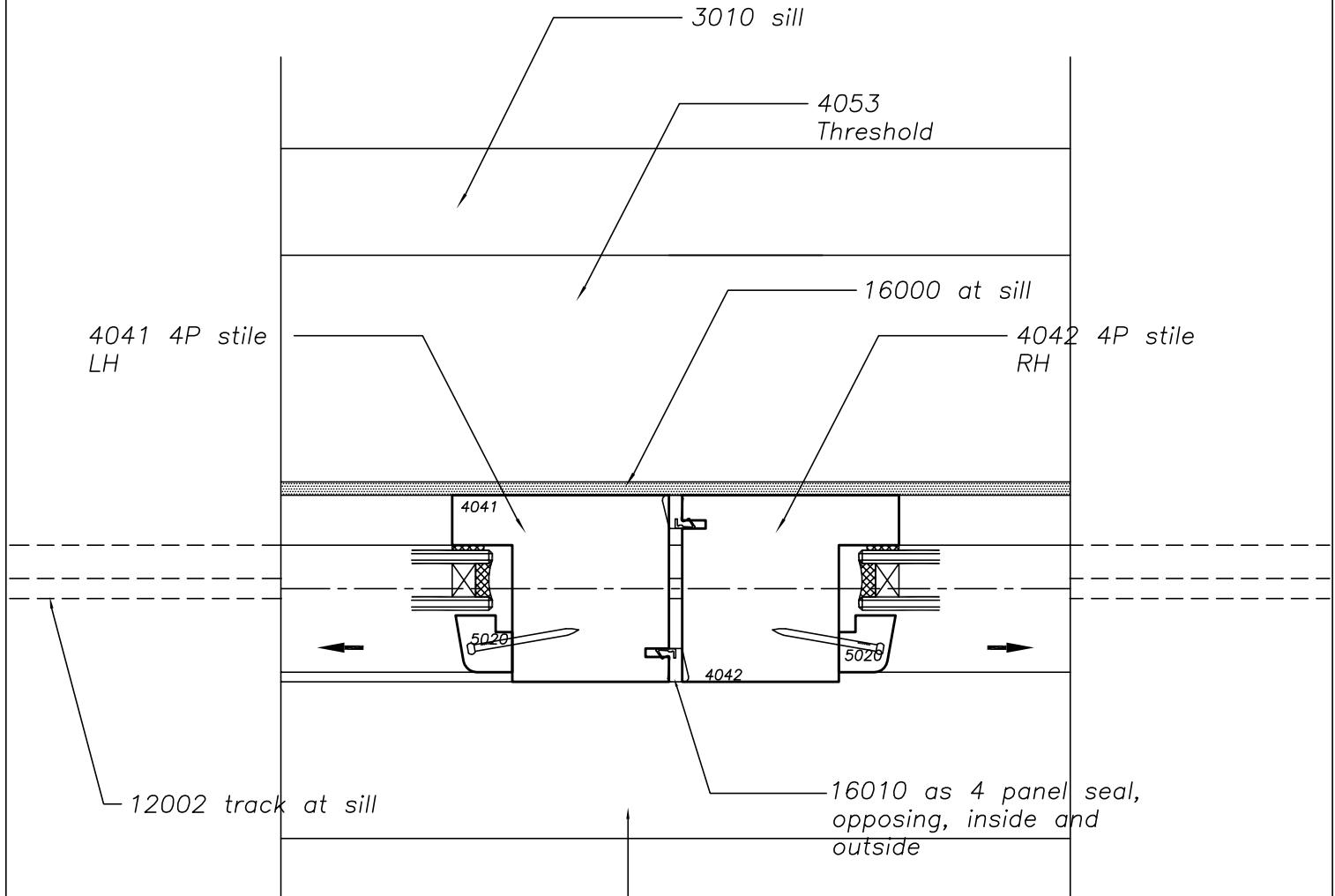

Note;

A 4 panel sliding window (2 sliding panels butt) must have 12060 negative load hooks and 12000 alloy threshold tread present to resist negative loads (not detailed here) – See sliding door section of technical manual for details.

Latches not shown

(12) 4 Panel closer



No	Revision	Date	Detail No:
			12
			Scale: 1:2 Date: 1/6/2012
			Drawing No: S4-03-10

Cross Section Details

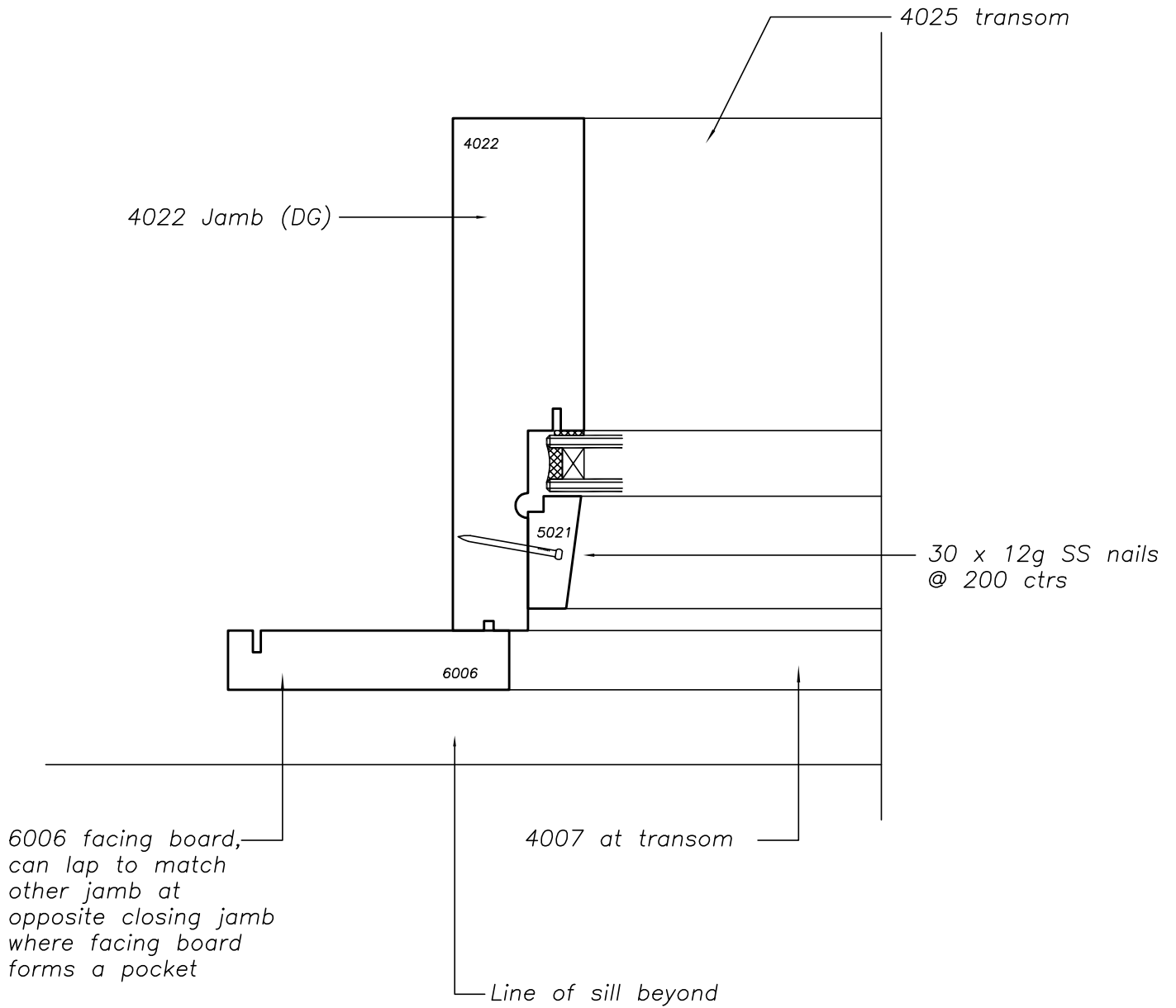

13 Jamb at overlight



No	Revision	Date	Detail No:
			13
			Scale: 1:2 Date: 1/6/2012
			Drawing No: S4-03-11

Cross Section Details

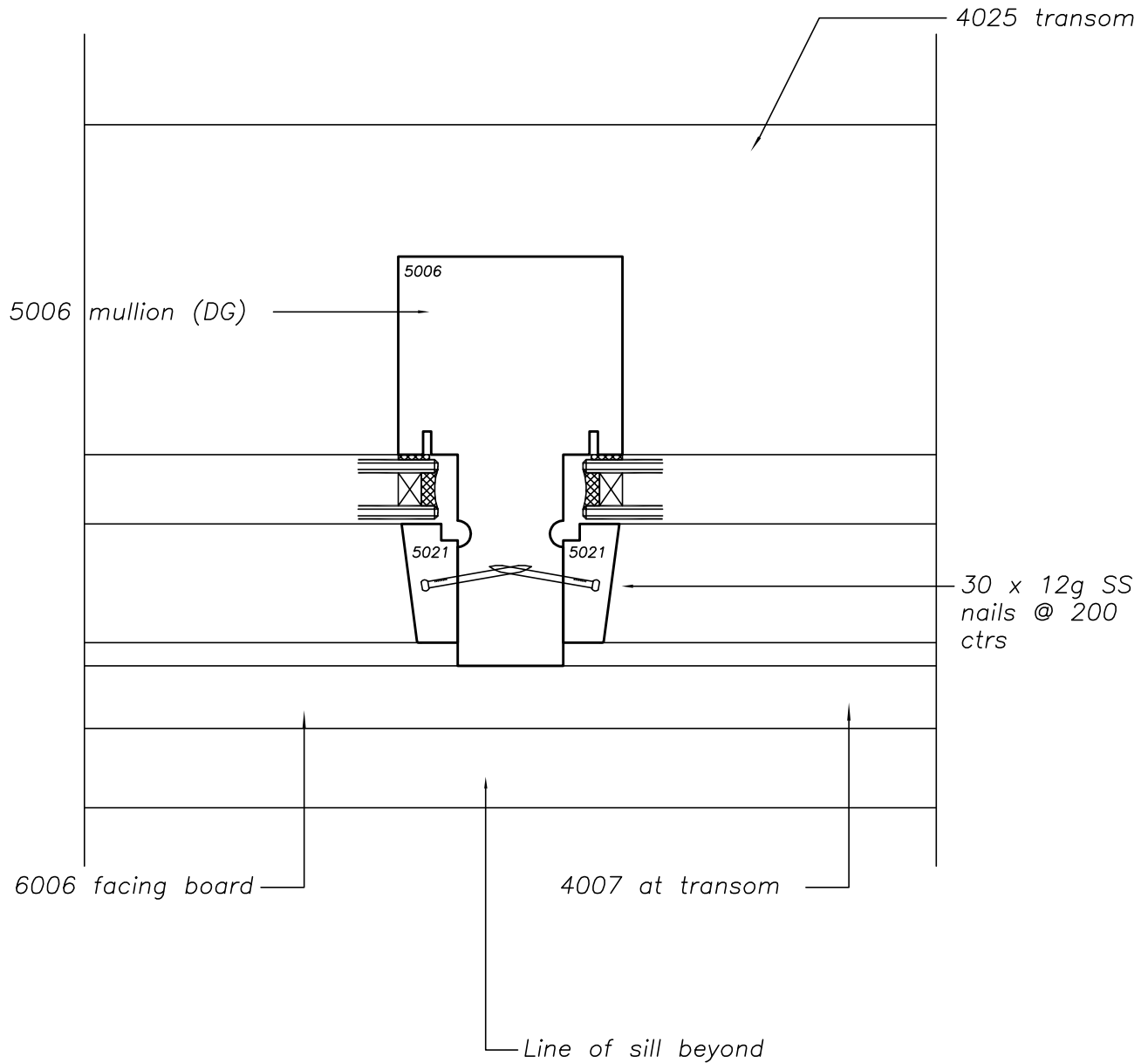

14 Mullion at overlight



No	Revision	Date	Detail No:
			14
			Scale: 1:2 Date: 1/6/2012
			Drawing No: S4-03-12

Deductions & Clearances

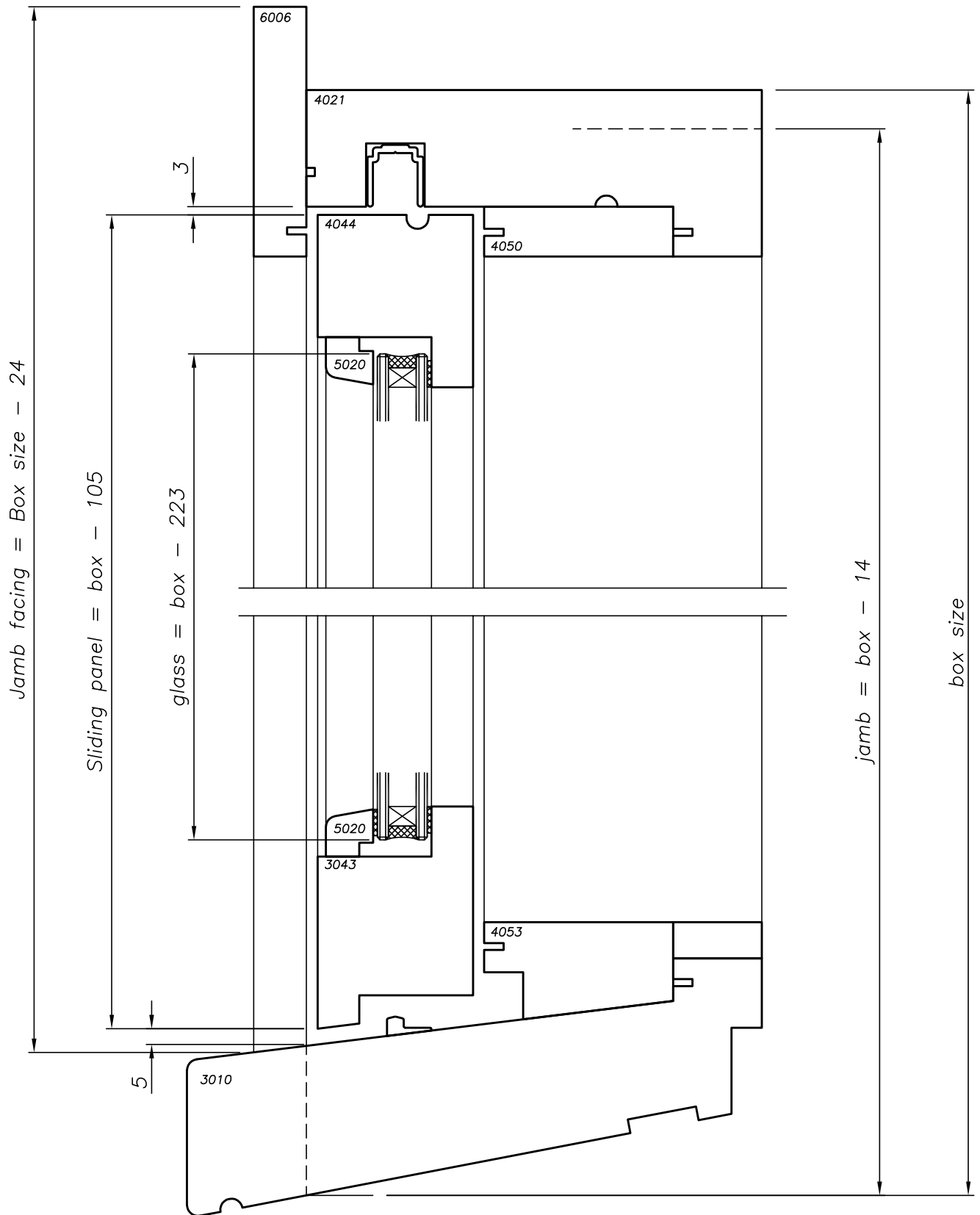

OUTSIDE

Vertical Section - Sliding panel DG

INSIDE



No	Revision	Date	Detail No:
			Scale: 1:2 Date: 1/6/2012
			Drawing No: S4-04-01

Deductions & Clearances

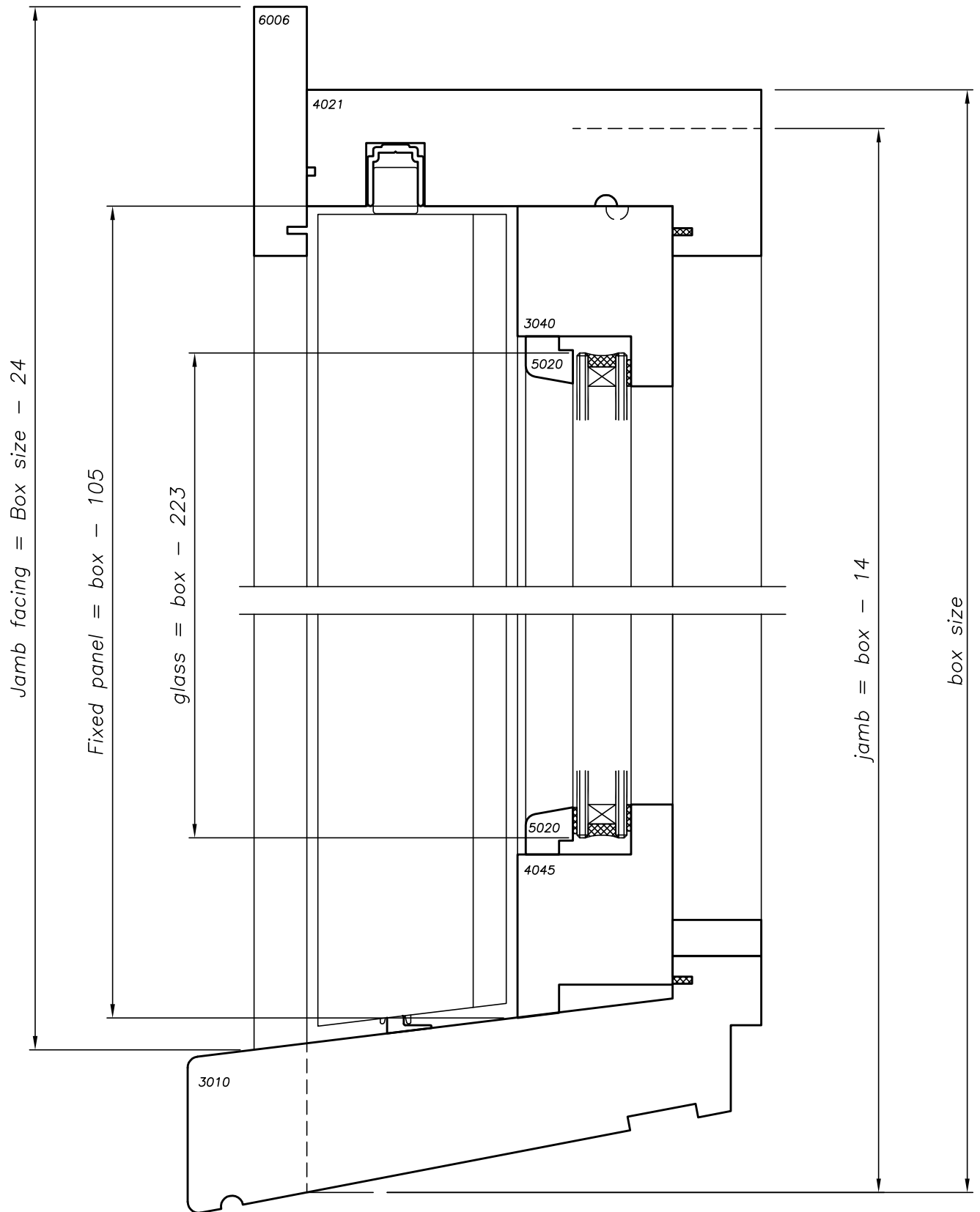

OUTSIDE

Vertical Section - Fixed panel DG

INSIDE



No	Revision	Date	Detail No:
			Scale: 1:2 Date: 1/6/2012
			Drawing No: S4-04-02

Deductions & Clearances

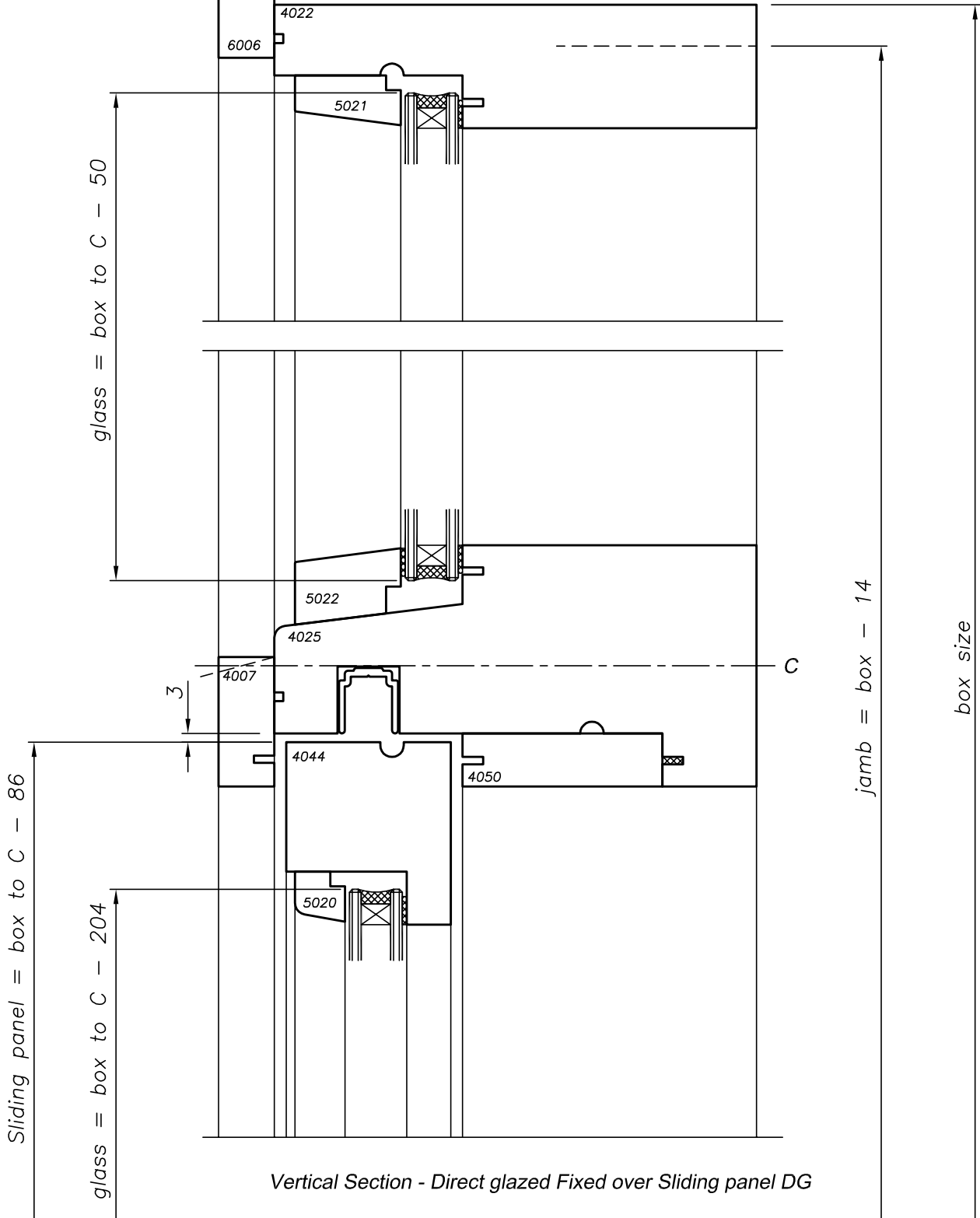

No	Revision	Date

Detail No:	
Scale: 1:2	Date: 1/6/2012
Drawing No:	S4-04-03

Deductions & Clearances

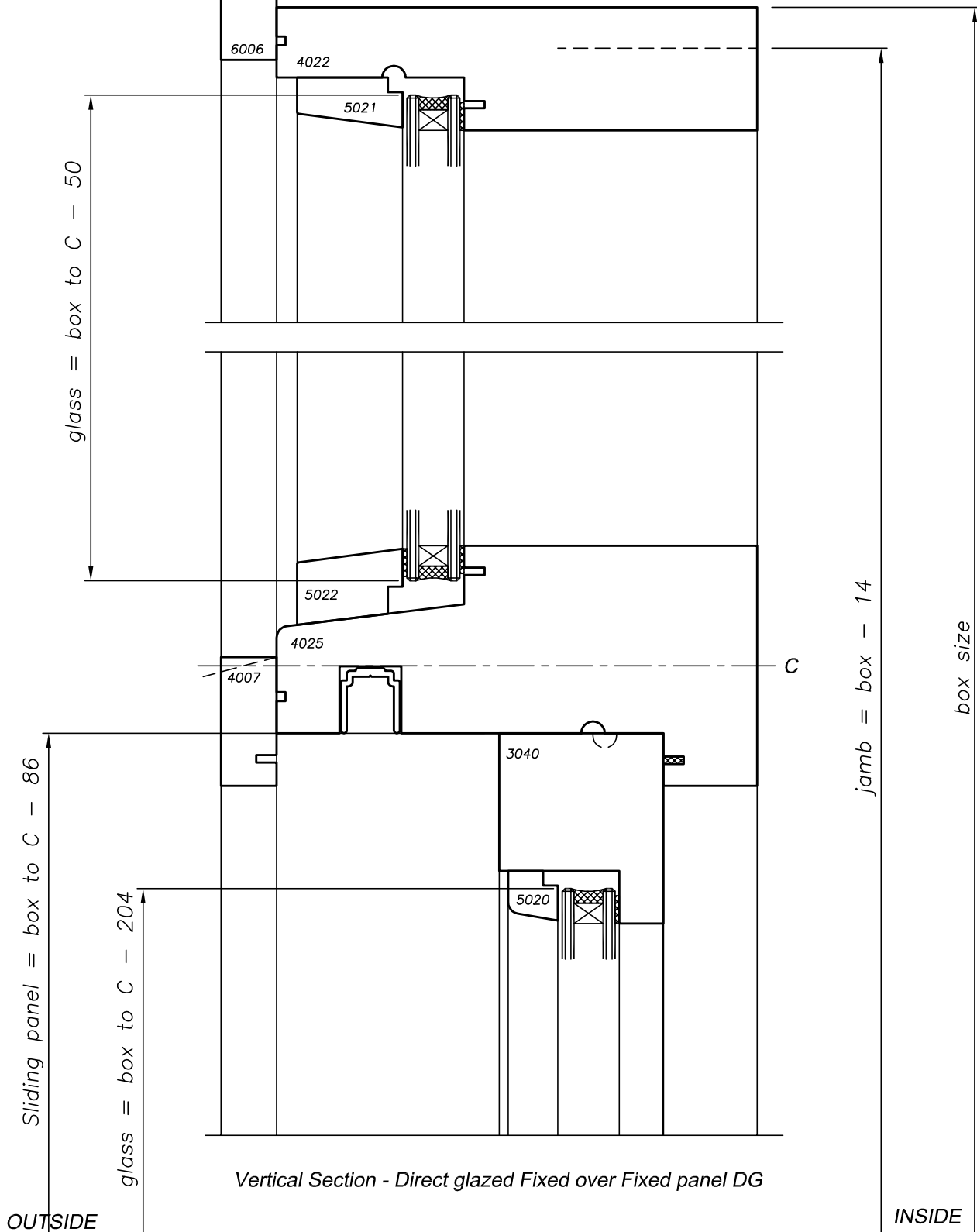

Deductions & Clearances

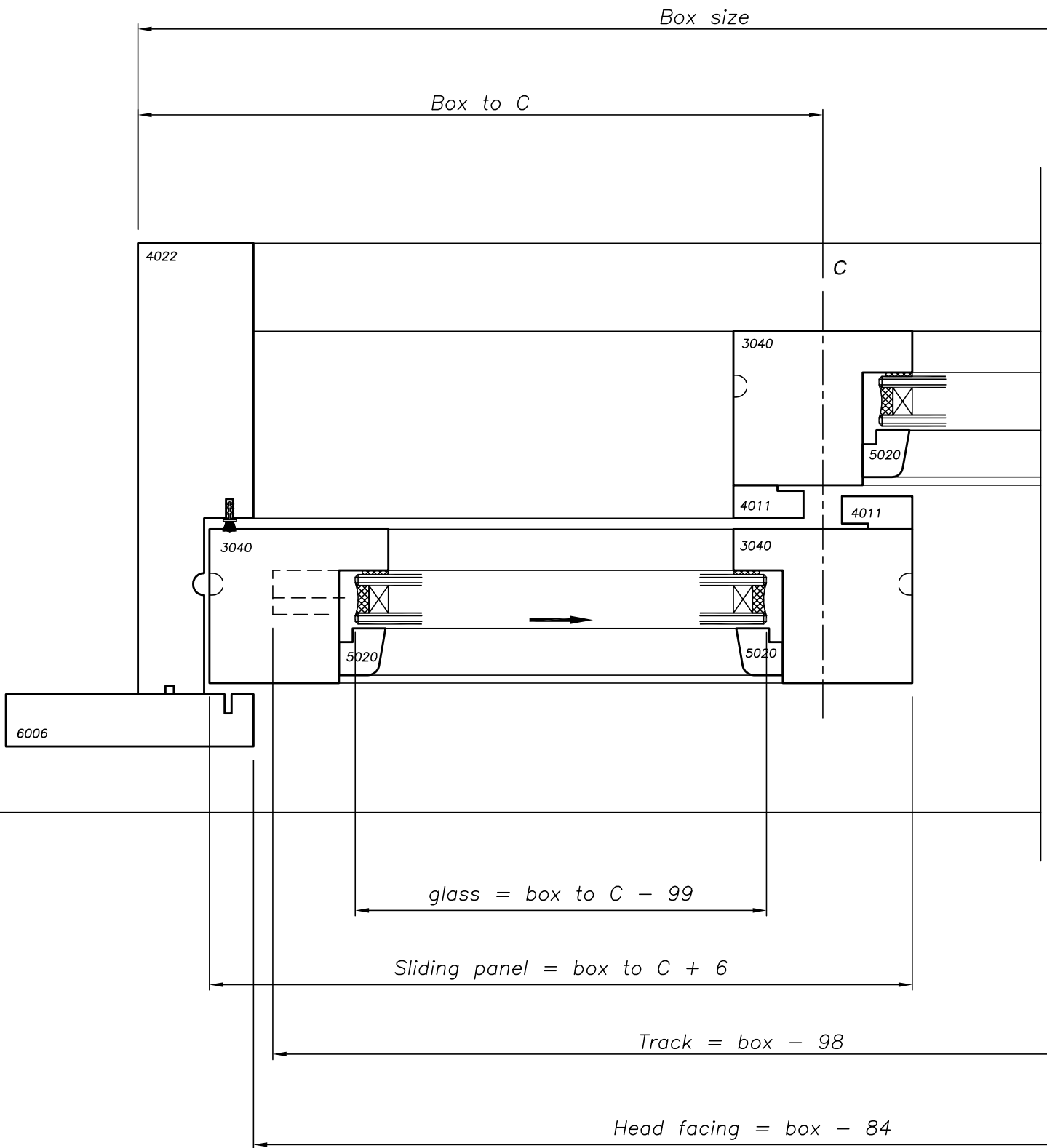

Horizontal Section - Sliding panel DG



No	Revision	Date	Detail No:
			Scale: 1:2 Date: 1/6/2012
			Drawing No: S4-04-05

Deductions & Clearances

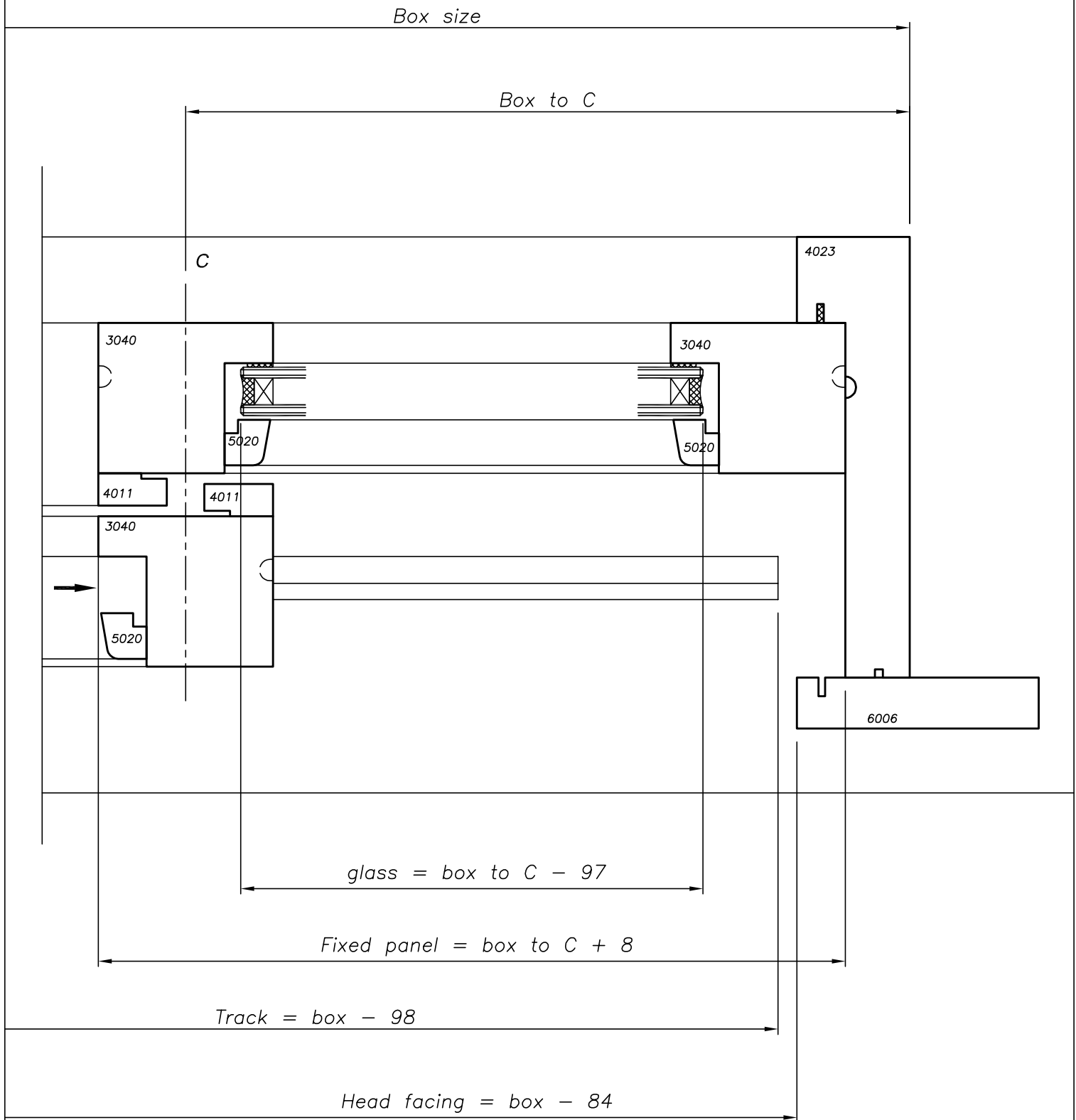

Horizontal Section - Fixed panel DG



No	Revision	Date	Detail No:
			Scale: 1:2 Date: 1/6/2012
			Drawing No: S4-04-06

Deductions & Clearances

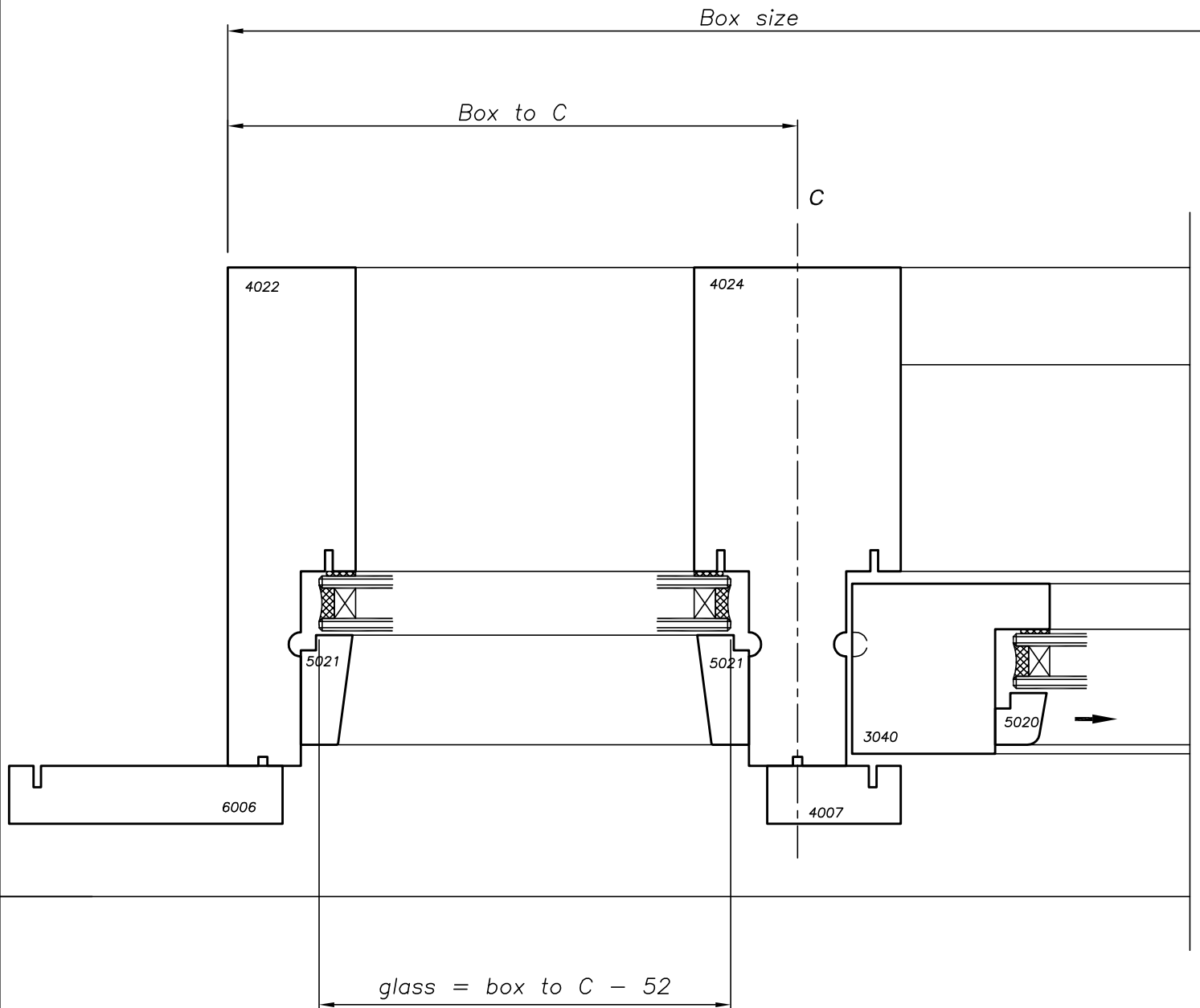

Horizontal Section - Sidelight (direct glazed) DG



No	Revision	Date	Detail No:
			Scale: 1:2 Date: 1/6/2012
			Drawing No: S4-04-07

Deductions & Clearances

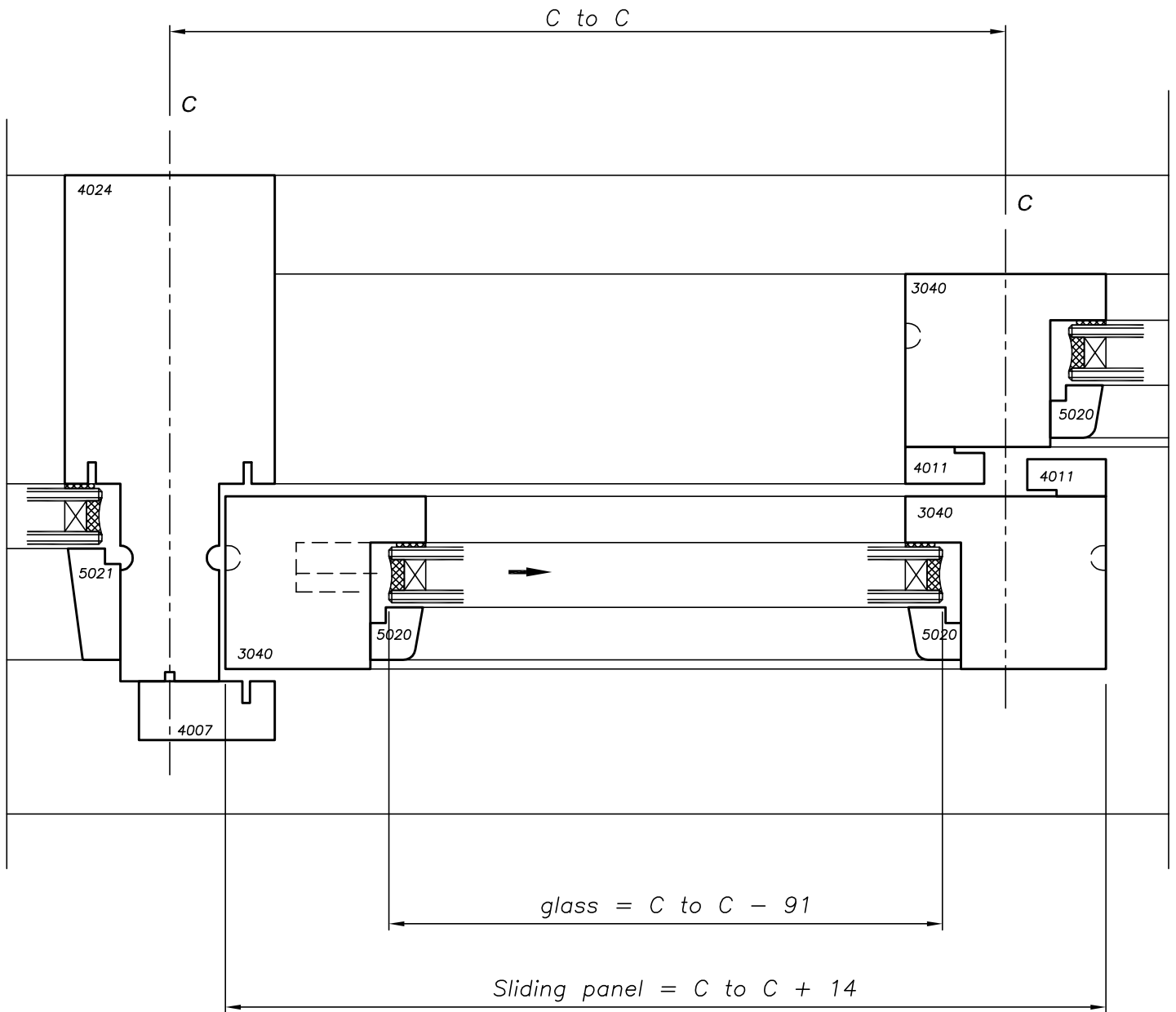

Horizontal Section - 3 Panel, center panel sliding DG



No	Revision	Date	Detail No:
			Scale: 1:2 Date: 1/6/2012
			Drawing No: S4-04-08

Deductions & Clearances

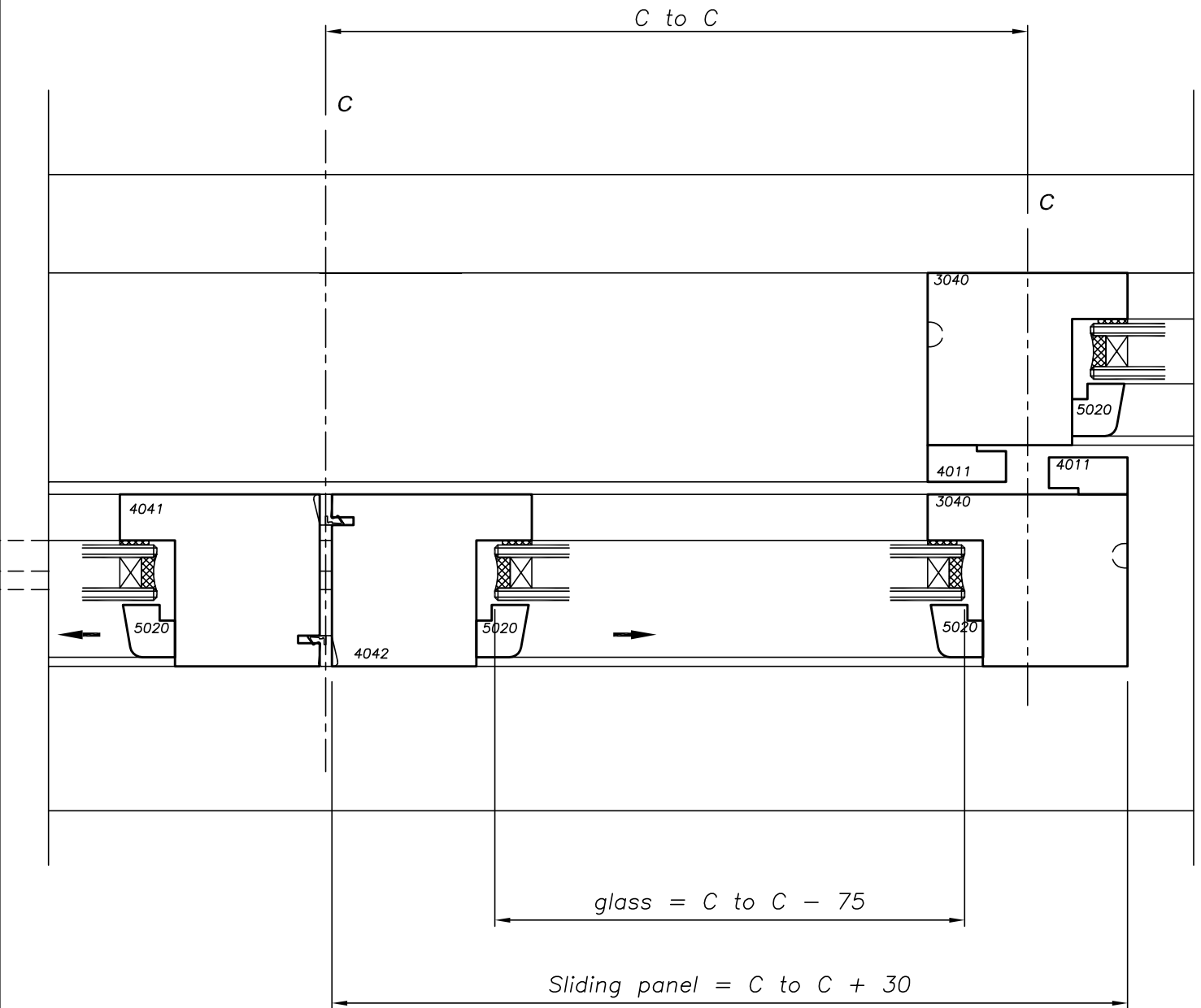

Horizontal Section - 4 Panel, DG



No	Revision	Date	Detail No:
			Scale: 1:2 Date: 1/6/2012
			Drawing No: S4-04-09

Deductions & Clearances

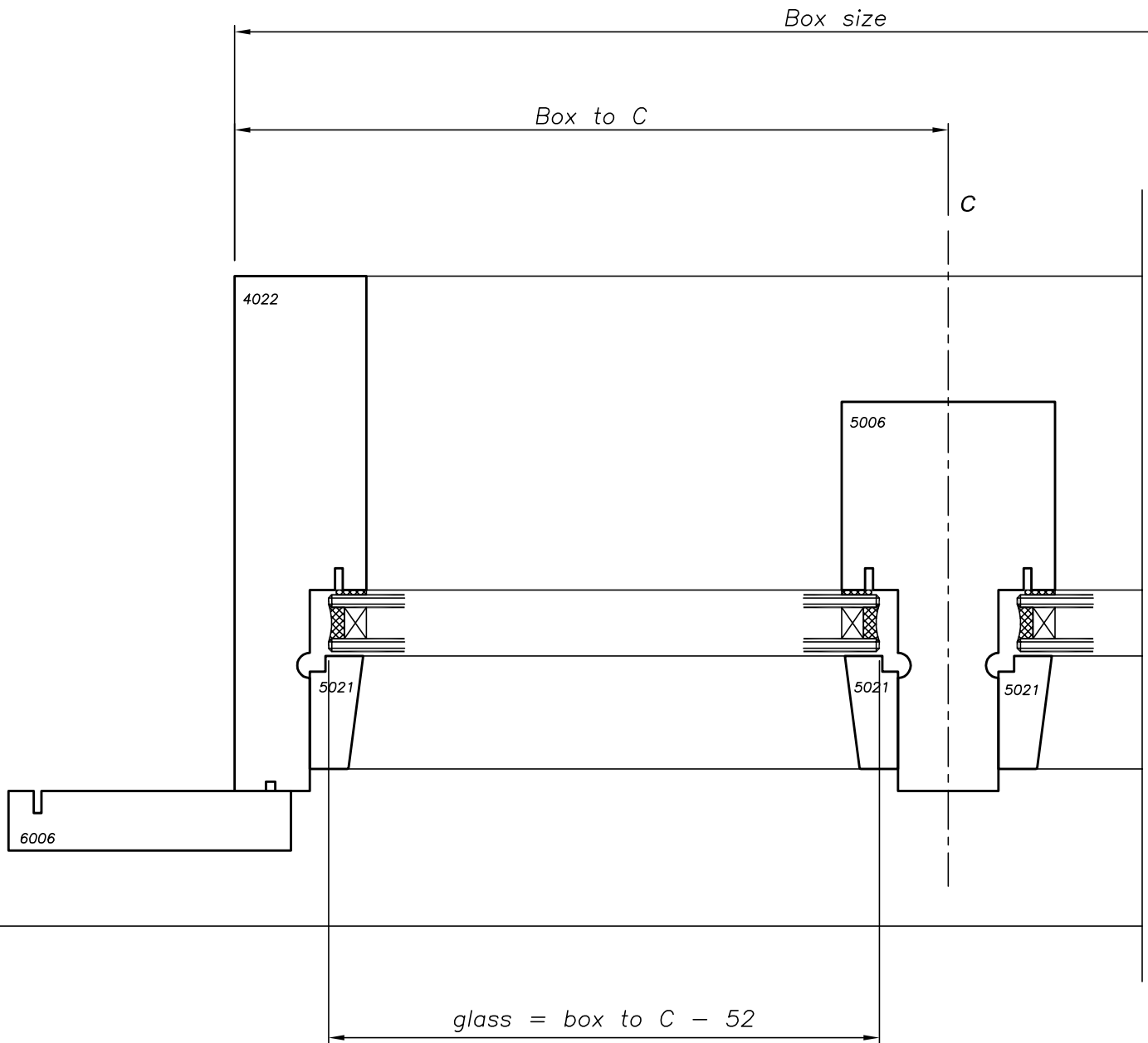

Horizontal Section - Mullion in overhead, (Direct glazed) DG



No	Revision	Date	Detail No:
			Scale: 1:2 Date: 1/6/2012
			Drawing No: S4-04-10