



COMPLIANT TIMBER JOINERY

NEW ZEALAND LIMITED

7000 Series

Hinged and French Door

Profiles - Single Glazed

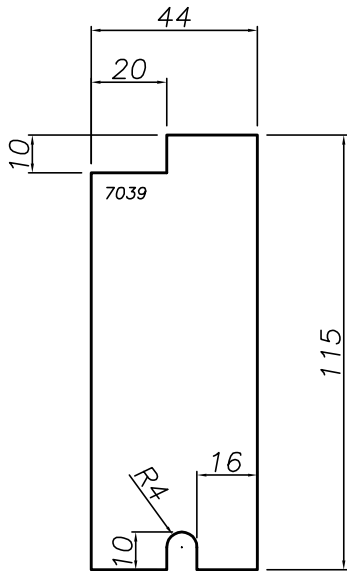

7039 115mm Rail with weather groove
Used for fixed sidelight panel top rail.

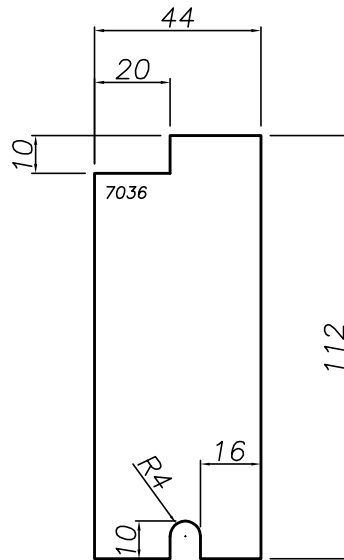

7036 112mm Rail with weather groove
Used for swing panel top rail.

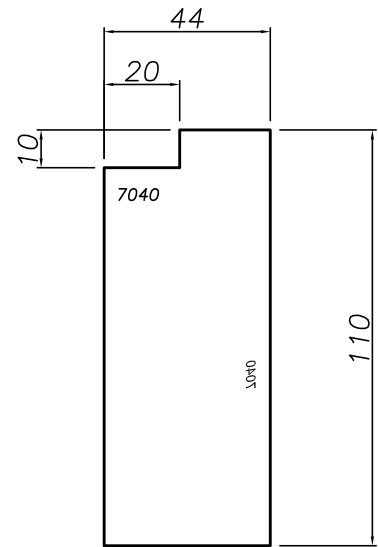

7040 110mm Door stile plain end
All door stiles are 110mm, this manual has no width adjustment between fixed sidelight stile width and swing stile width.

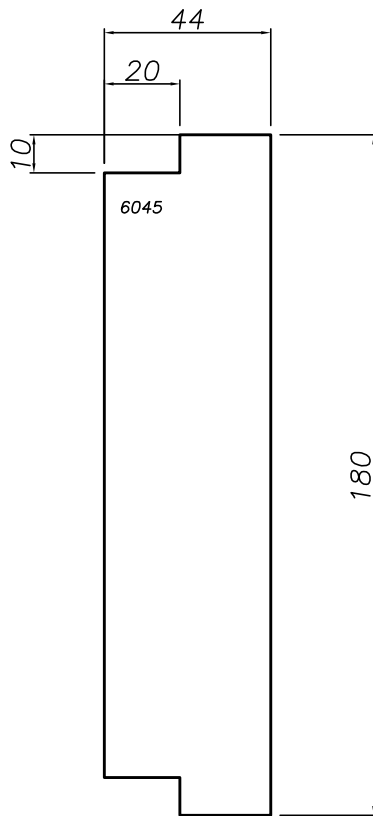

6045 180mm mid rail
Size varies to suit.



7037 174mm rail
Used for swing panels.

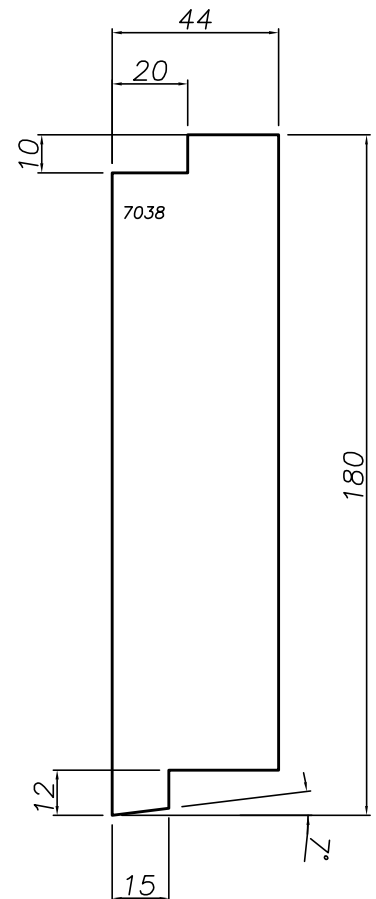

7038 180mm rail
Used for fixed sidelight panels.



No	Revision	Date	Detail No:
			Scale: 1:2 Date: 1/6/2012
			Drawing No: S7A-01-01

Profiles - Single Glazed

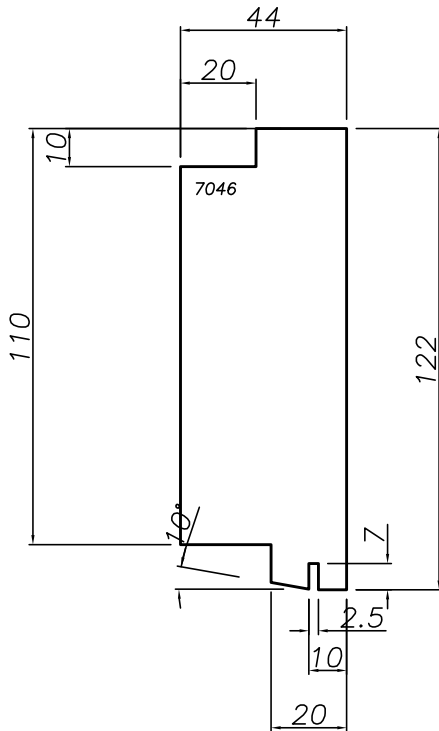

7046 110mm Door stile
French door 1st closing

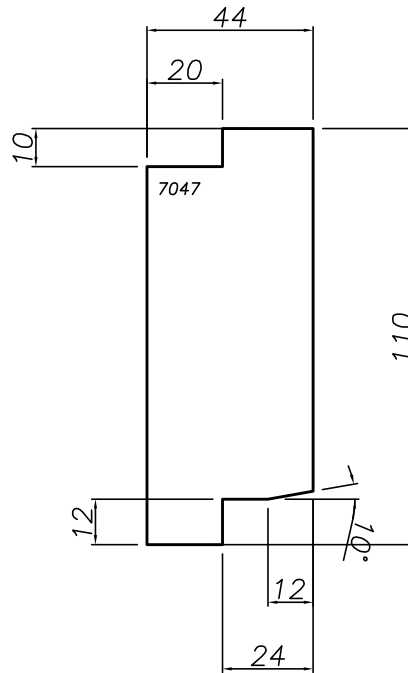

7047 110mm Door stile
French door 2nd closing

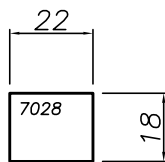

7028 Rod system trench
fillet

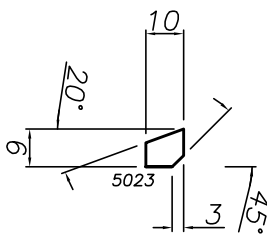

5023 Single Glazing
Bead

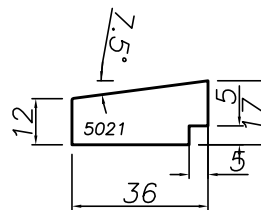

5021 Direct glaze to
head / jamb Glazing
Bead

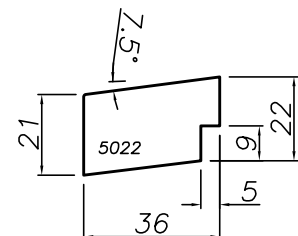

5022 Direct glaze to sill
Glazing Bead



No	Revision	Date	Detail No:
			Scale: 1:2 Date: 1/6/2012
			Drawing No: S7A-01-02

Profiles - Single Glazed

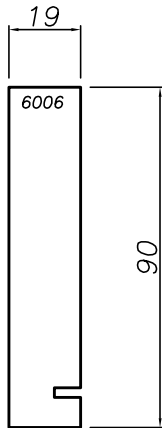

6006 Facing board

Kerf not needed in hinged door product facing boards.

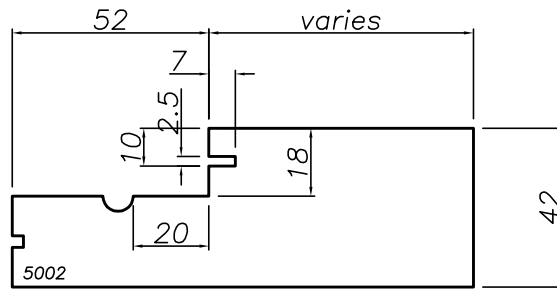

5002 Jamb / head

Notes;

- Single glazed panels are 44mm thick.
- Single glazed heads, jambs, mullions and transoms are 12mm smaller than double glazed versions.
- The sill remains the same for both versions so will show more nose when used with single glazed frame components

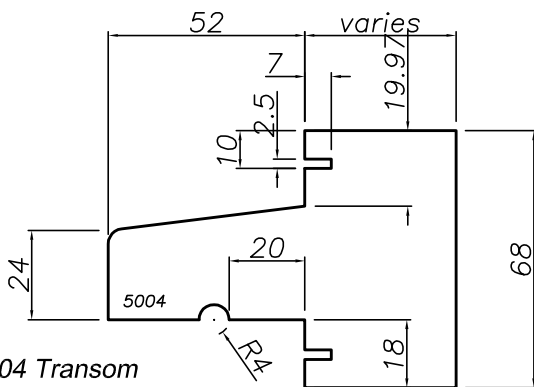

5004 Transom

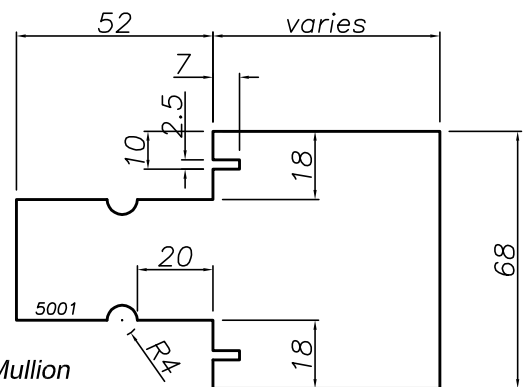

5001 Mullion

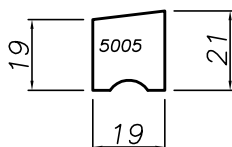

5005 Transom weather bead

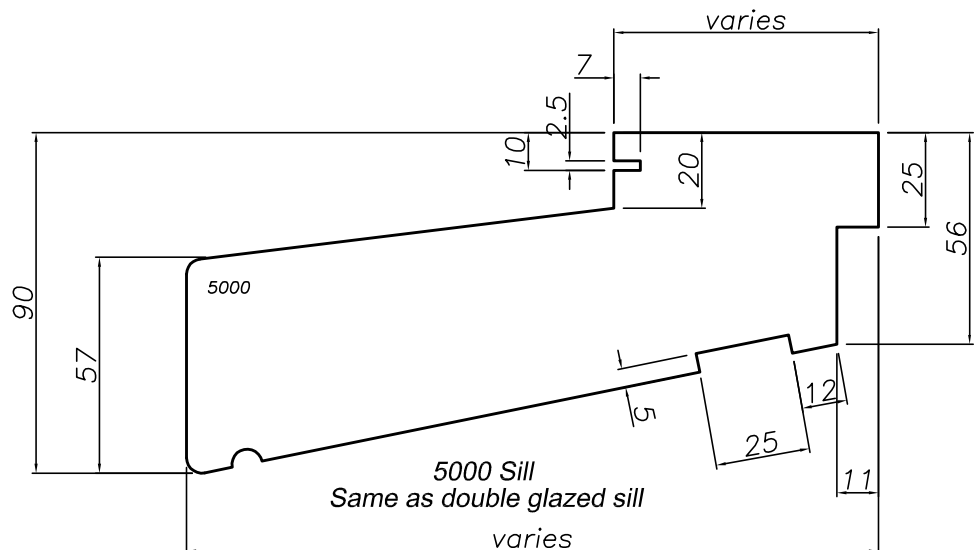

5000 Sill
Same as double glazed sill
varies



No	Revision	Date	Detail No:
			Scale: 1:2 Date: 1/6/2012
			Drawing No: S7A-01-03

Profiles - Double Glazed

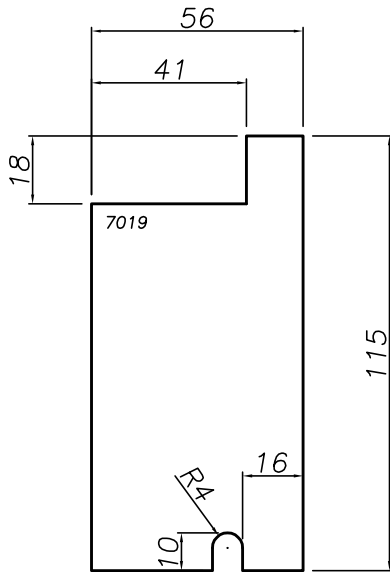

7019 115mm Rail with weather groove

Used for fixed sidelight panel top rail.

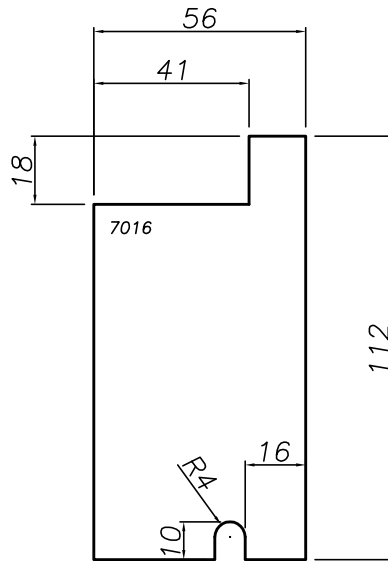

7016 112mm Rail with weather groove

Used for swing panel top rail.

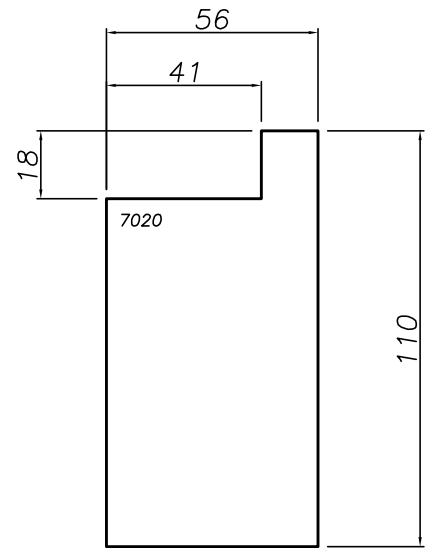

7020 110mm Door stile plain end

All door stiles are 110mm, this manual has no width adjustment between fixed sidelight stile width and swing stile width.

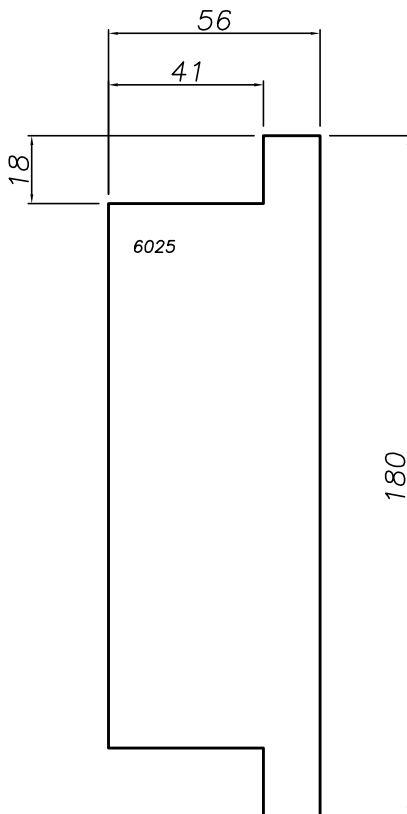

6025 180mm mid rail

Size varies to suit.

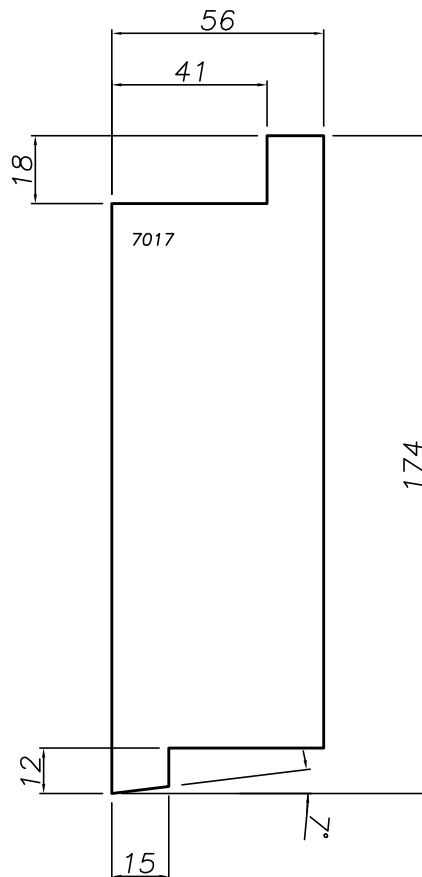

7017 174mm rail

Used for swing panels.

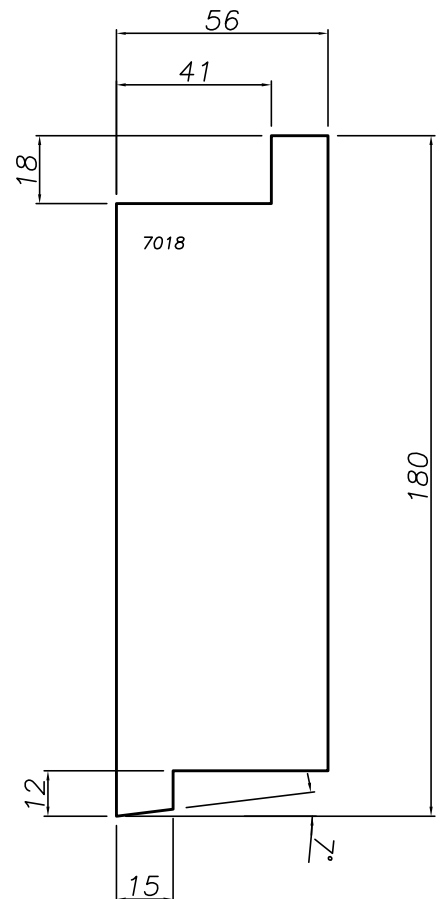

7018 180mm rail

Used for fixed sidelight panels.



No	Revision	Date	Detail No:
			Scale: 1:2 Date: 1/6/2012
			Drawing No: S7A-01-04

Profiles - Double Glazed

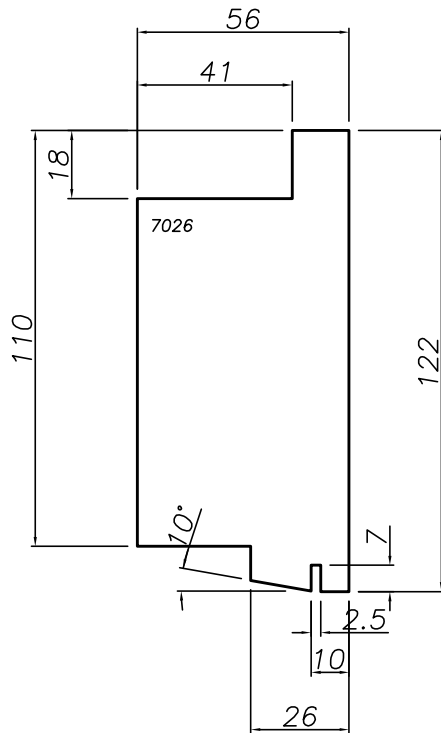

7026 110mm Door stile
French door 1st closing

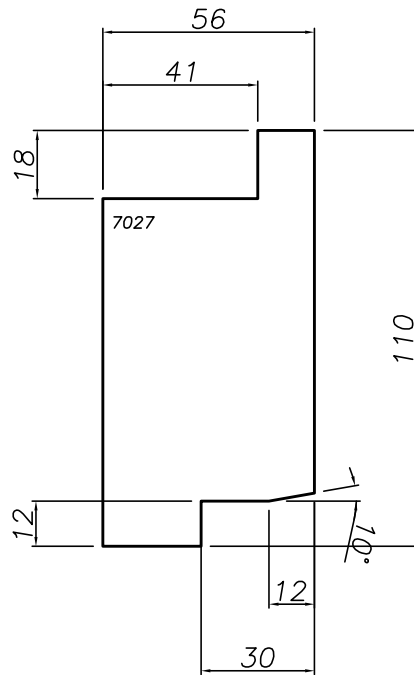

7027 110mm Door stile
French door 2nd closing

*check rebate works for
locks*

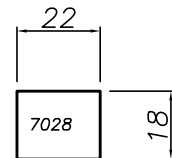

7028 Rod system trench
fillet

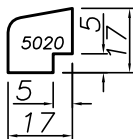

5020 Double Glazing
Bead

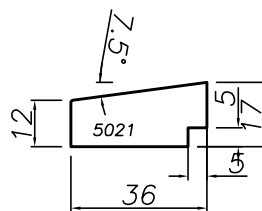

5021 Direct glaze to
head / jamb Glazing
Bead

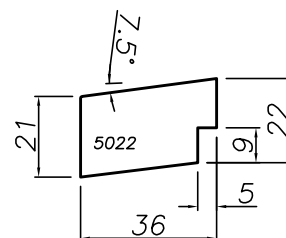

5022 Direct glaze to sill
Glazing Bead



No	Revision	Date	Detail No:
			Scale: 1:2 Date: 1/6/2012
			Drawing No: S7A-01-05

Profiles - Double Glazed

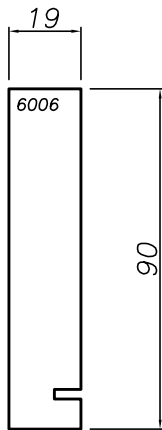

6006 Facing board

Kerf not needed in hinged door product facing boards.

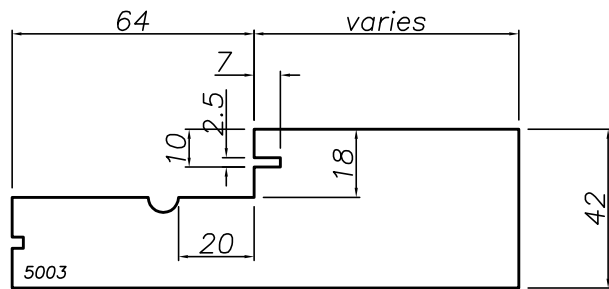

5003 Head / Jamb

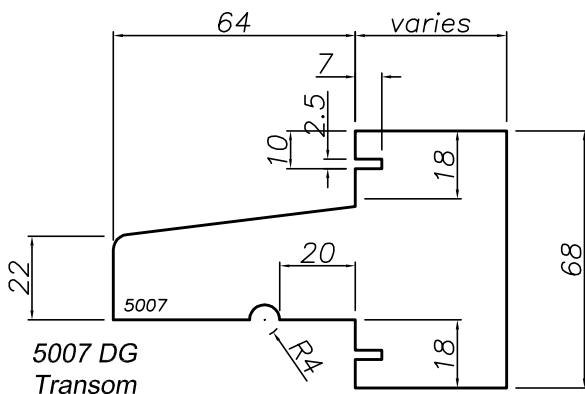

5007 DG Transom

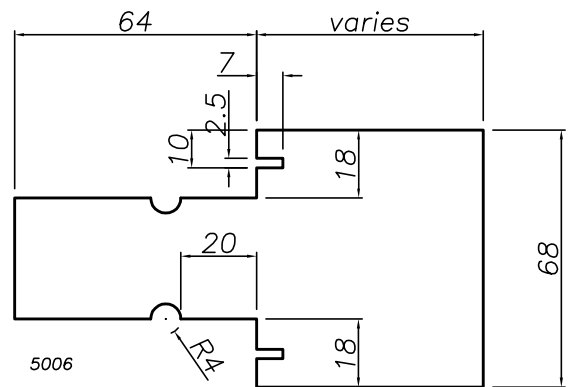

5006 DG Mullion

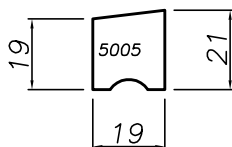

5005 Transom weather bead

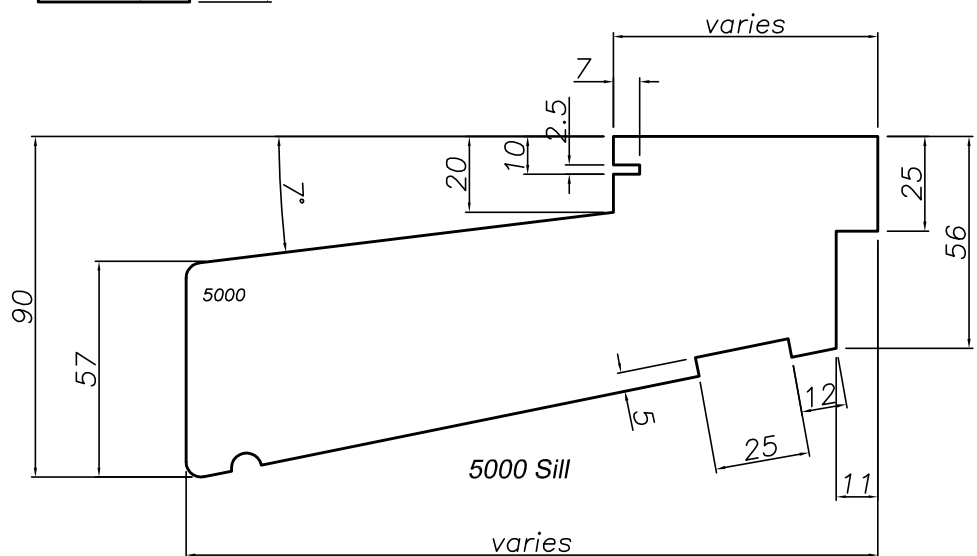

5000 Sill



No	Revision	Date	Detail No:
			Scale: 1:2 Date: 1/6/2012
			Drawing No: S7A-01-06

Hardware



Part #	Desc.	
16011	Frame seal	

Part #	Desc.	
.	Lock Set	

Part #	Desc.	
.	Strike Set	

Part #	Desc.	
.	Rebated Strike Set	

Part #	Desc.	
.	Rod System	

Part #	Desc.	
.	Flushbolts	

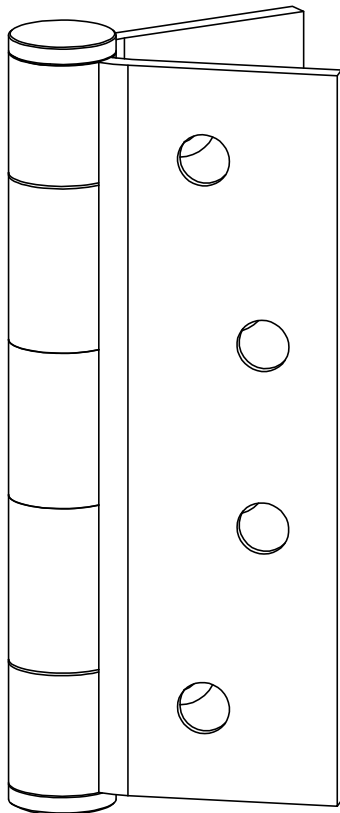

Part #	Desc.	
11160	SS Jamb hinge	



No	Revision	Date	Detail No:
			Scale: 1:1 Date: 1/6/2012
			Drawing No: S7A-02-01

Cross Sections

3 — See detail on relevant page

For Awning or casement sash details
in side or overlights, see 5000
window section of technical manual

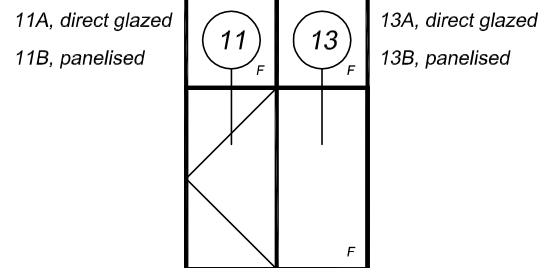
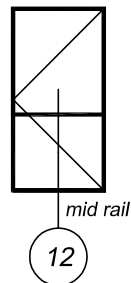
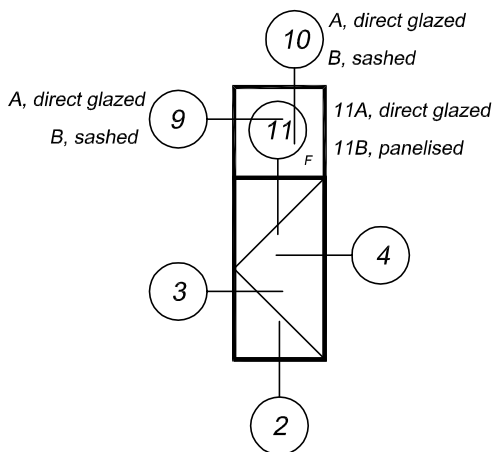
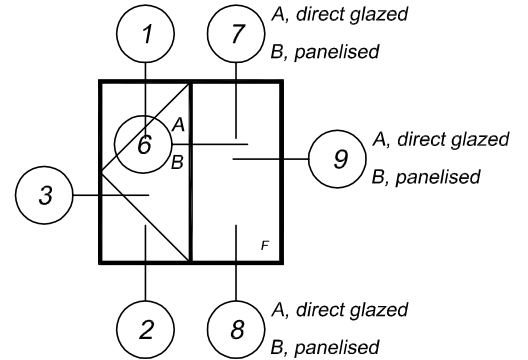
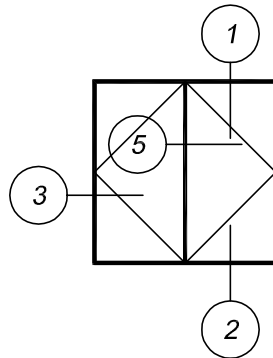
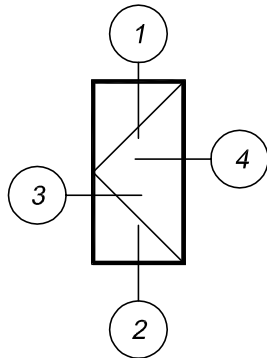

No	Revision	Date	Detail No:
			Scale: 1:1 Date: 1/6/2012
			Drawing No: S7A-03-01

Cross Section Details

6006 head facing

Detail 1 Head

6006 jamb facing beyond

OUTSIDE

INSIDE

30 x 12g SS nails @ 200 ctrs

5003 head

7016 top rail

glazing to specification, see glazing details

7017 bottom rail

5003 Jamb

16011 seal 4 sides

5000 sill

Detail 2 Sill



No	Revision	Date

Detail No:	1 & 2
Scale: 1:2	Date: 1/6/2012
Drawing No:	S7A-03-02

Cross Section Details

INSIDE

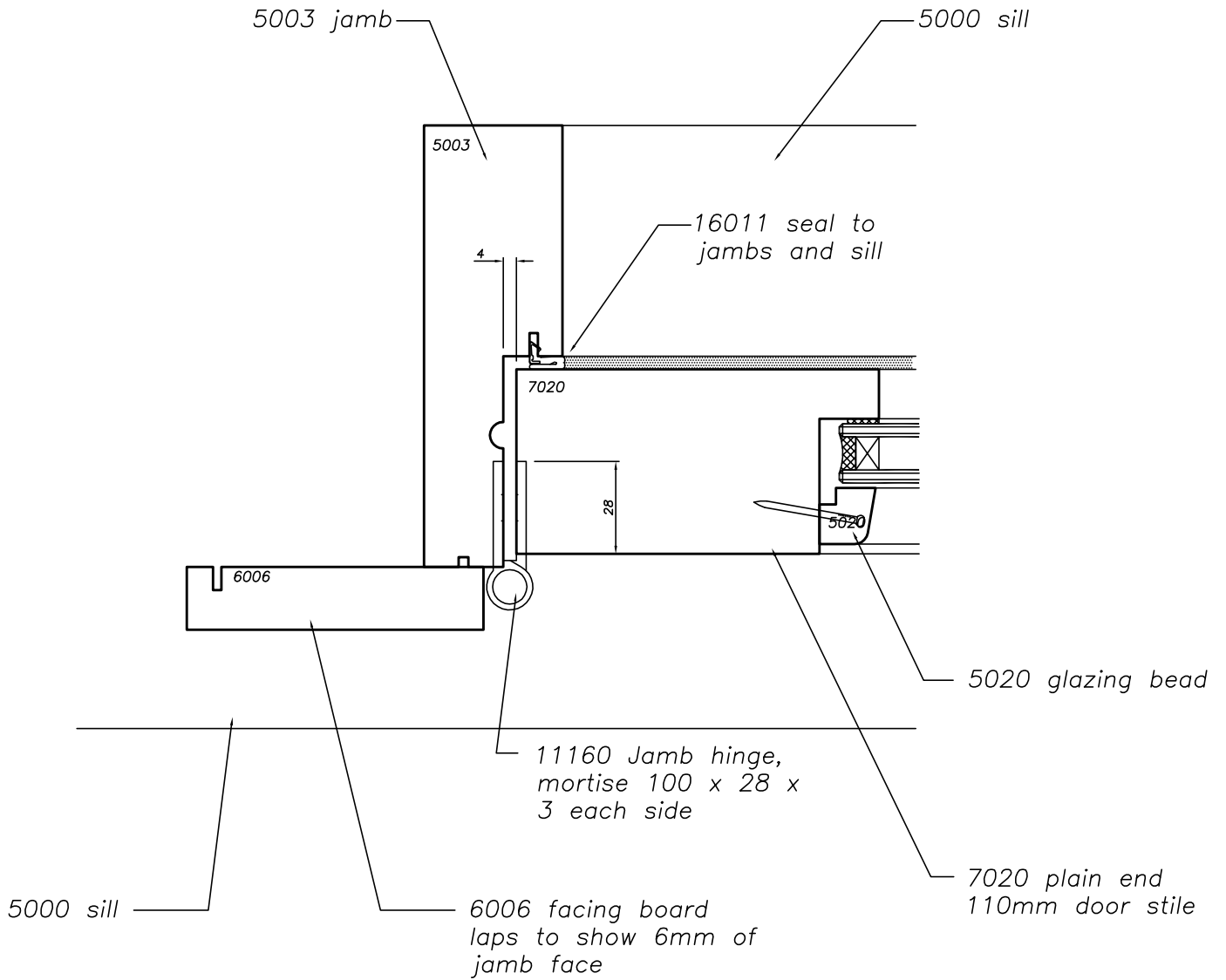

OUTSIDE

Detail 3 Hinged Jamb



No	Revision	Date	Detail No:
			3
			Scale: 1:2 Date: 1/6/2012
			Drawing No: S7A-03-03

Cross Section Details

INSIDE

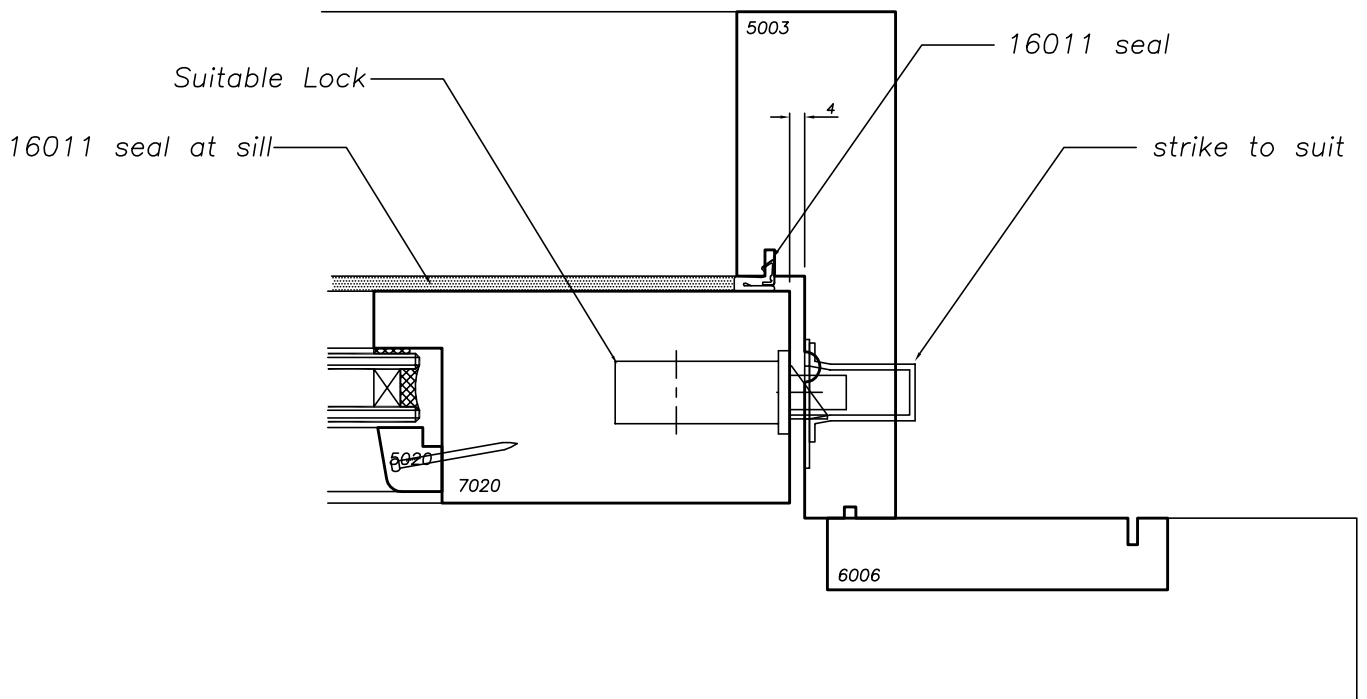

OUTSIDE

Detail 4 strike jamb



No	Revision	Date	Detail No:
			4
			Scale: 1:2 Date: 1/6/2012
			Drawing No: S7A-03-04

Cross Section Details

INSIDE

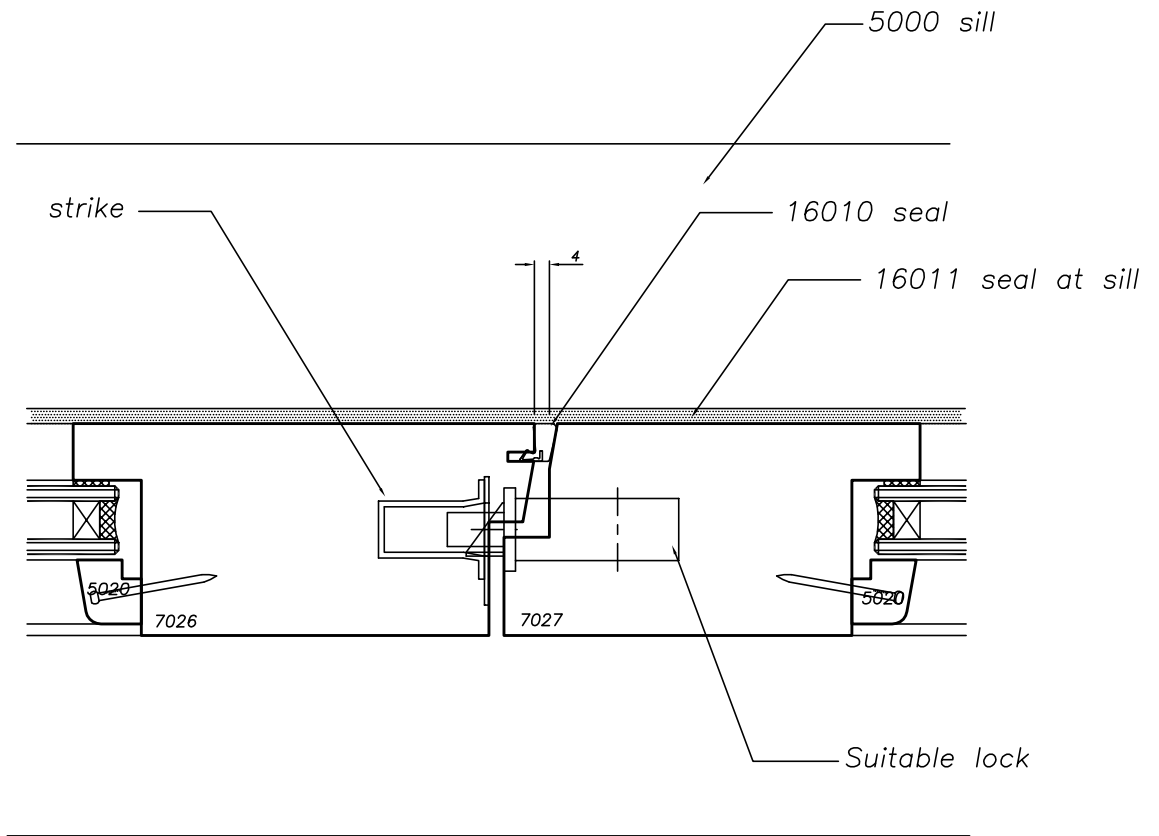

OUTSIDE

Detail 5 French door



No	Revision	Date	Detail No:
			5
			Scale: 1:2 Date: 1/6/2012
			Drawing No: S7A-03-05

Cross Section Details

INSIDE

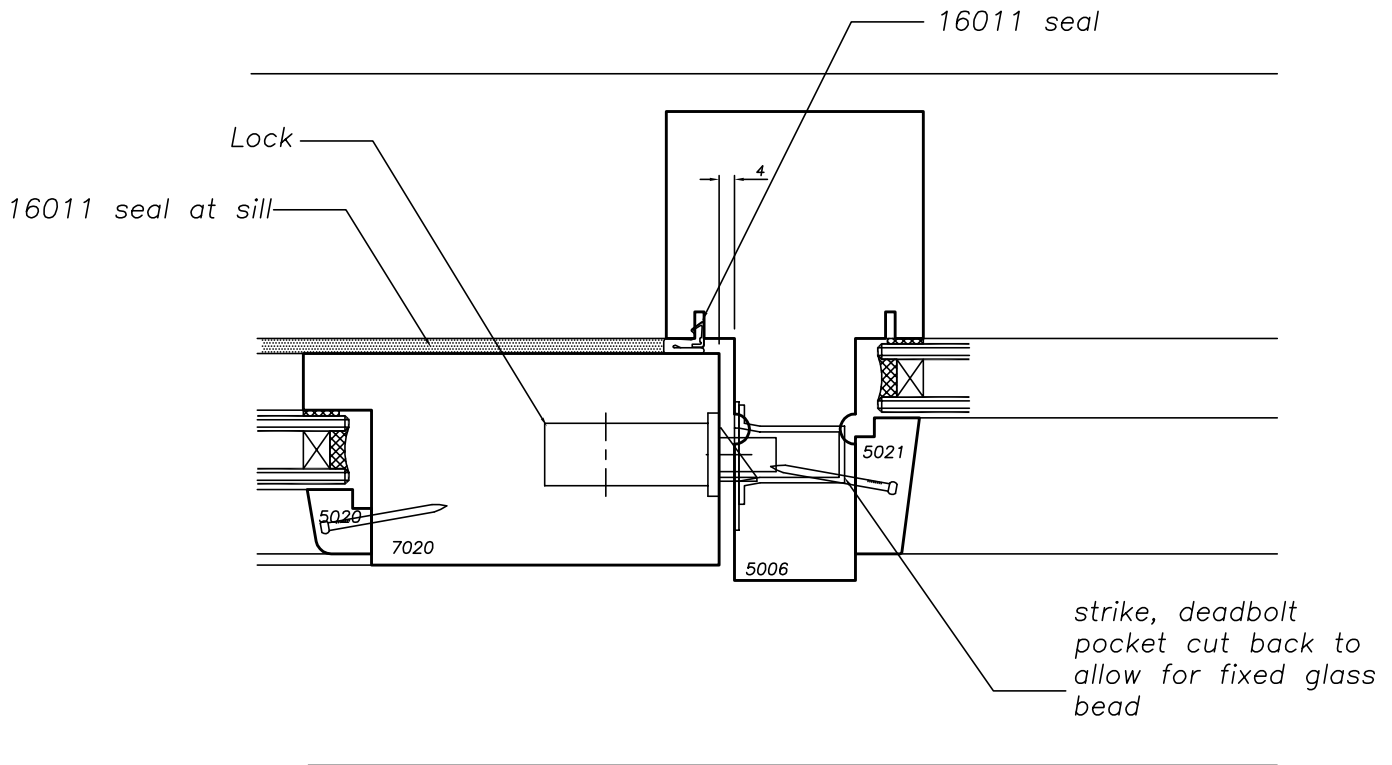

OUTSIDE

Detail (6A) strike mullion, fixed sidelight direct glazed



No	Revision	Date	Detail No:
			6A
			Scale: 1:2 Date: 1/6/2012
			Drawing No: S7A-03-06

Cross Section Details

INSIDE

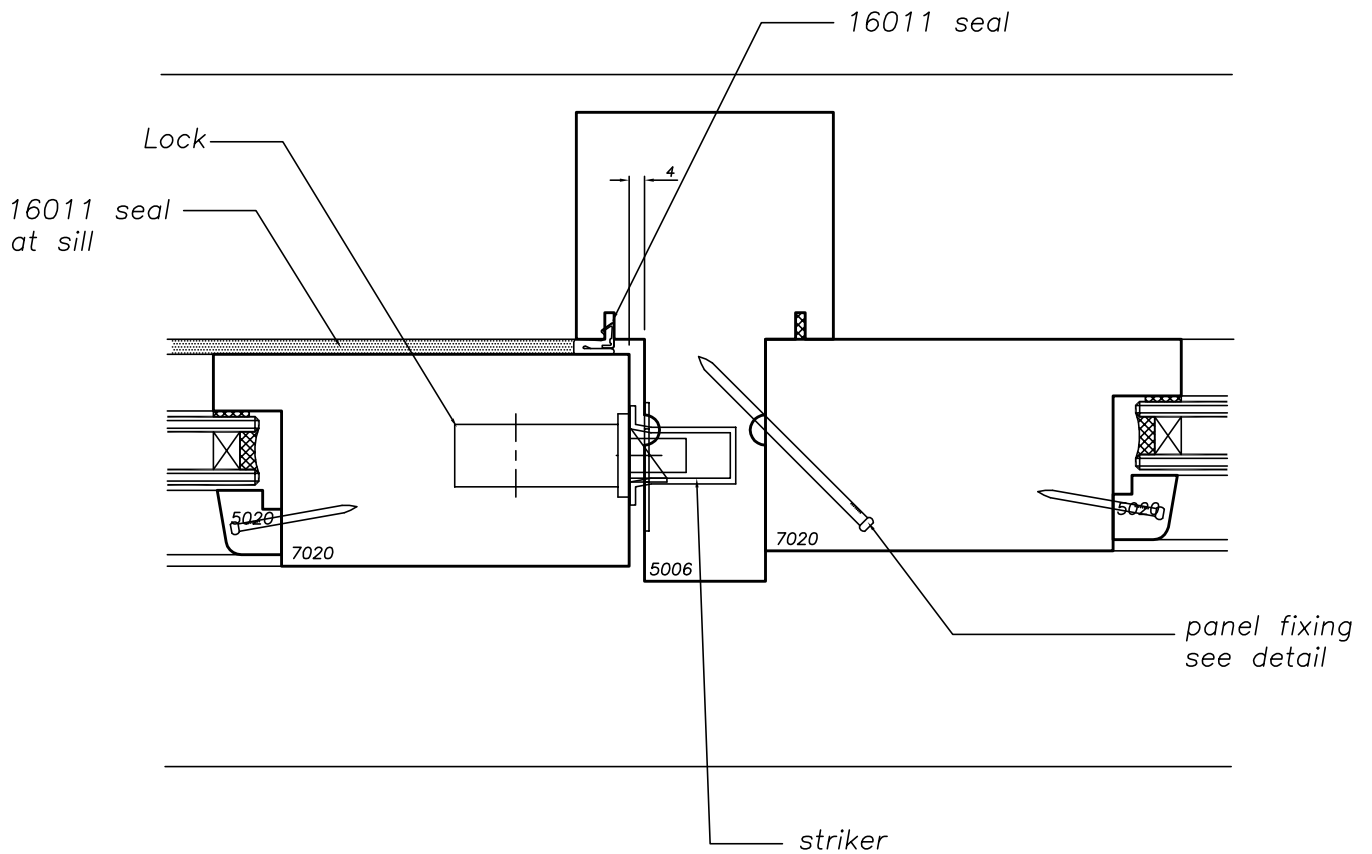

OUTSIDE

Detail **6B** strike mullion, fixed sidelight panelised



No	Revision	Date	Detail No:
			6B
			Scale: 1:2 Date: 1/6/2012
			Drawing No: S7A-03-07

Cross Section Details

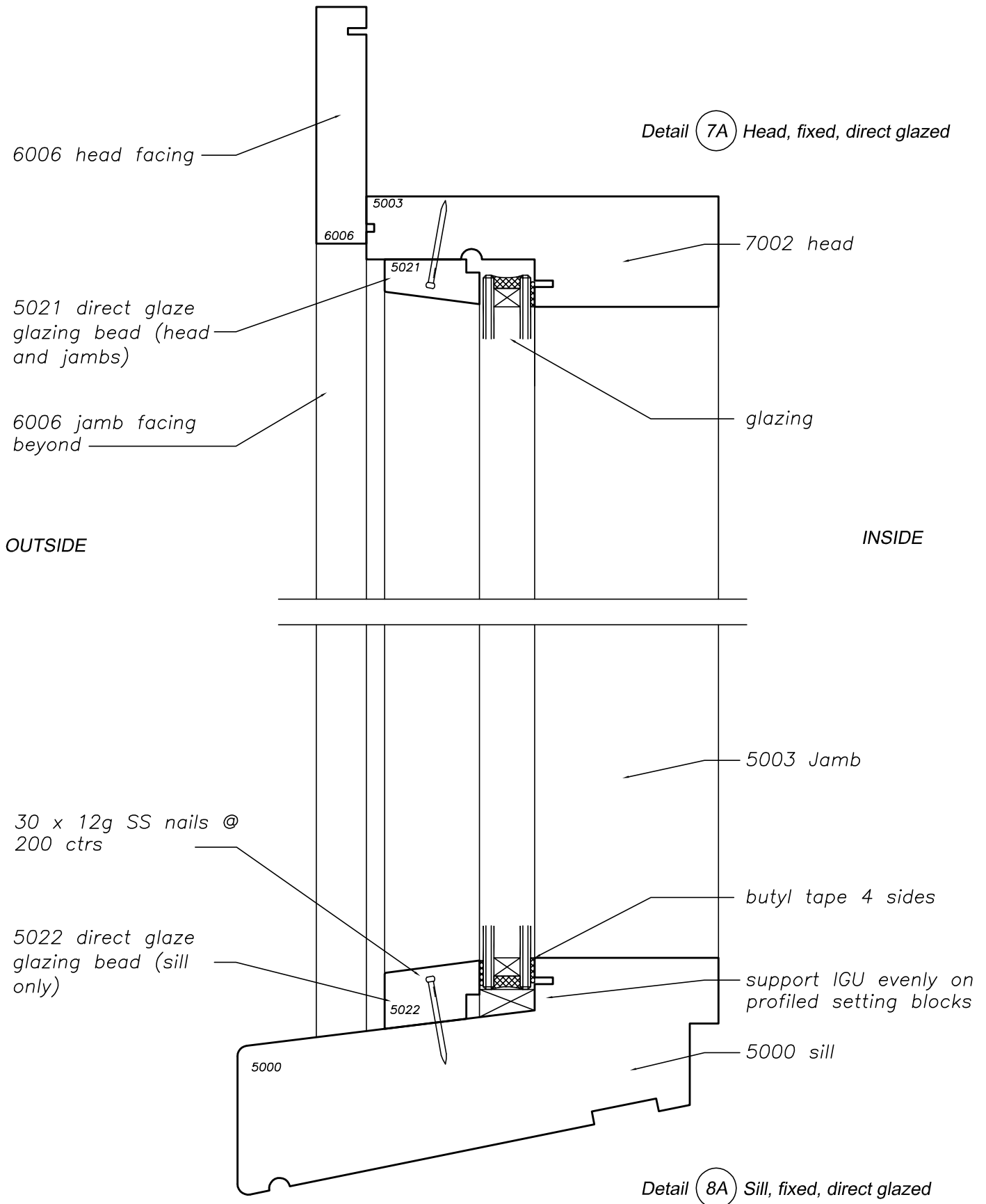

Cross Section Details

Detail **7B** Head, fixed, panelised

6006 head facing

panel fixing
see detail

6006 jamb facing
beyond

OUTSIDE

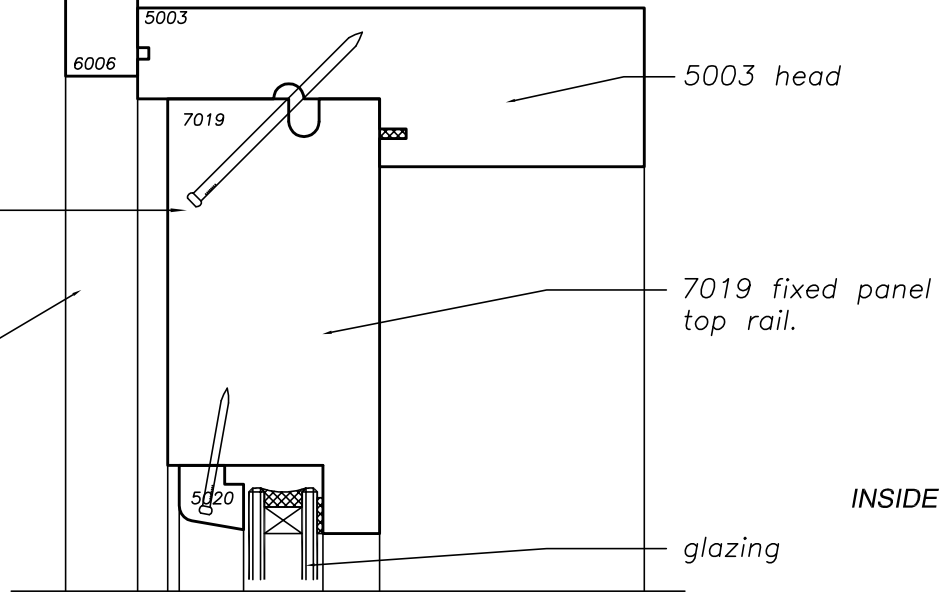

INSIDE

panel fixing
see detail

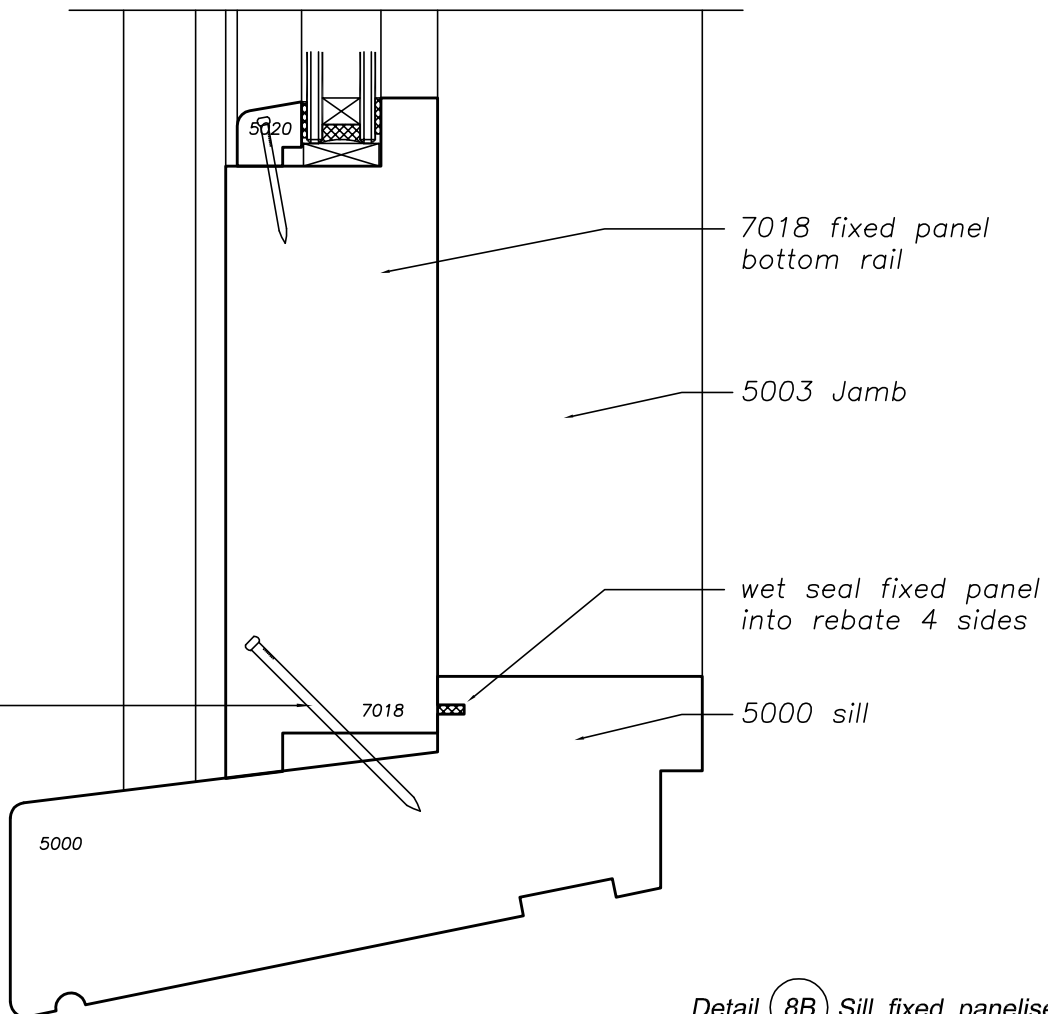

Detail **8B** Sill, fixed, panelised



No	Revision	Date

Detail No: **7B & 8B**
 Scale: 1:2 Date: 1/6/2012
 Drawing No: **S7A-03-09**

Cross Section Details

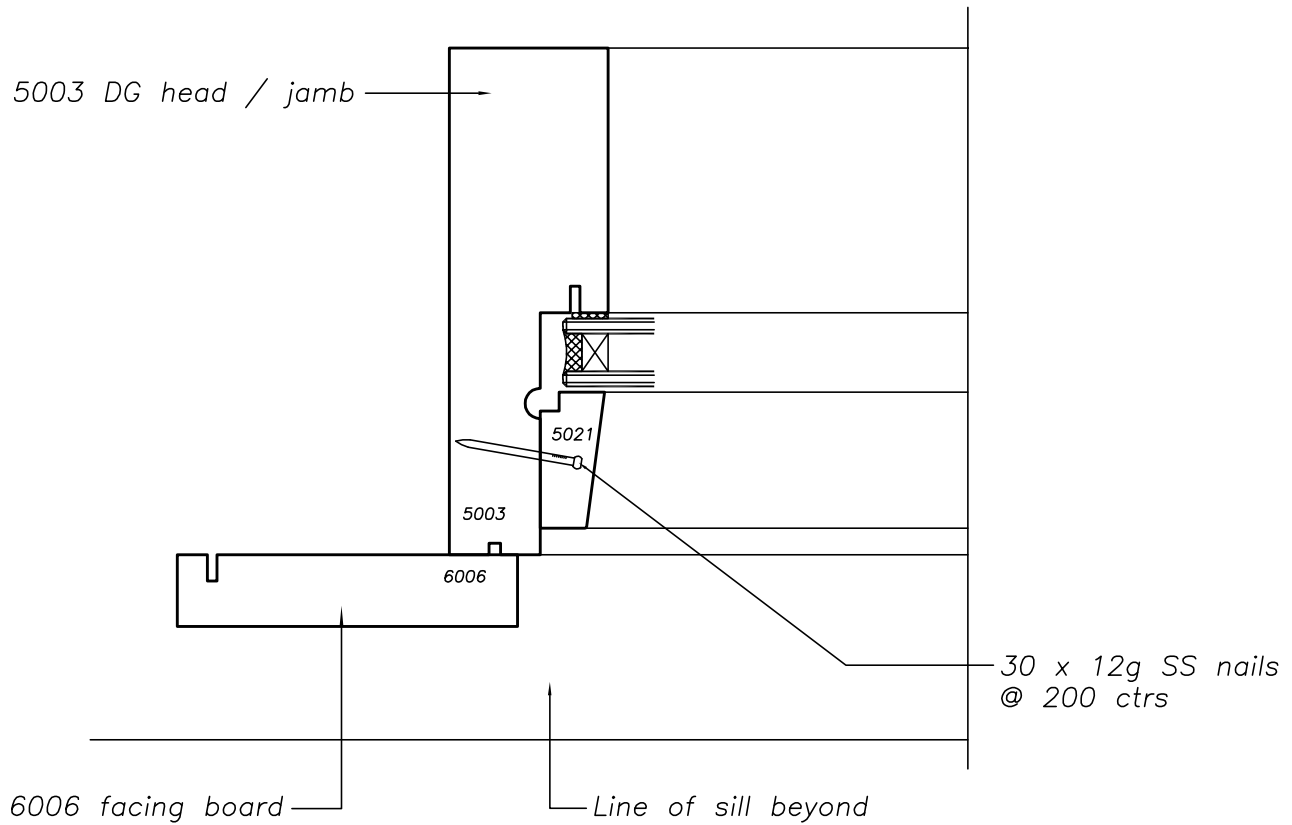

9A Jamb, overlight / sidelight, fixed glazing, direct



No	Revision	Date	Detail No:
			9A
			Scale: 1:2 Date: 1/6/2012
			Drawing No: S7A-03-10

Cross Section Details

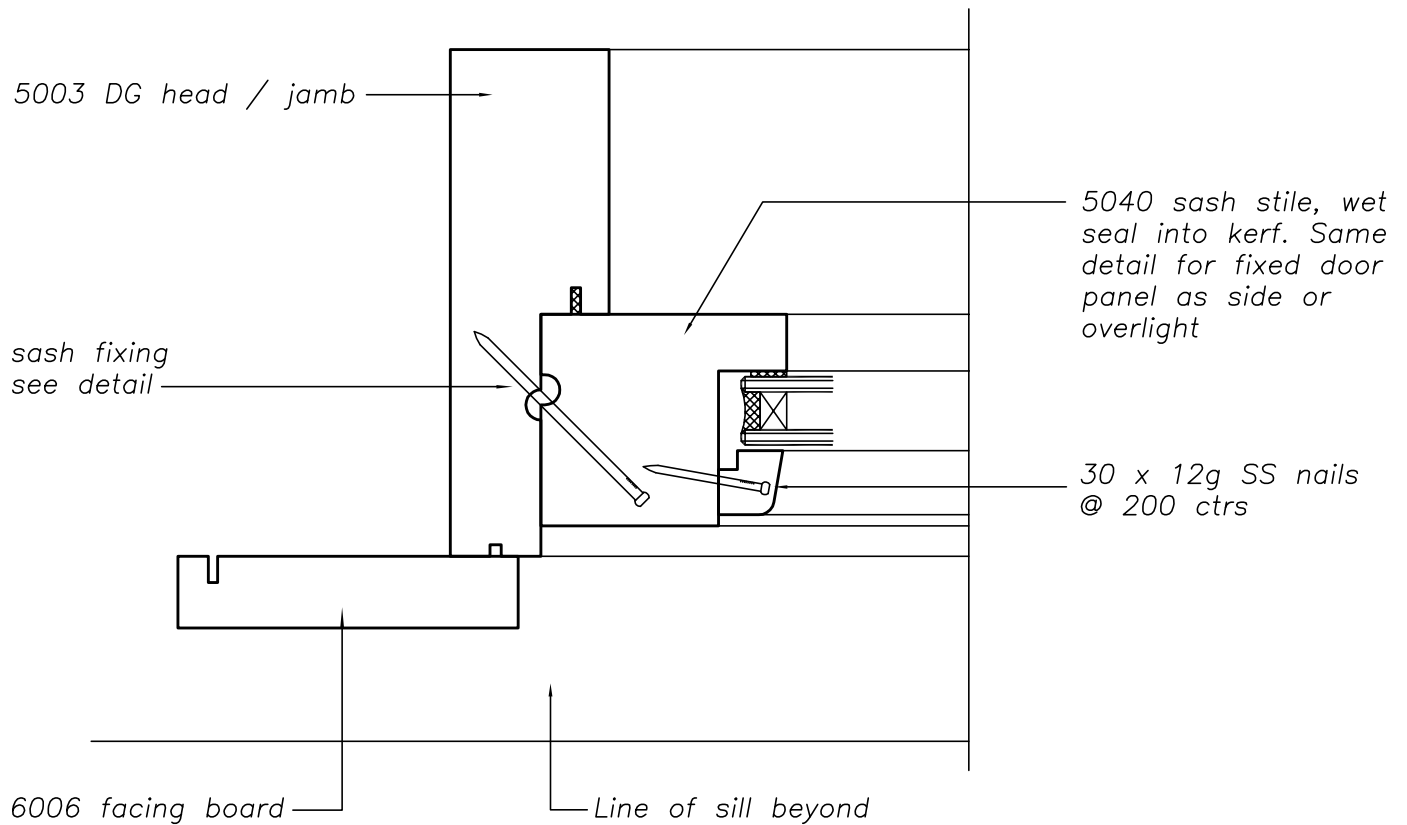

9B Jamb, overlight / sidelight. fixed glazing, sashed



No	Revision	Date	Detail No:
			9B
			Scale: 1:2 Date: 1/6/2012
			Drawing No: S7A-03-11

Cross Section Details

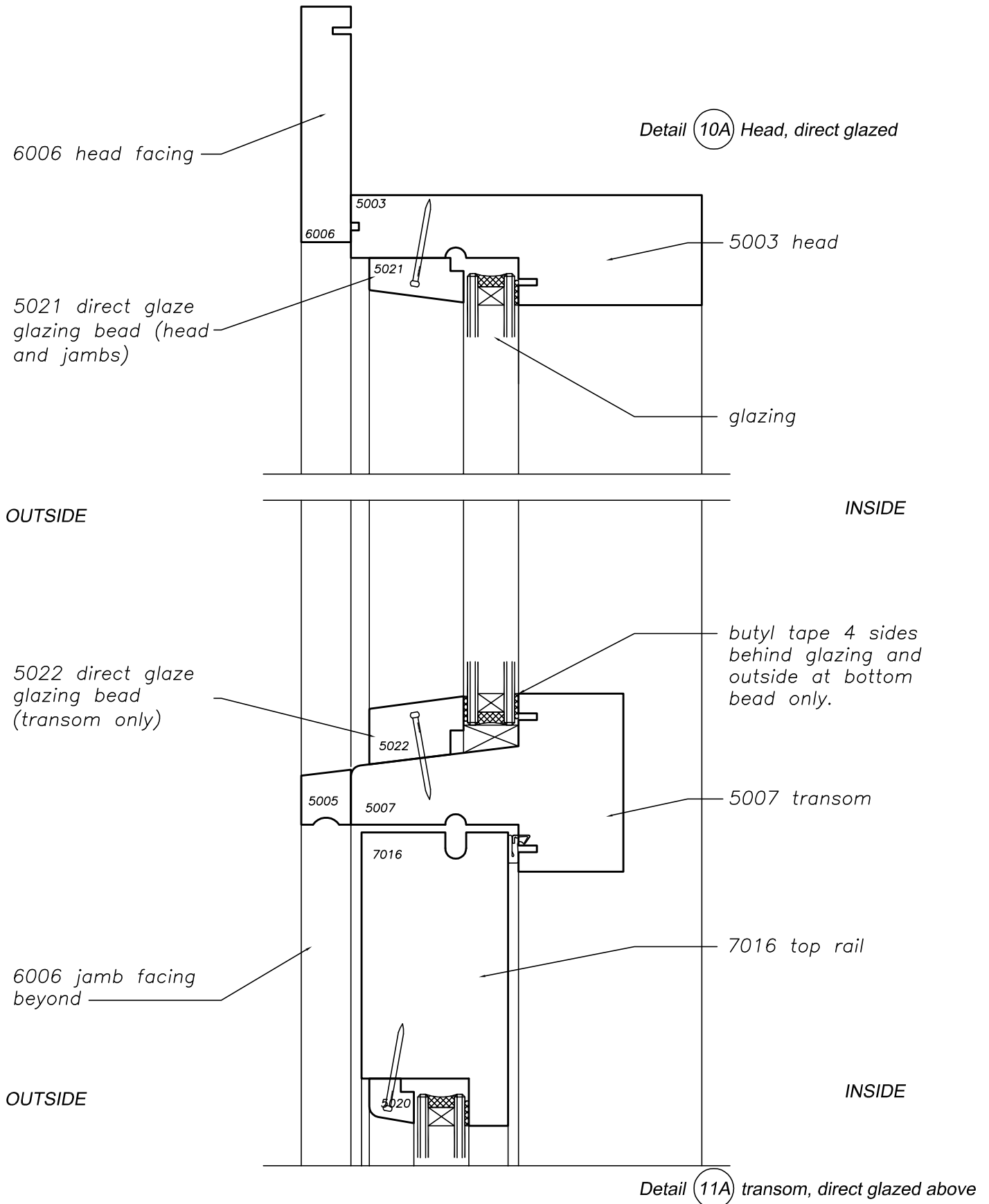

No	Revision	Date

Detail No:	10A & 11A
Scale: 1:2	Date: 1/6/2012
Drawing No:	S7A-03-12

Cross Section Details

6006 head facing

Detail (10B) Head, fixed sashed

sash fixing
see detail

30 x 12g SS nails @
200 ctrs

6006 jamb facing
beyond

Fixed or opening sash,
see window technical
manual for more detail

Double glazing, and
bead

5041 Fixed sash bottom
rail, DG, wet seal into
transom at kerf

sash fixing
see detail

5005 transom weather
bead

OUTSIDE

6006 jamb facing
beyond

OUTSIDE

5003 head

5040 fixed sash
top rail, DG, wet
seal into kerf

INSIDE

5007 transom

7016 top rail

Detail (11B) transom, fixed sashed above



No	Revision	Date

Detail No: **10B & 11B**
 Scale: 1:2 Date: 1/6/2012
 Drawing No: **S7A-03-13**

Cross Section Details

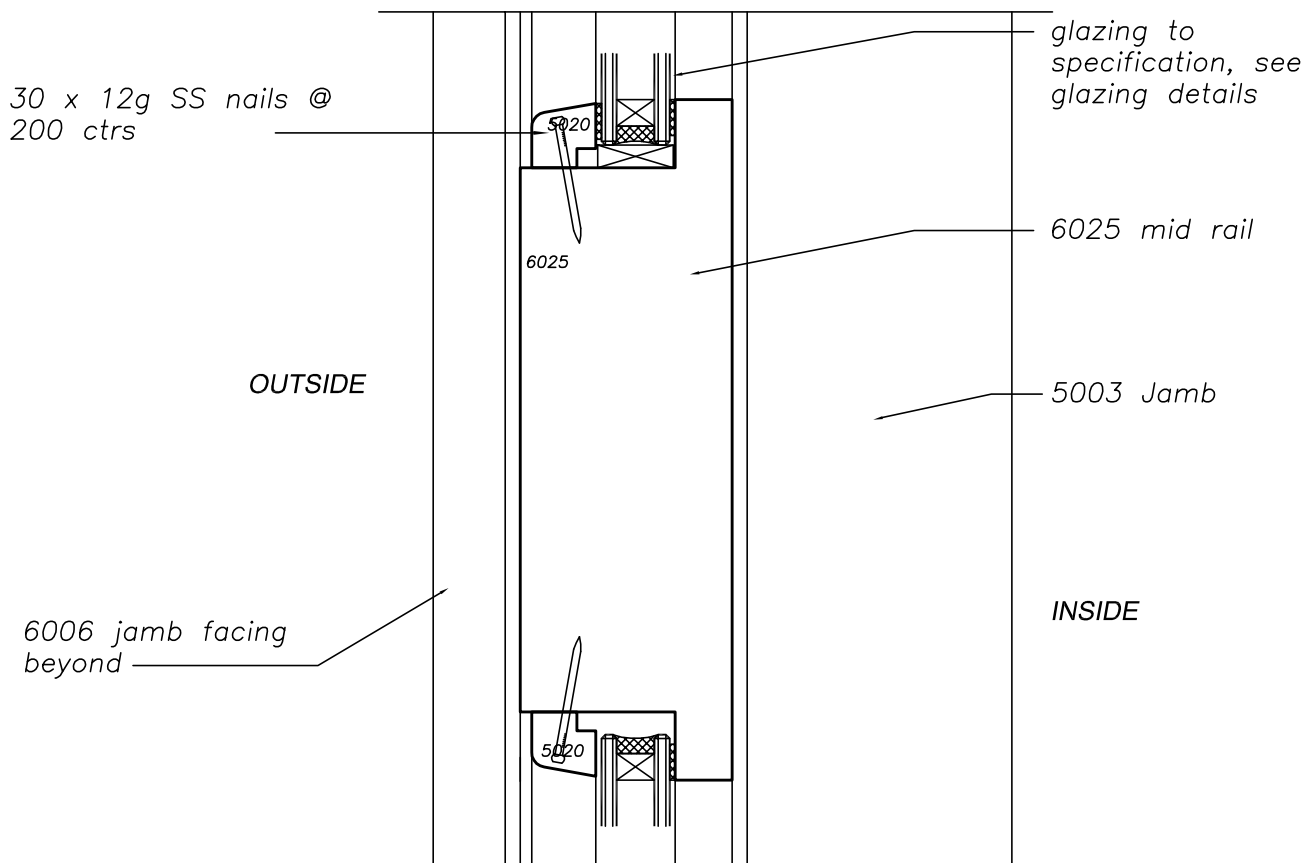

Detail (12) mid rail



No	Revision	Date	Detail No:
			12
			Scale: 1:2 Date: 1/6/2012
			Drawing No: S7A-03-14

Cross Section Details

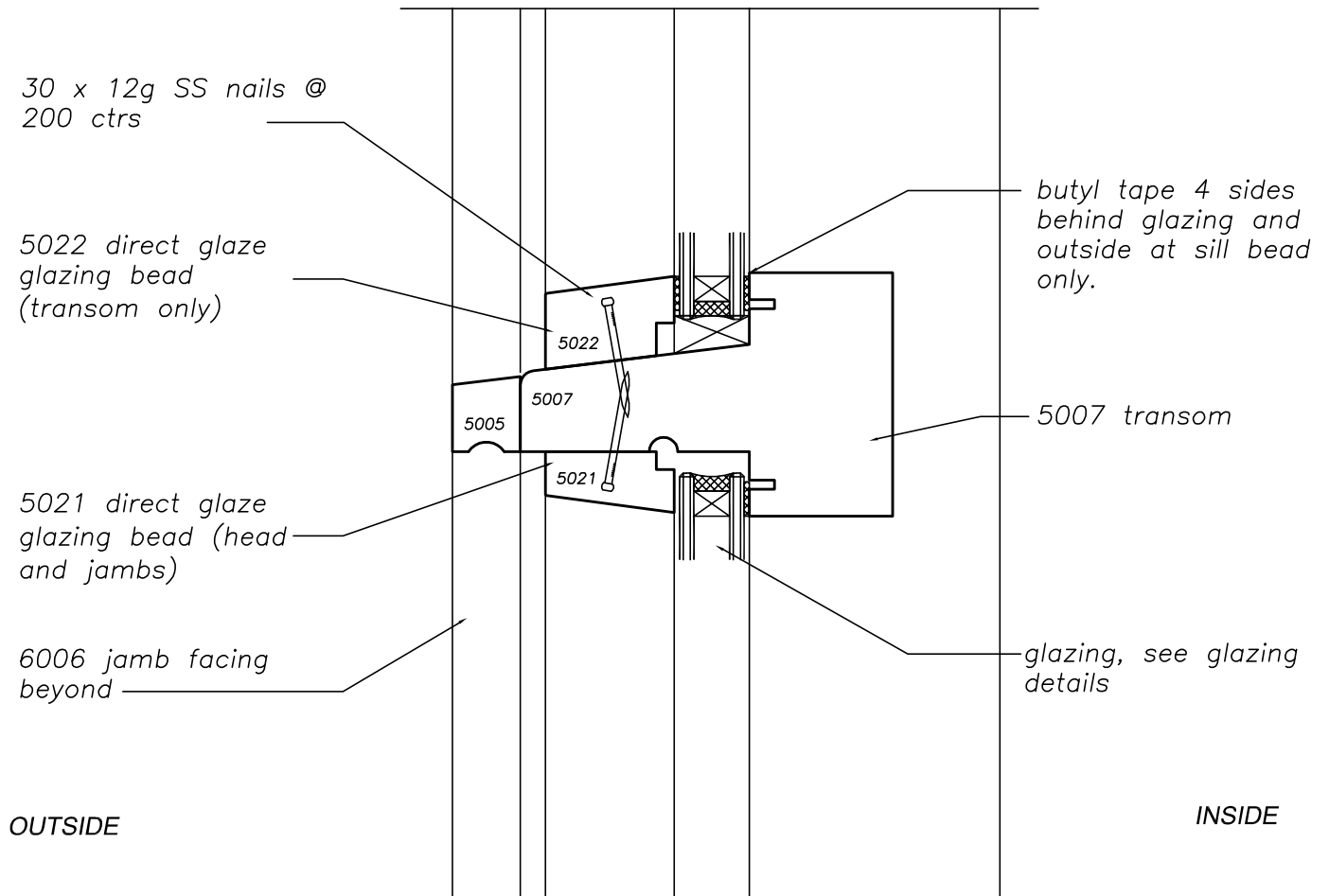

Detail 13A transom, direct glazed



No	Revision	Date

Detail No:	13A
Scale: 1:2	Date: 1/6/2012
Drawing No:	S7A-03-15

Cross Section Details

Double glazing, and
bead, see glazing
details.

5041 Fixed sash bottom
rail, DG, wet seal into
transom at kerf

sash fixing
see detail

62 x 2.8 SS. jolthead
nails @ 500 ctrs

6006 jamb facing
beyond

OUTSIDE

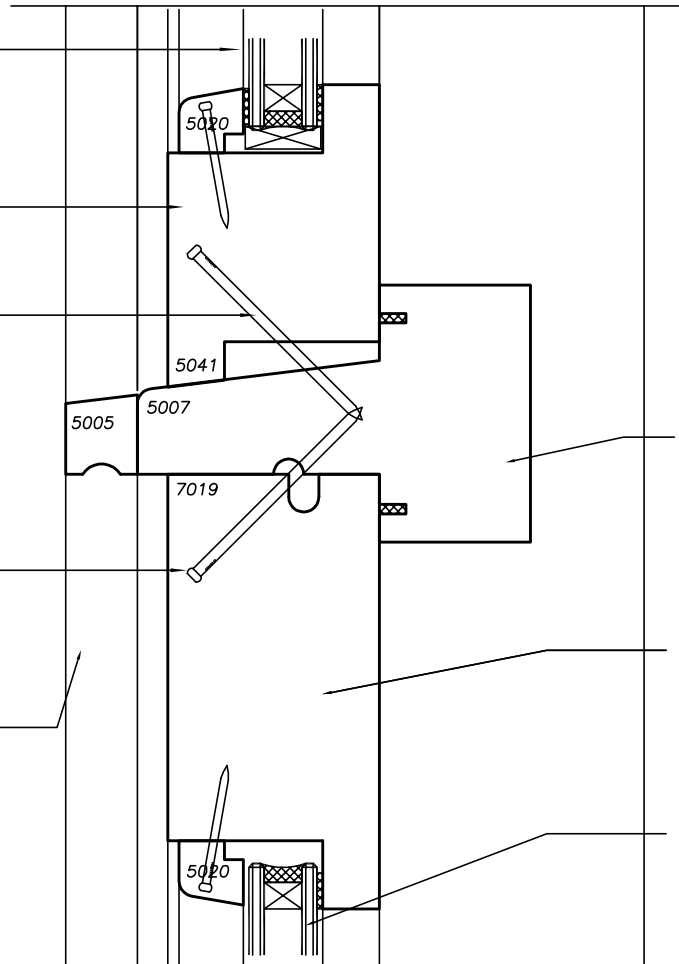

5007 transom

7019 fixed panel
top rail.

glazing

INSIDE

Detail (13B) transom, fixed, panelised below, sashed above



No	Revision	Date	Detail No:
			13B
			Scale: 1:2 Date: 1/6/2012
			Drawing No: S7A-03-16

Deductions & Clearances

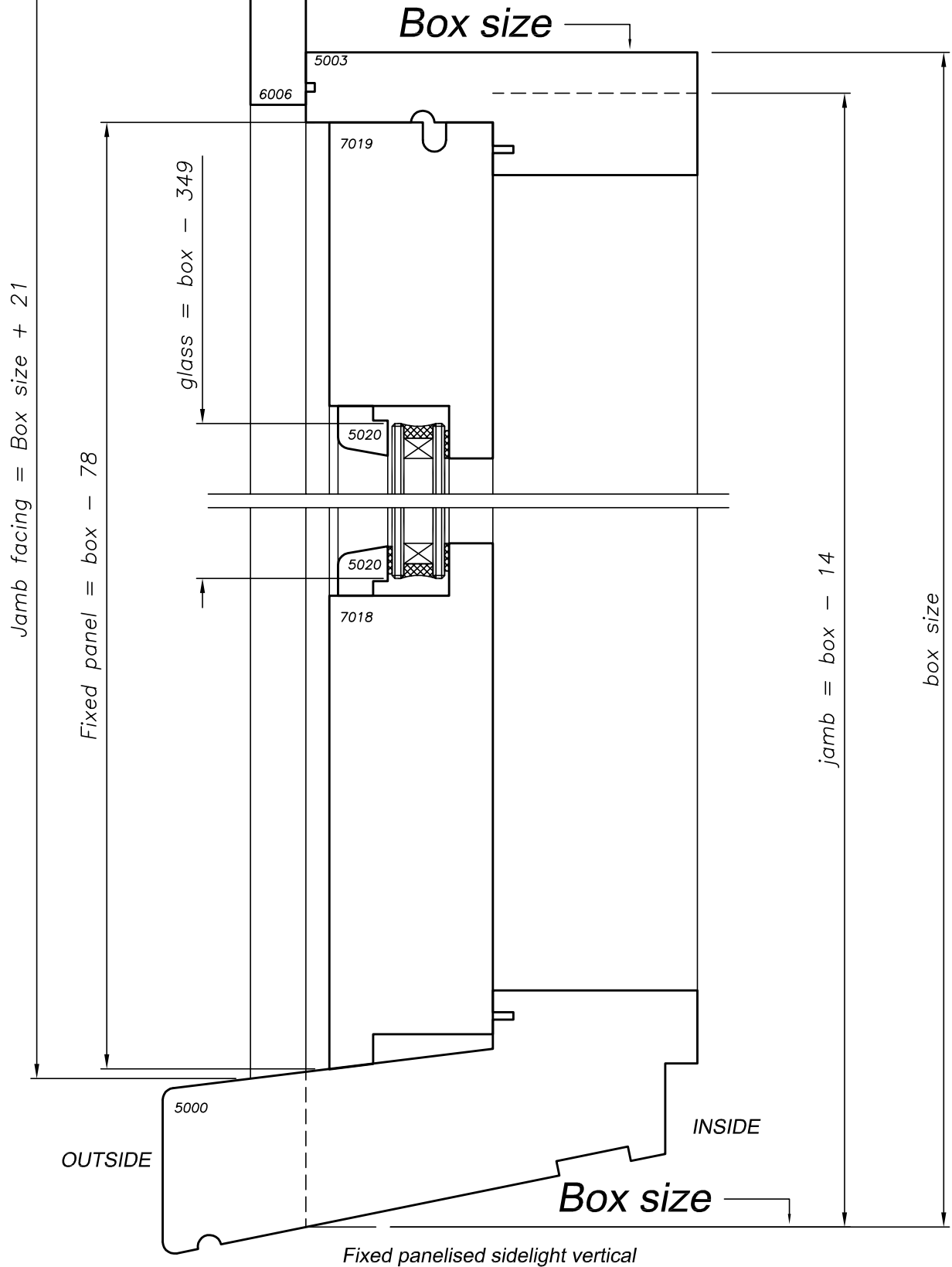

No	Revision	Date	Detail No:
			Scale: 1:2 Date: 1/6/2012
			Drawing No: S7A-04-01

Deductions & Clearances

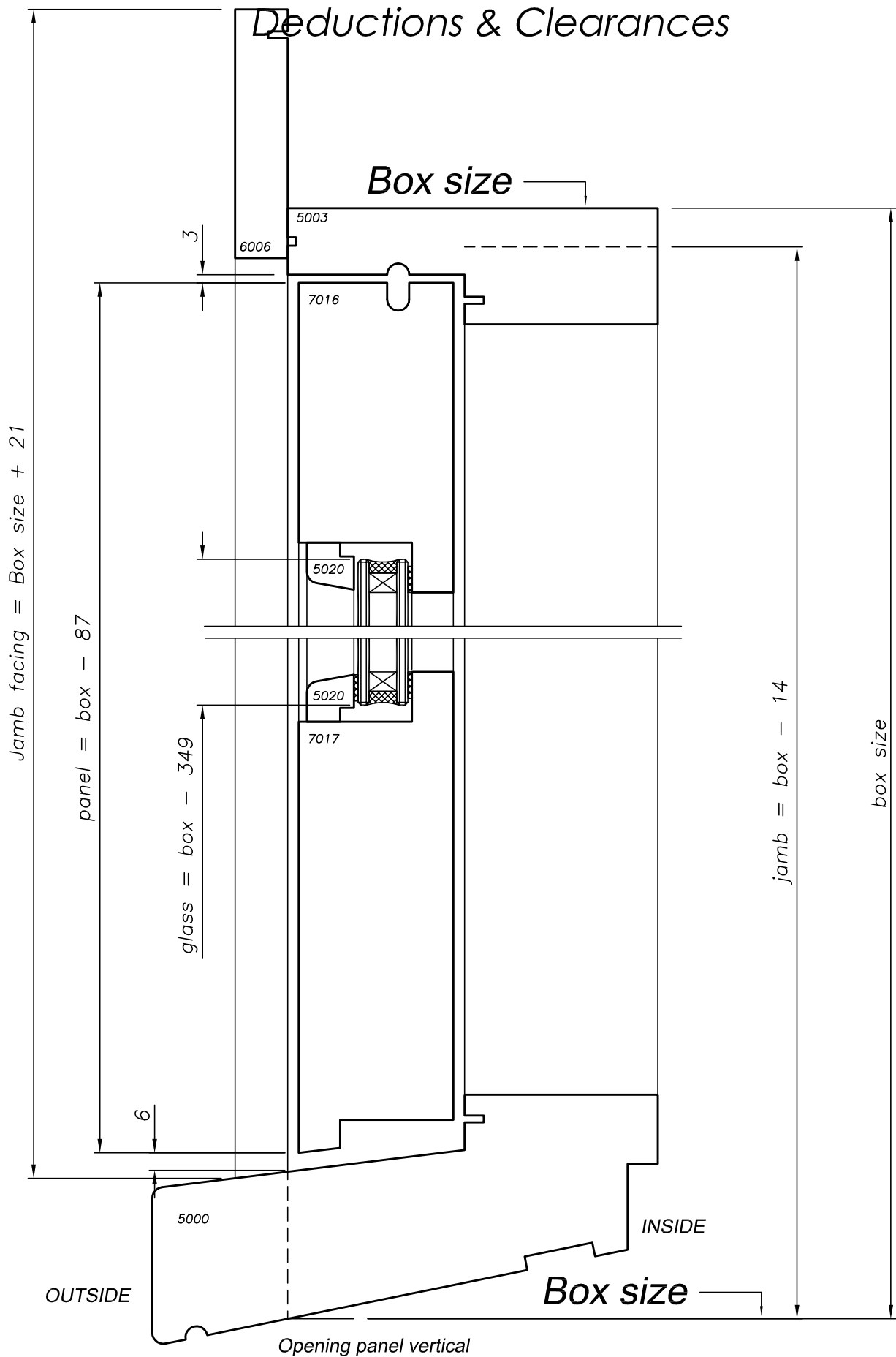

No	Revision	Date	Detail No:
			Scale: 1:2 Date: 1/6/2012
			Drawing No: S7A-04-02

Deductions & Clearances

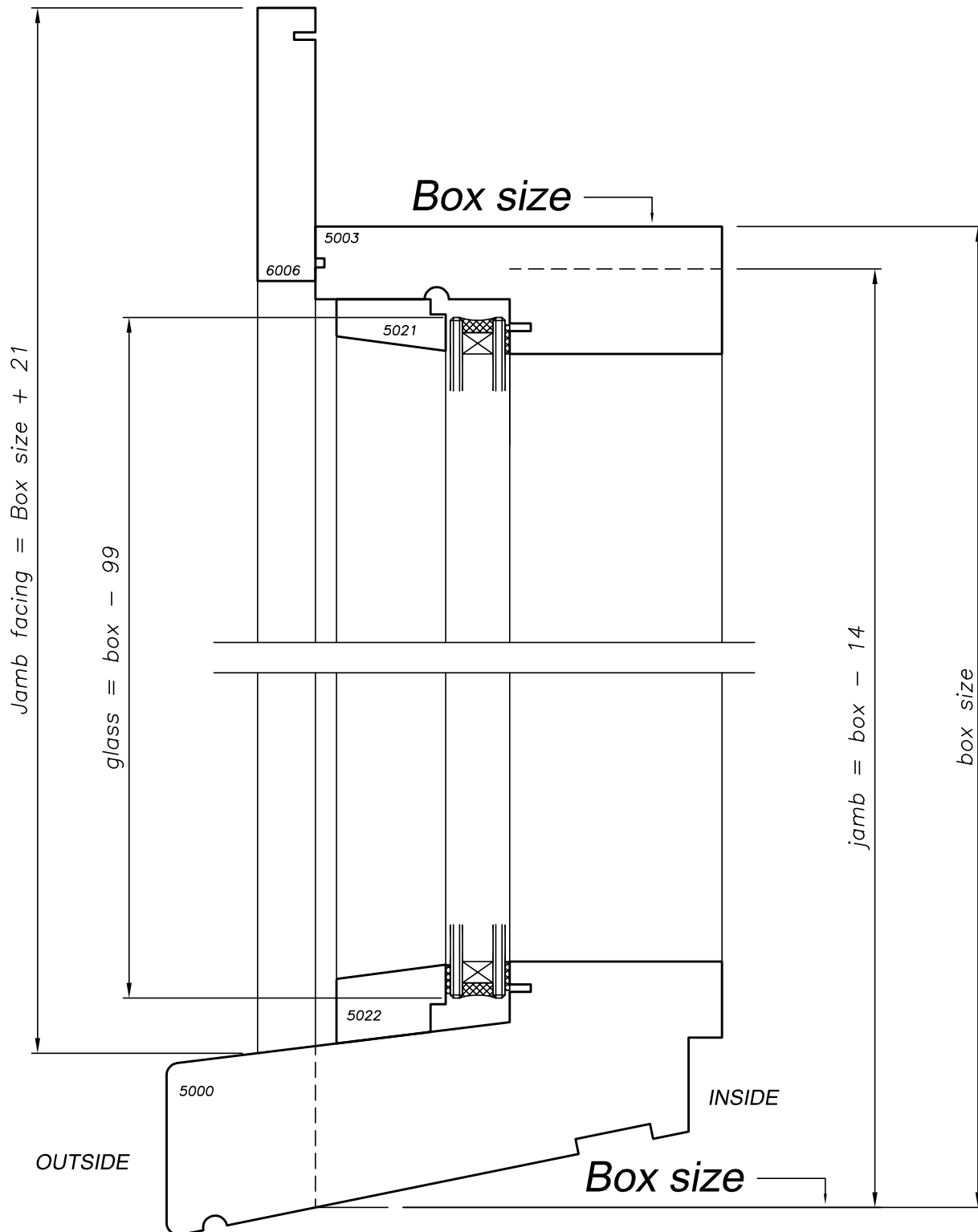

Direct glazed sidelight vertical



No	Revision	Date	Detail No:
			Scale: 1:2 Date: 1/6/2012
			Drawing No: S7A-04-03

Deductions & Clearances

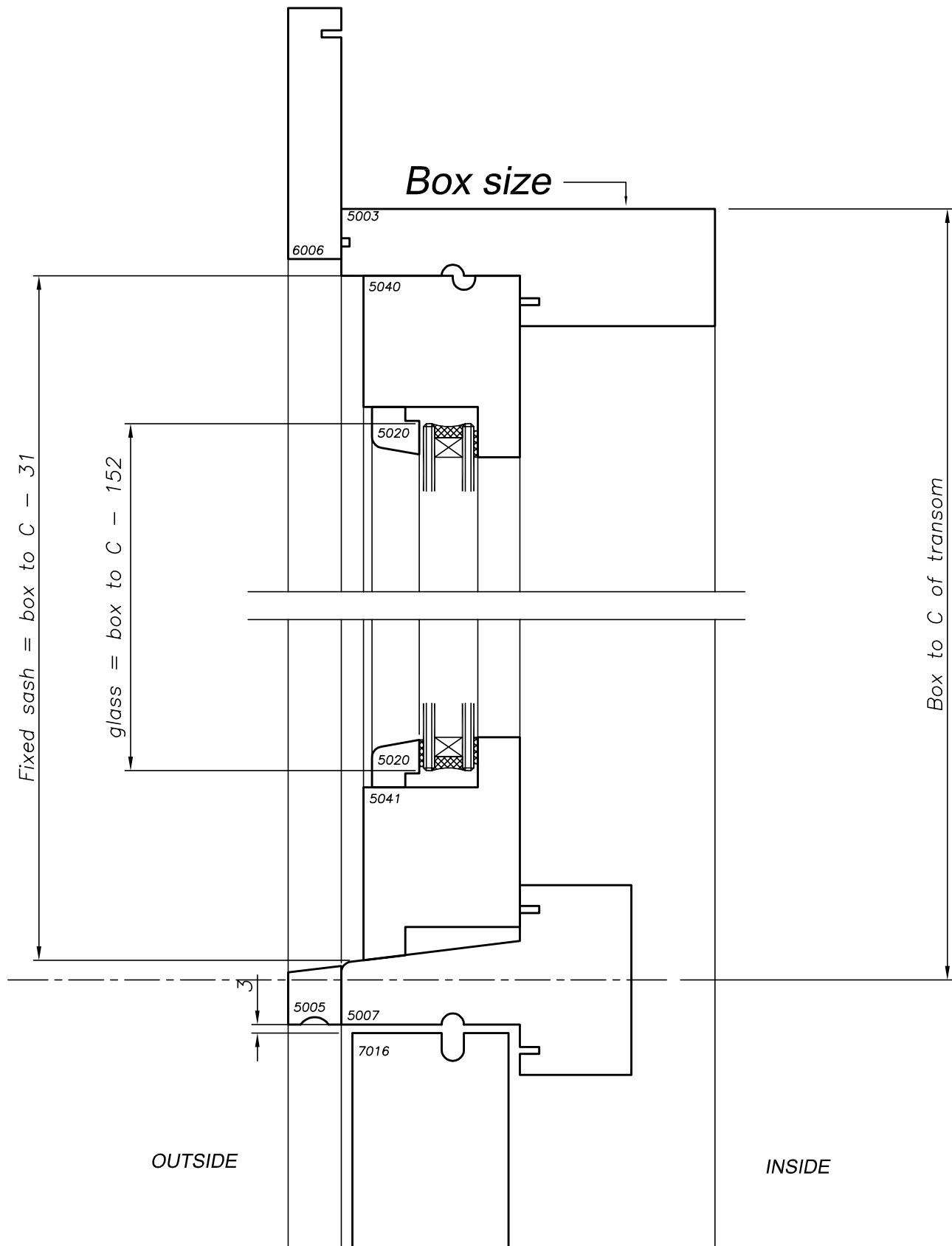

Fixed overlight above opening panel at transom



No	Revision	Date	Detail No:
			Scale: 1:2 Date: 1/6/2012
			Drawing No: S7A-04-04

Deductions & Clearances

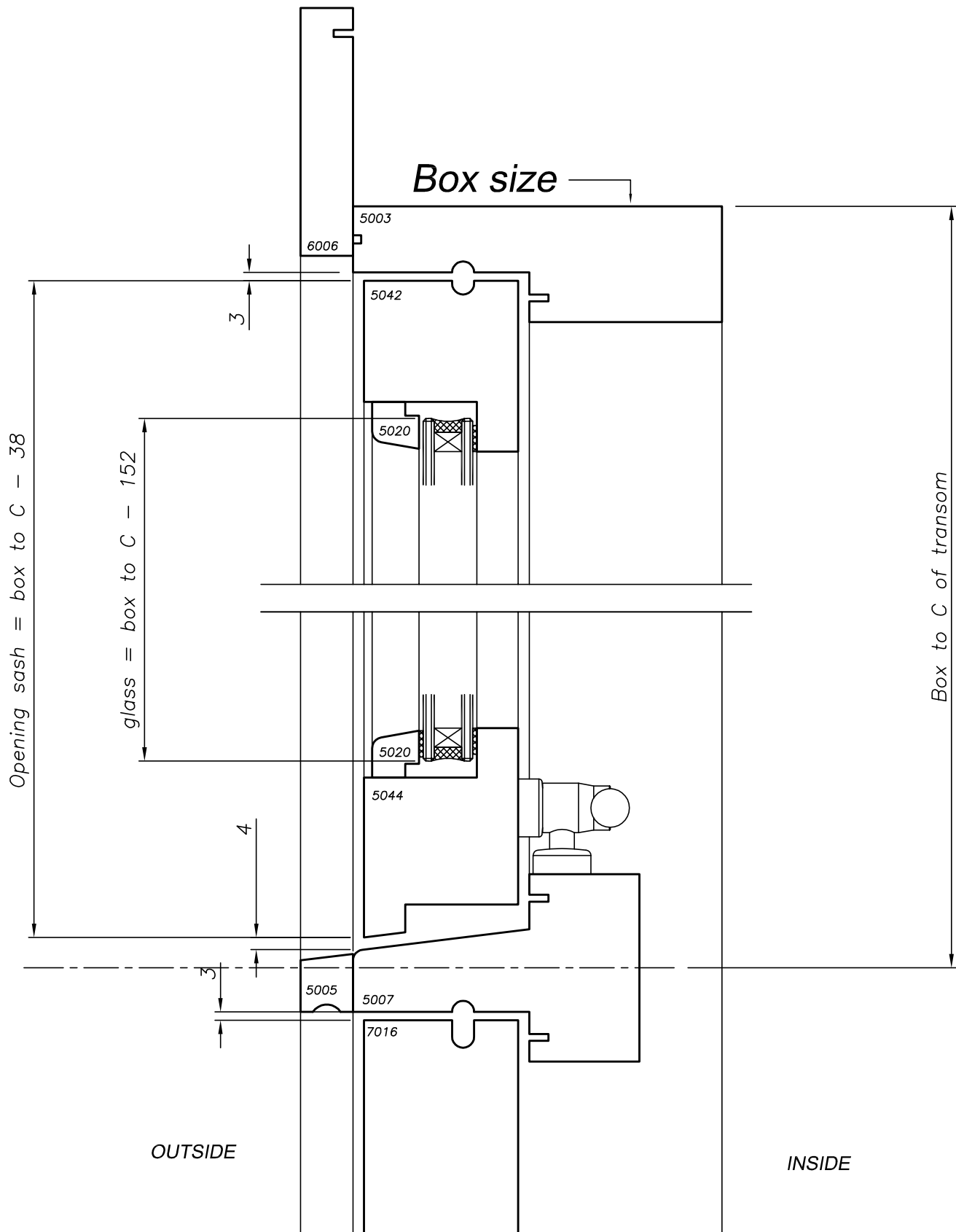

Opening Sash above transom



No	Revision	Date	Detail No:
			Scale: 1:2 Date: 1/6/2012
			Drawing No: S7A-04-05

Deductions & Clearances

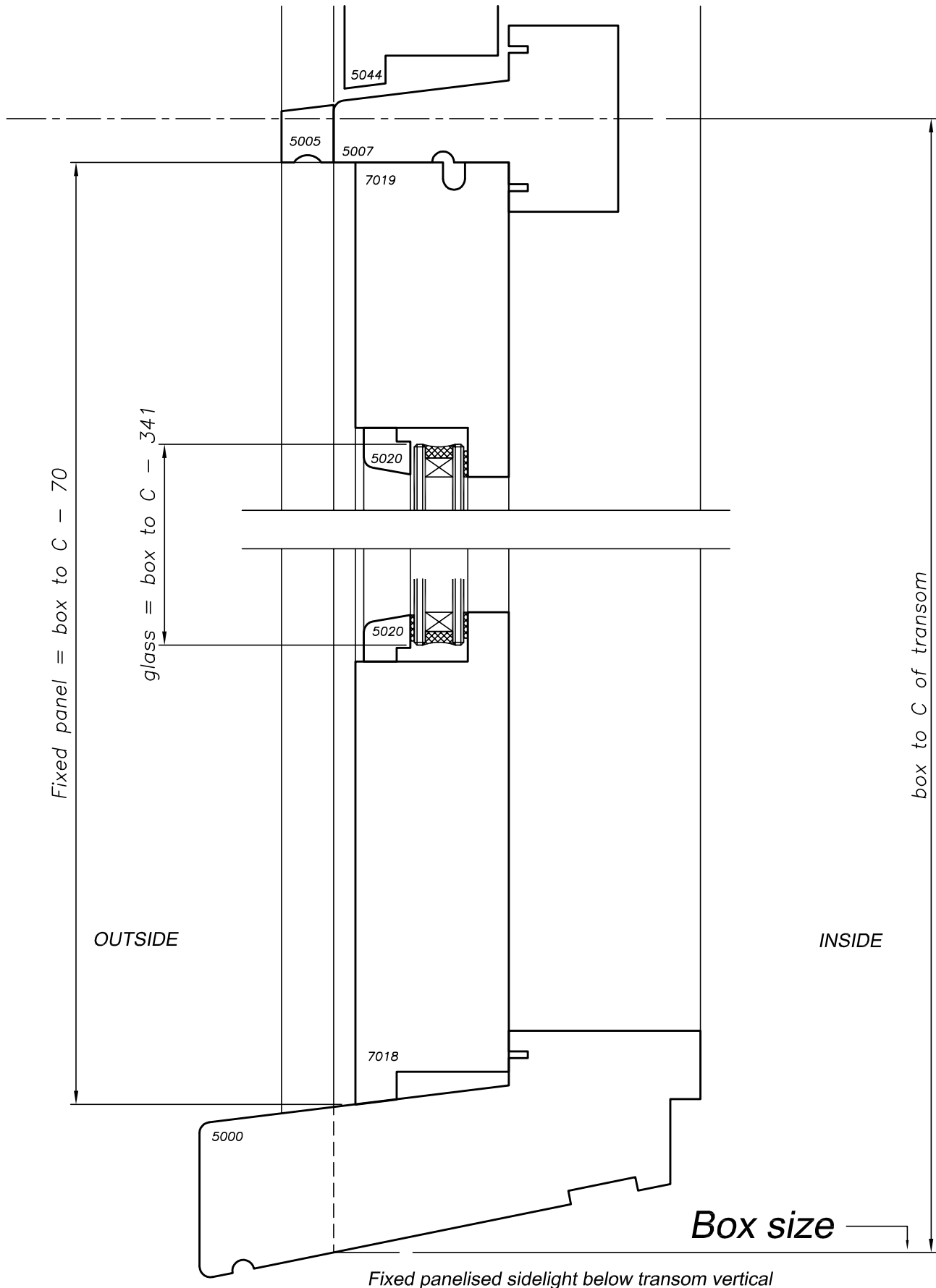

No	Revision	Date	Detail No:
			Scale: 1:2 Date: 1/6/2012
			Drawing No: S7A-04-06

Deductions & Clearances

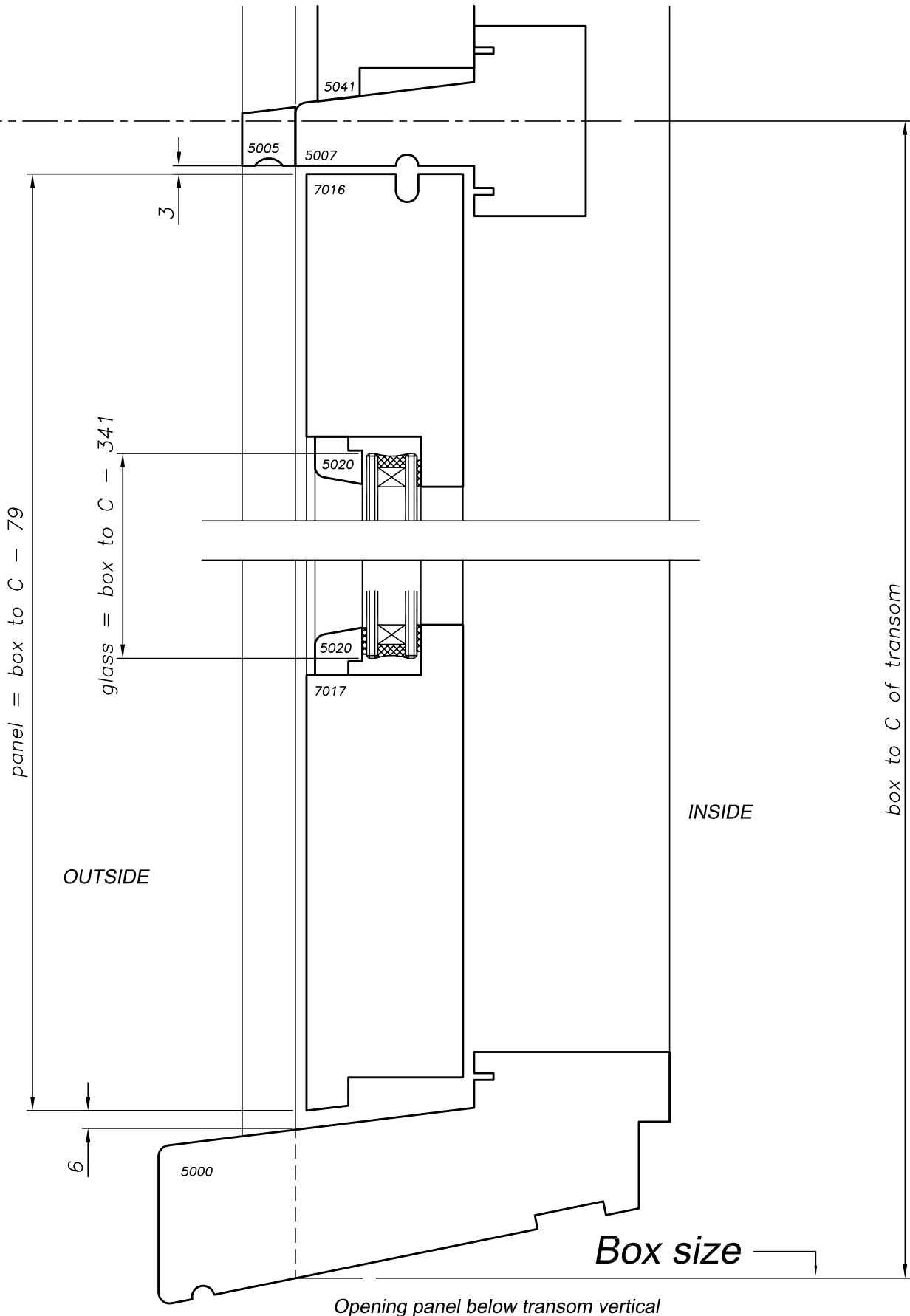

No	Revision	Date	Detail No:
			Scale: 1:2 Date: 1/6/2012
			Drawing No: S7A-04-07

Deductions & Clearances

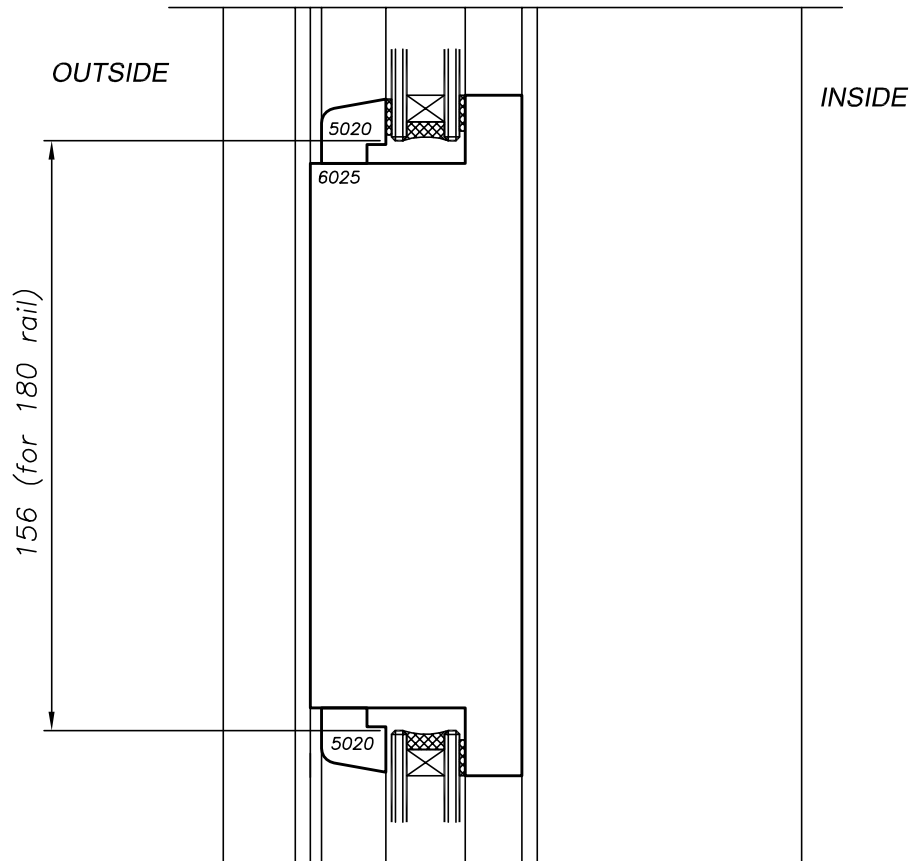

Mid rail (180mm)



No	Revision	Date	Detail No:
			Scale: 1:2 Date: 1/6/2012
			Drawing No: S7A-04-08

Deductions & Clearances

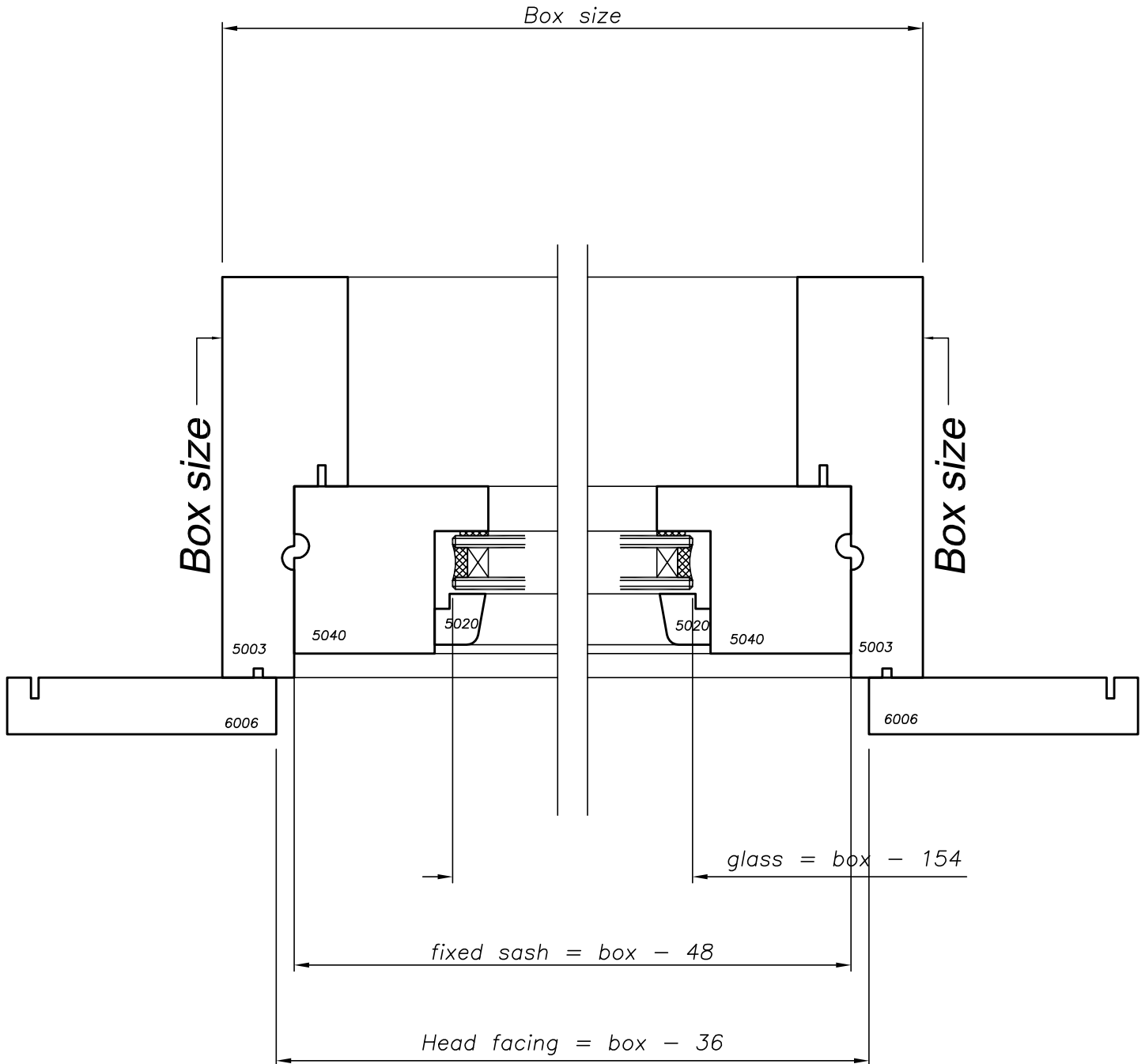

Fixed between Jambs at overlight,
sashed Horizontal



No	Revision	Date	Detail No:
			Scale: 1:2 Date: 1/6/2012
			Drawing No: S7A-04-09

Deductions & Clearances

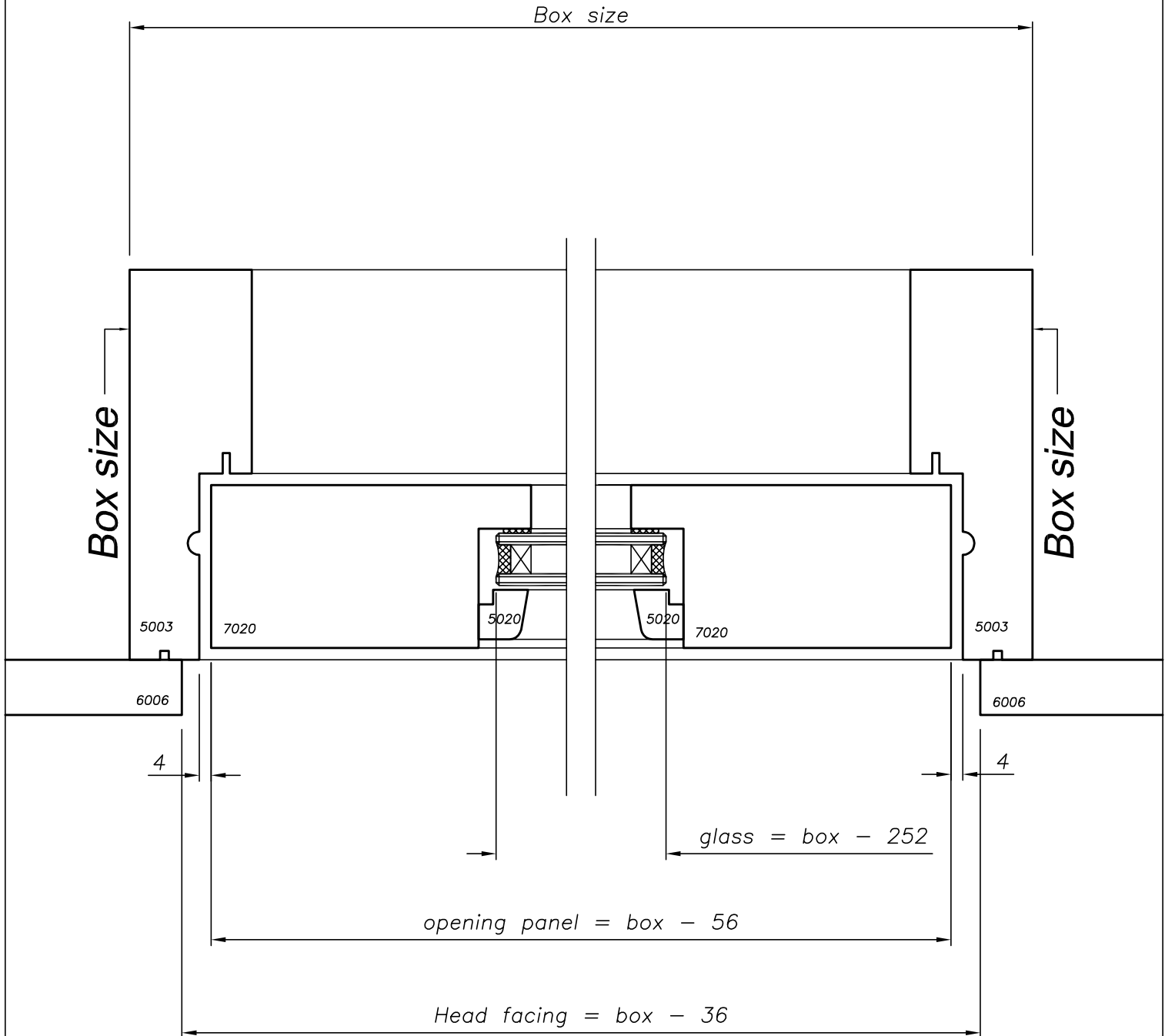

single door panel between Jambs, Horizontal



No	Revision	Date	Detail No:
			Scale: 1:2 Date: 1/6/2012
			Drawing No: S7A-04-10

Deductions & Clearances

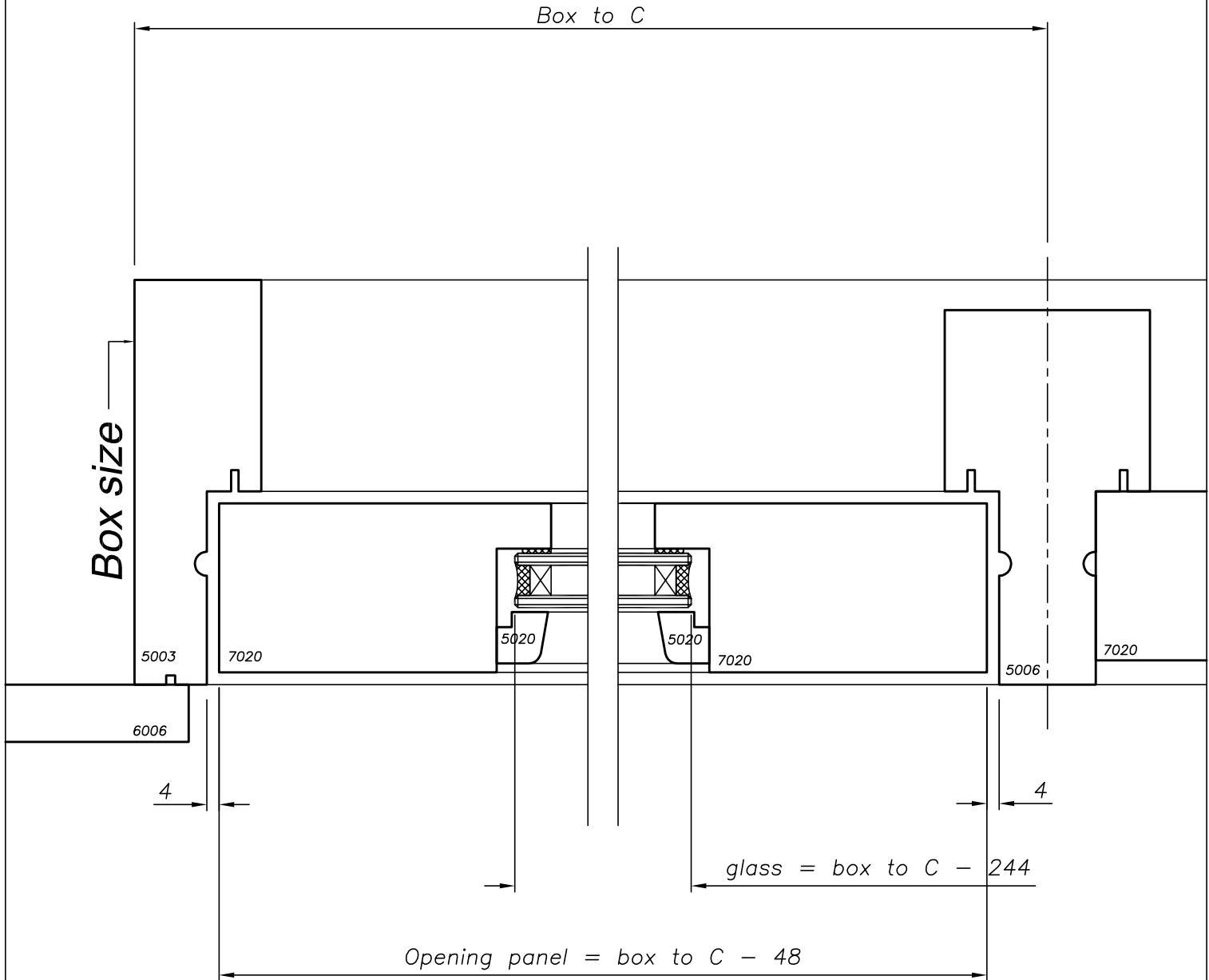

single door panel between jamb and Mullion,
Horizontal



No	Revision	Date	Detail No:
			Scale: 1:2 Date: 1/6/2012
			Drawing No: S7A-04-11

Deductions & Clearances

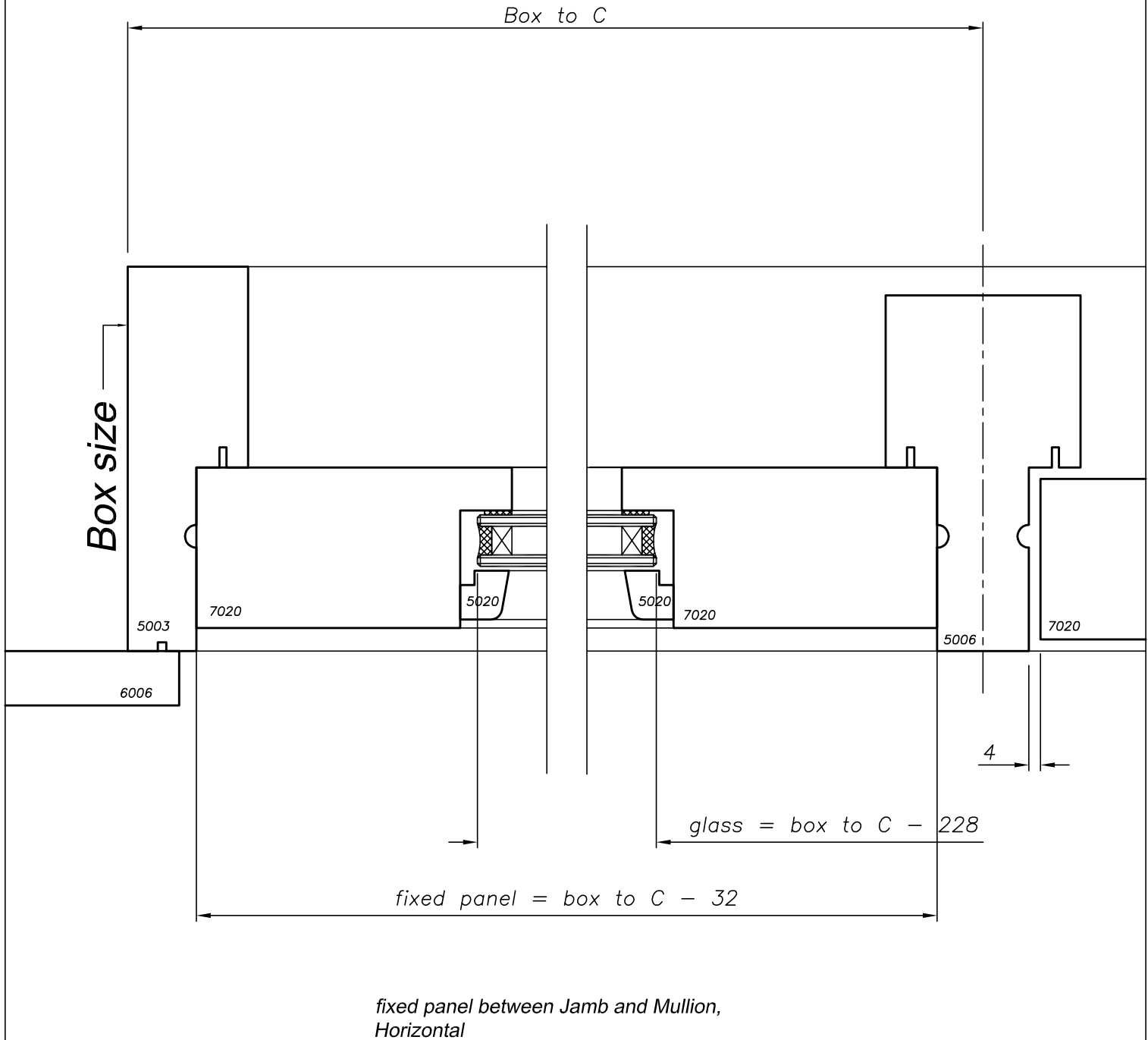

No	Revision	Date	Detail No:
			Scale: 1:2 Date: 1/6/2012
			Drawing No: S7A-04-12

Deductions & Clearances

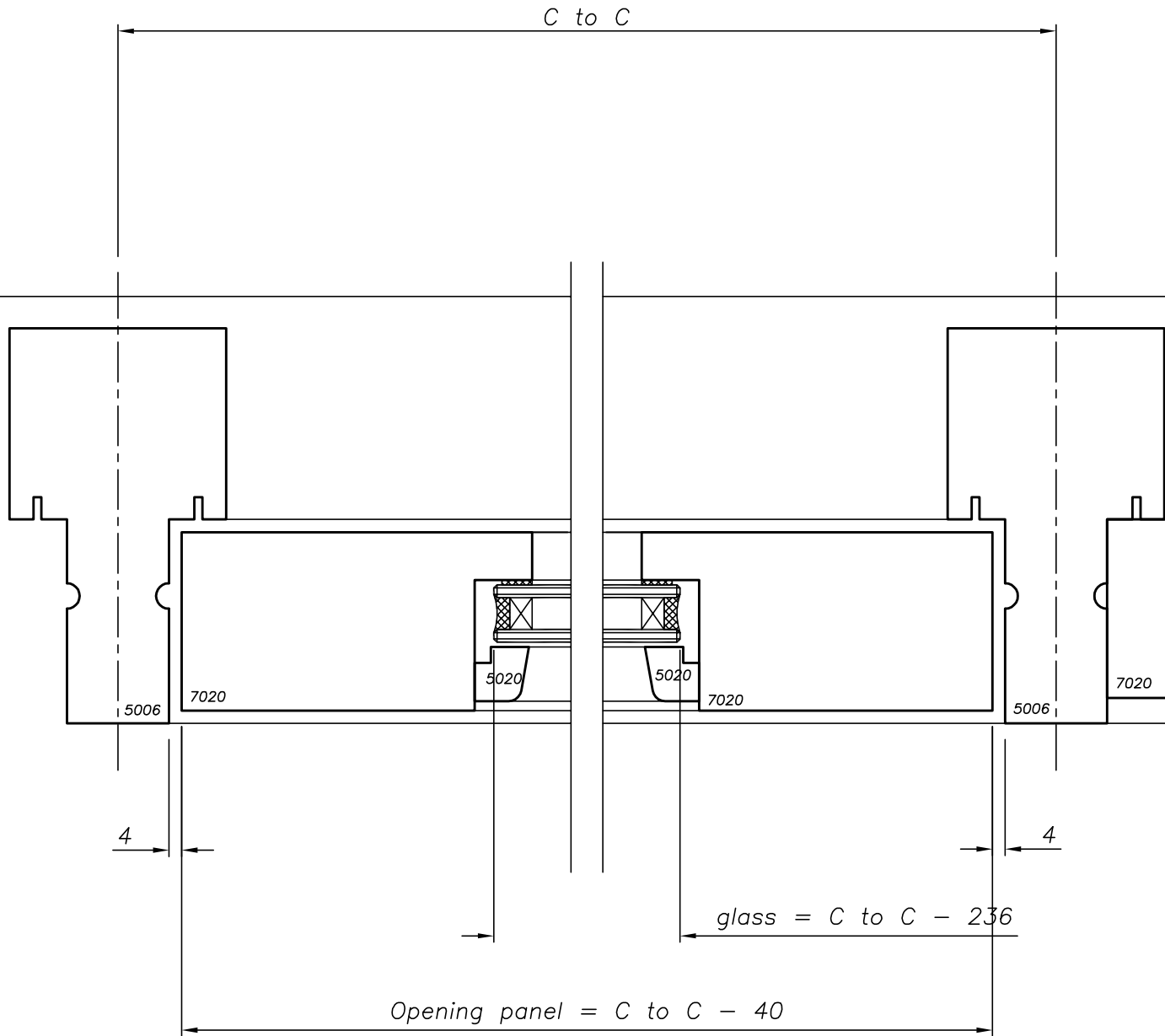

opening panel between Mullion and Mullion,
Horizontal



No	Revision	Date	Detail No:
			Scale: 1:2 Date: 1/6/2012
			Drawing No: S7A-04-13

Deductions & Clearances

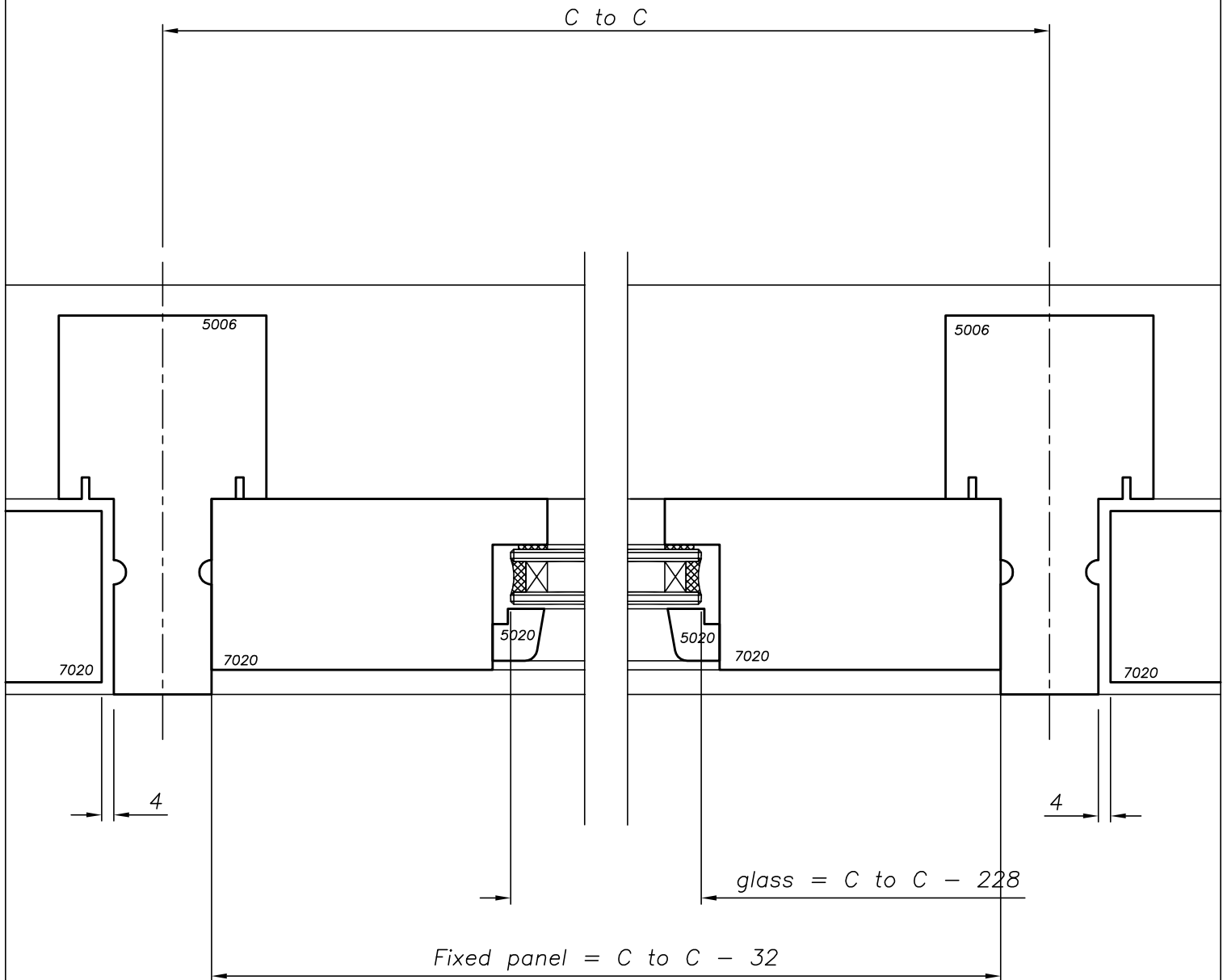

fixed panel between Mullion and Mullion,
Horizontal



No	Revision	Date	Detail No:
			Scale: 1:2 Date: 1/6/2012
			Drawing No: S7A-04-14

Deductions & Clearances

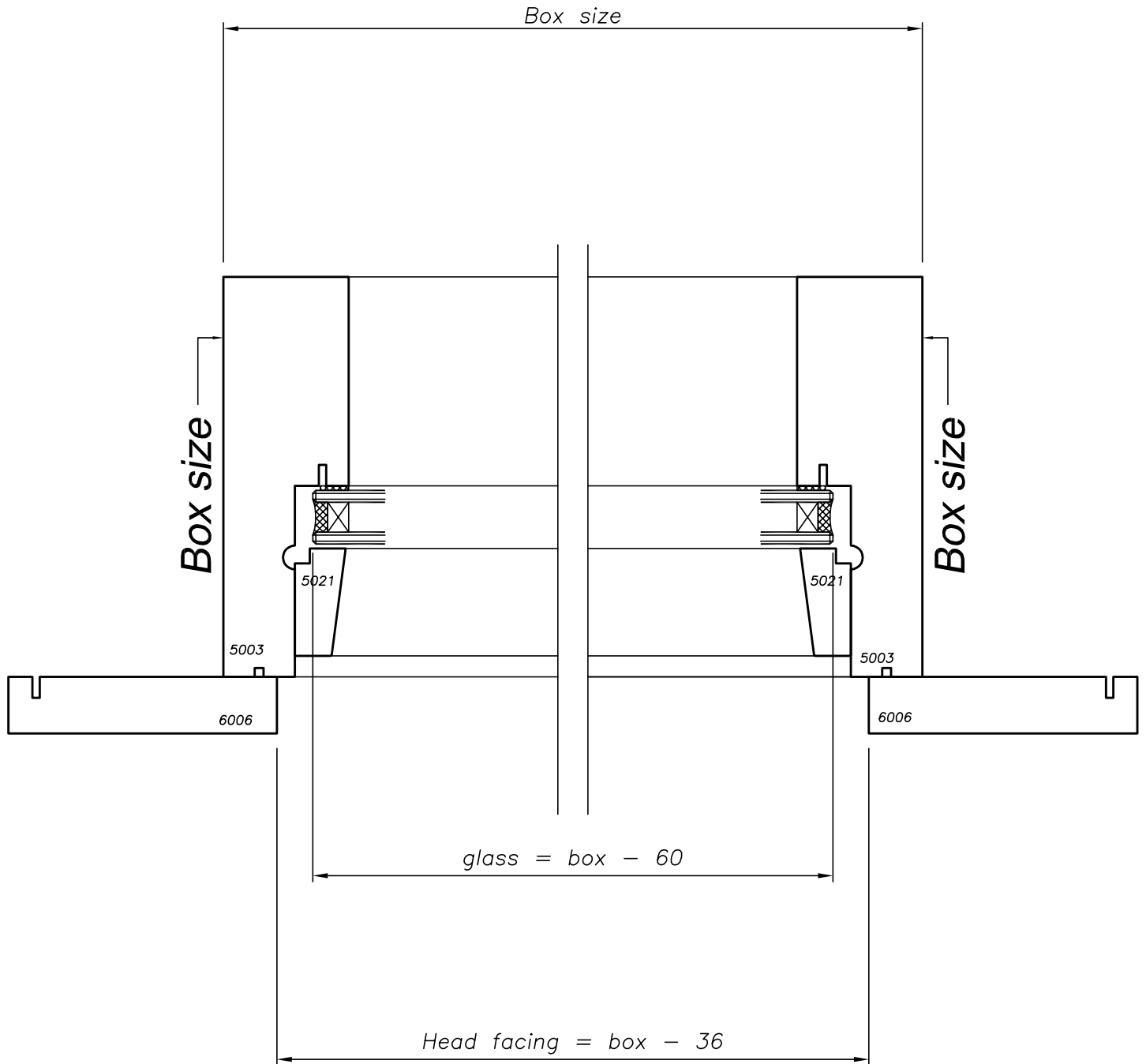

Fixed between Jambs, Direct glazed
Horizontal



No	Revision	Date	Detail No:
			Scale: 1:2 Date: 1/6/2012
			Drawing No: S7A-04-15

Deductions & Clearances

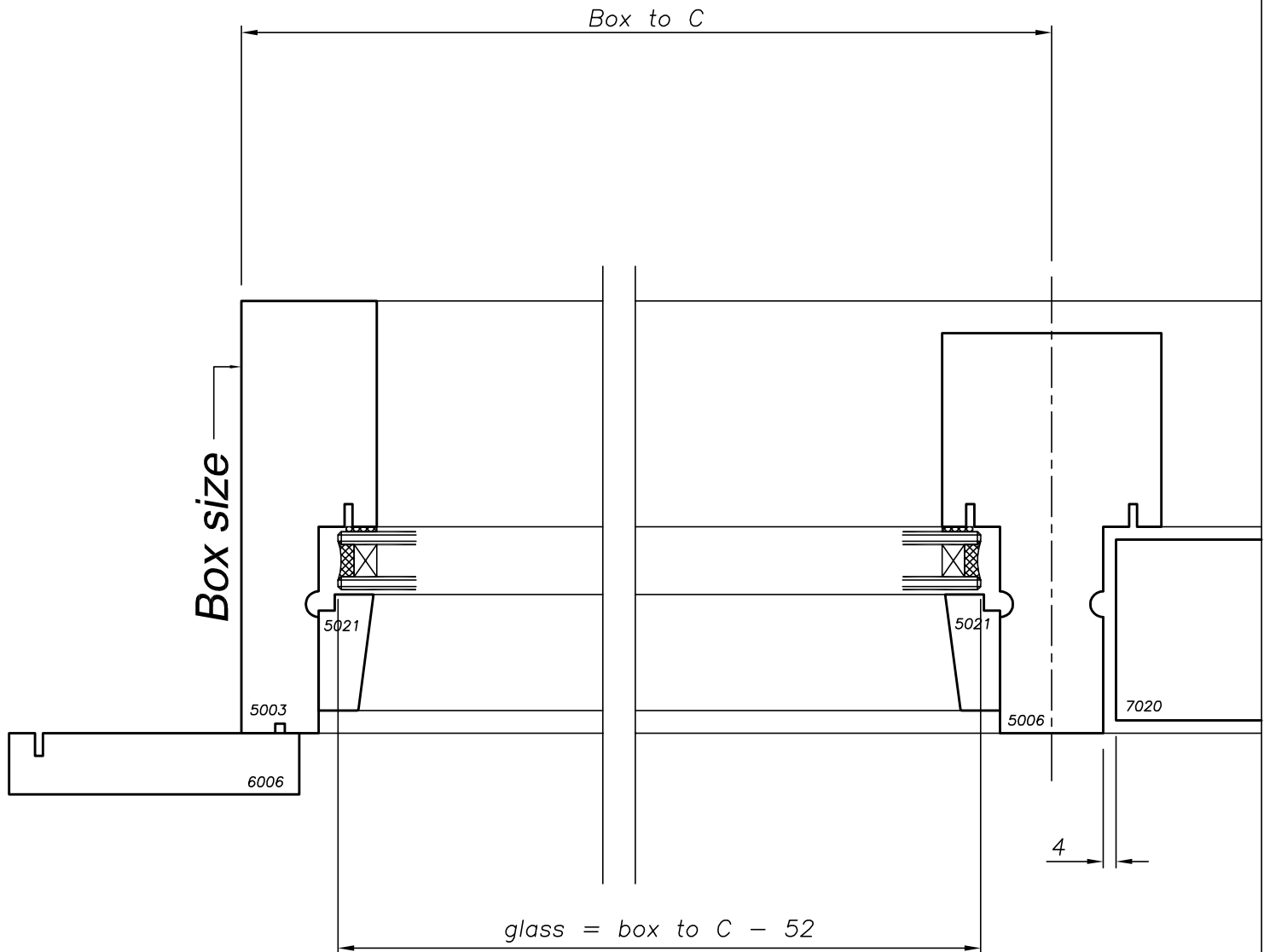

No	Revision	Date	Detail No:
			Scale: 1:2 Date: 1/6/2012
			Drawing No: S7A-04-16

Deductions & Clearances

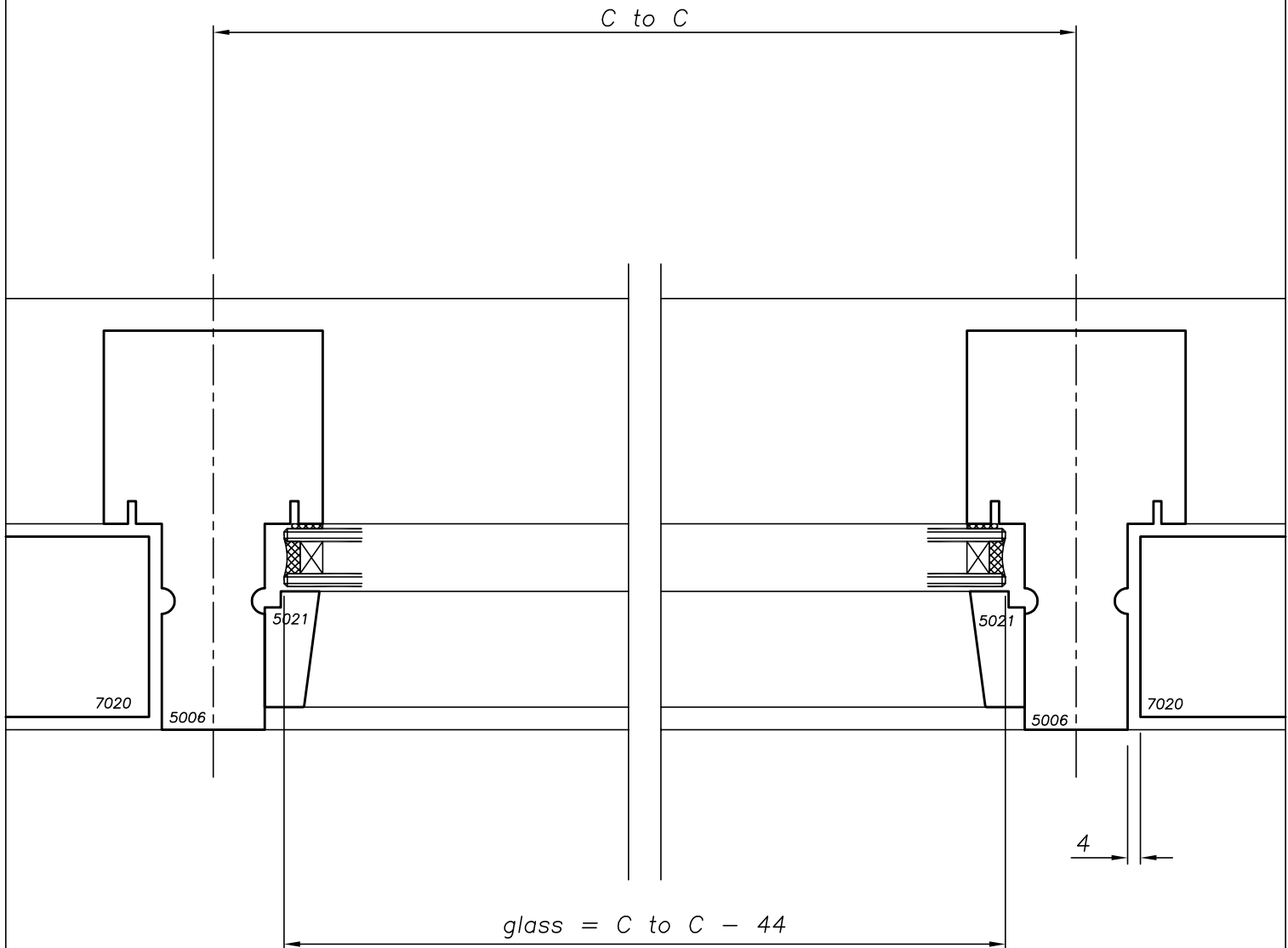

Fixed between Mullion and Mullion, Direct glazed Horizontal



No	Revision	Date	Detail No:
			Scale: 1:2 Date: 1/6/2012
			Drawing No: S7A-04-17

Deductions & Clearances

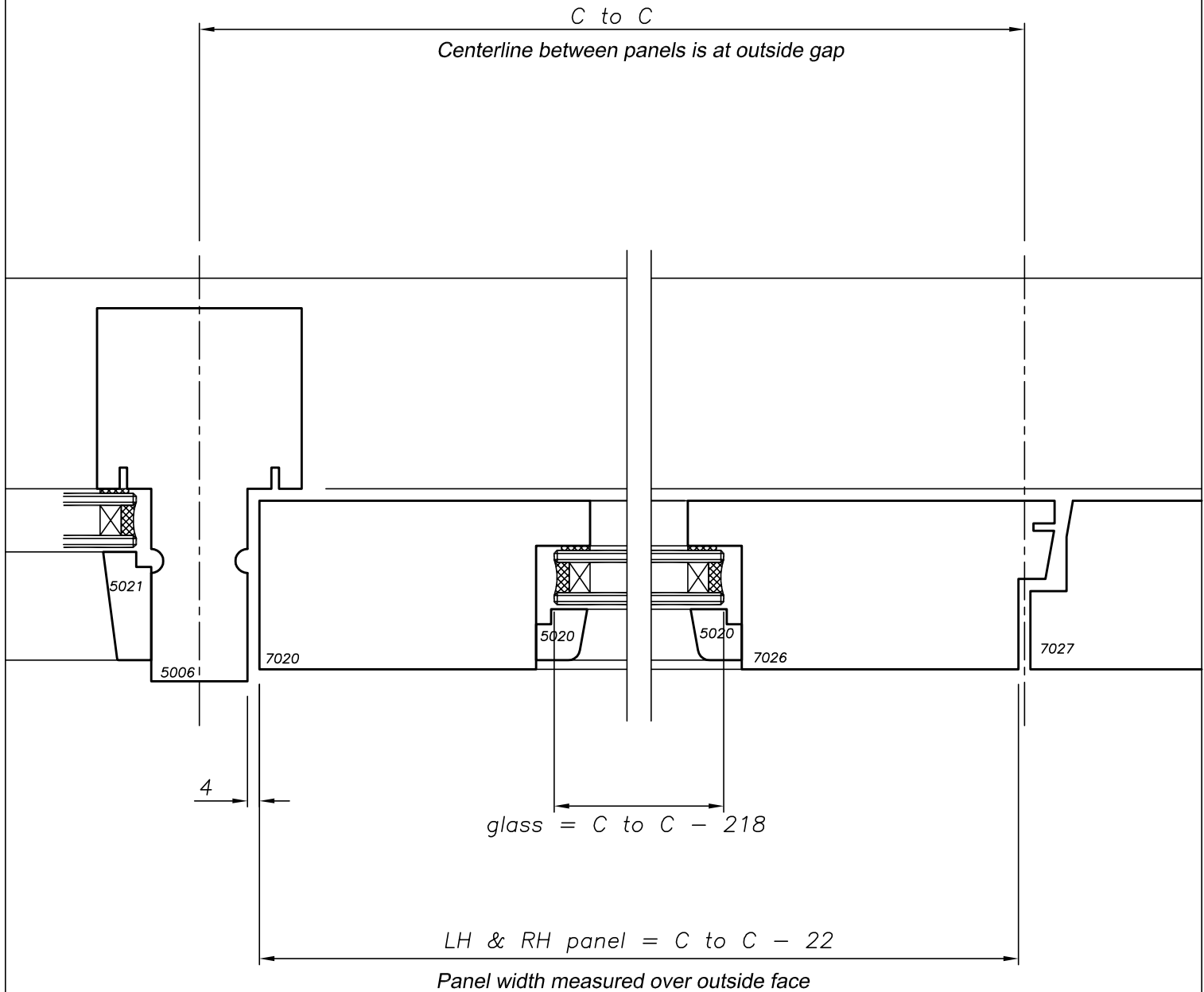

French doors between Mullion and Mullion



No	Revision	Date	Detail No:
			Scale: 1:2 Date: 1/6/2012
			Drawing No: S7A-04-18

Deductions & Clearances

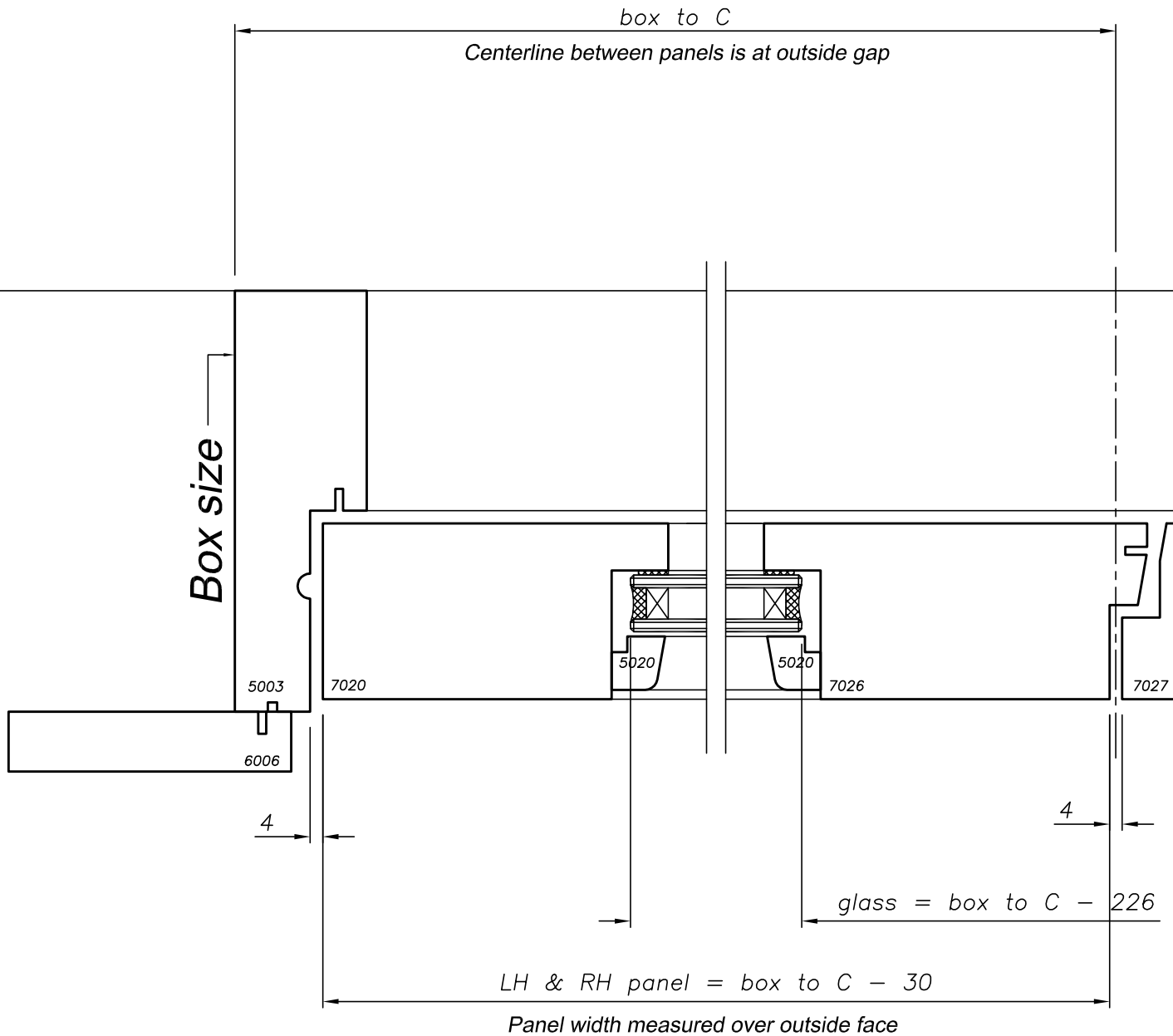

French doors between Jamb and Mullion



No	Revision	Date	Detail No:
			Scale: 1:2 Date: 1/6/2012
			Drawing No: S7A-04-19